

FLOOR PLAN, DIMENSIONS & MAP

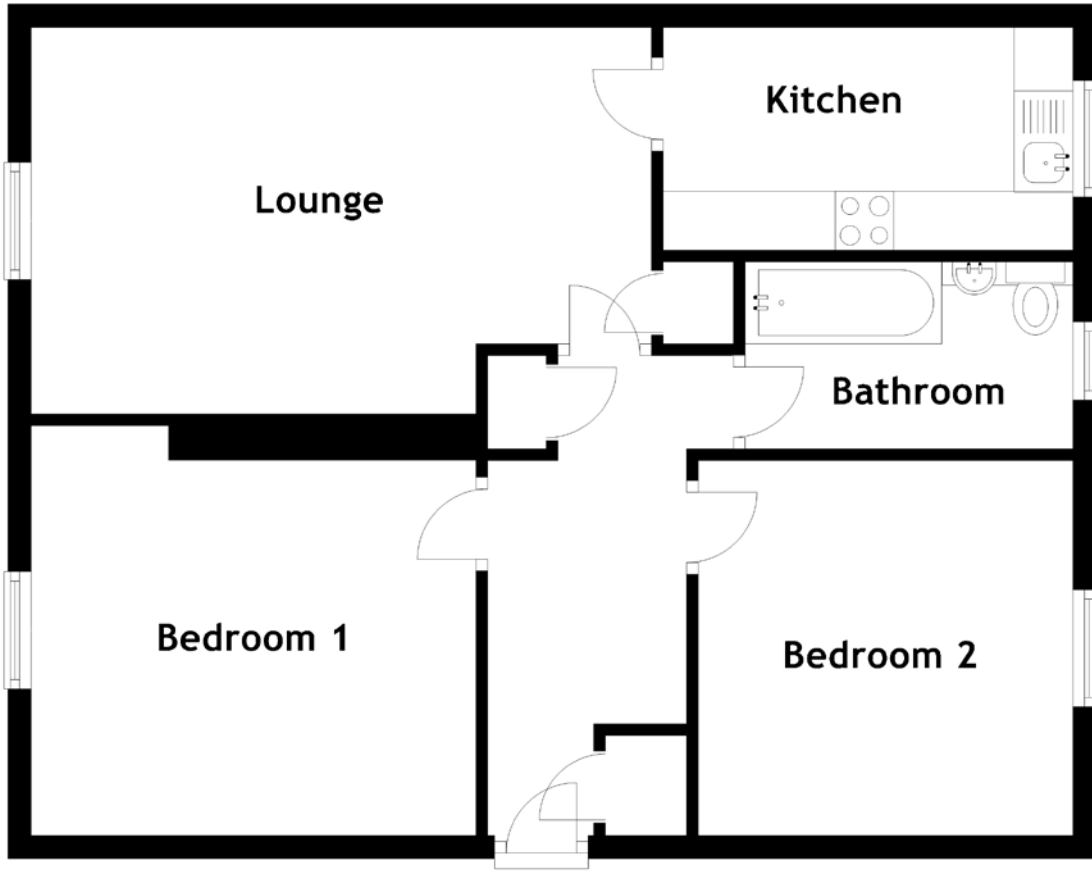

Approximate Dimensions (Taken from the widest point)

Lounge 5.30m (17'5") x 3.30m (10'10")
 Kitchen 3.50m (11'6") x 1.90m (6'3")
 Bedroom 1 3.80m (12'6") x 3.20m (10'6")

Bedroom 2 3.20m (10'6") x 3.20m (10'6")
 Bathroom 2.80m (9'2") x 1.30m (4'3")

Gross internal floor area (m²): 62m²
 EPC Rating: D

