

FLOOR PLAN, DIMENSIONS & MAP

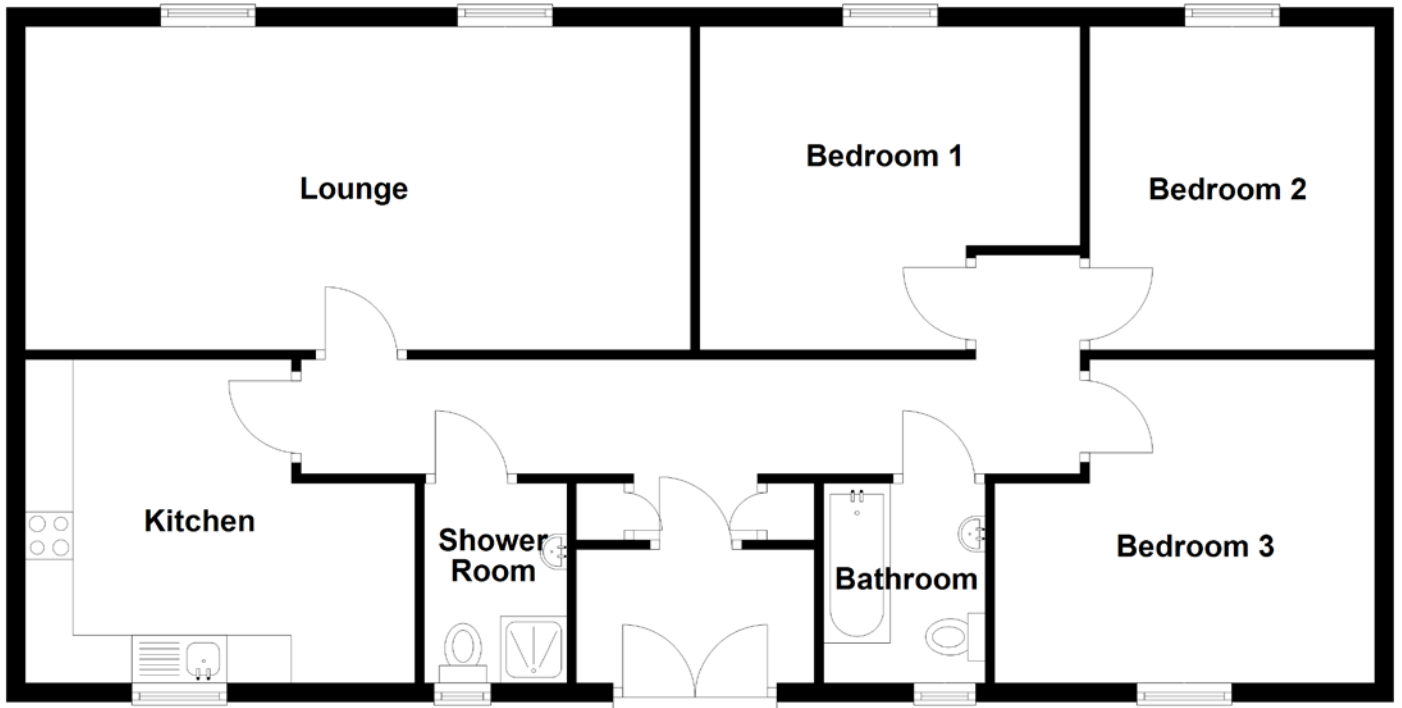

Approximate Dimensions (Taken from the widest point)

Lounge	7.00m (23') x 3.40m (11'2")
Kitchen	4.10m (13'5") x 3.40m (11'2")
Shower Room	2.10m (6'11") x 1.50m (4'11")
Bathroom	2.10m (6'11") x 1.70m (5'7")

Bedroom 1	4.00m (13'1") x 3.40m (11'2")
Bedroom 2	3.40m (11'2") x 3.00m (9'10")
Bedroom 3	4.00m (13'1") x 3.40m (11'2")

Gross internal floor area (m²): 101m²
EPC Rating: D

