

26 Carlaverock Terrace

TRANENT, EAST LOTHIAN, EH33 2PL

Ground Floor

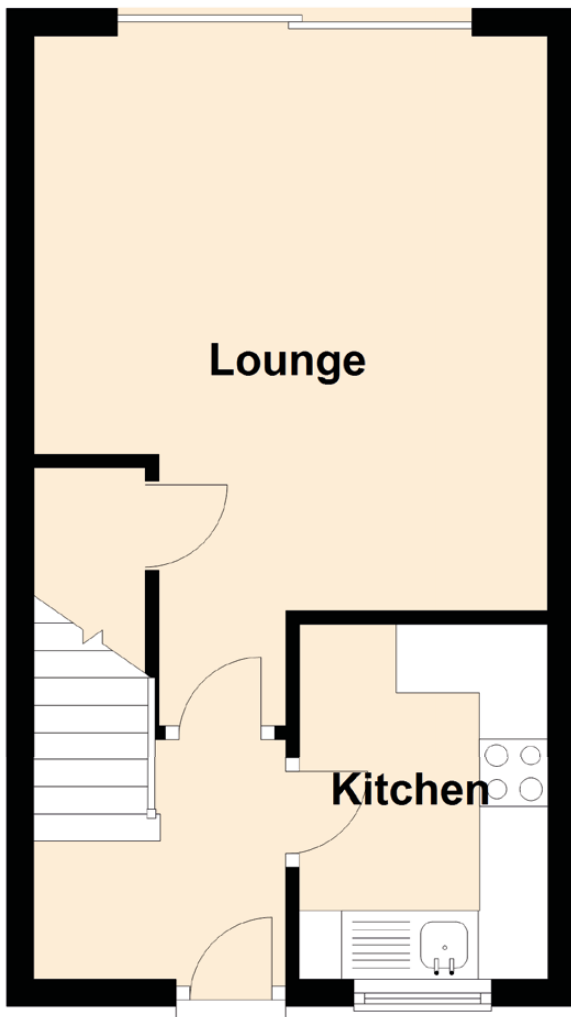

First Floor

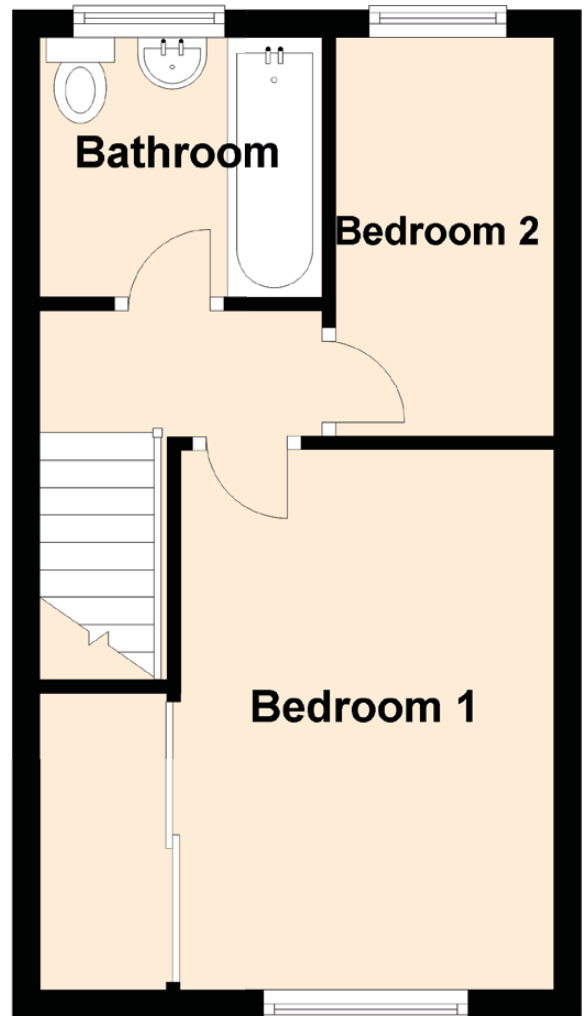

Approximate Dimensions (Taken from the widest point)

Lounge	4.20m (13'9") x 3.76m (12'4")
Kitchen	2.60m (8'6") x 1.82m (6')
Bedroom 1	3.95m (13') x 2.73m (8'11")
Bedroom 2	2.92m (9'7") x 1.56m (5'1")
Bathroom	2.07m (6'9") x 1.90m (6'3")

Gross internal floor area (m²): 53m²