

14/53 Maxwell Street

MORNINGSIDE, EDINBURGH, EH10 5HU

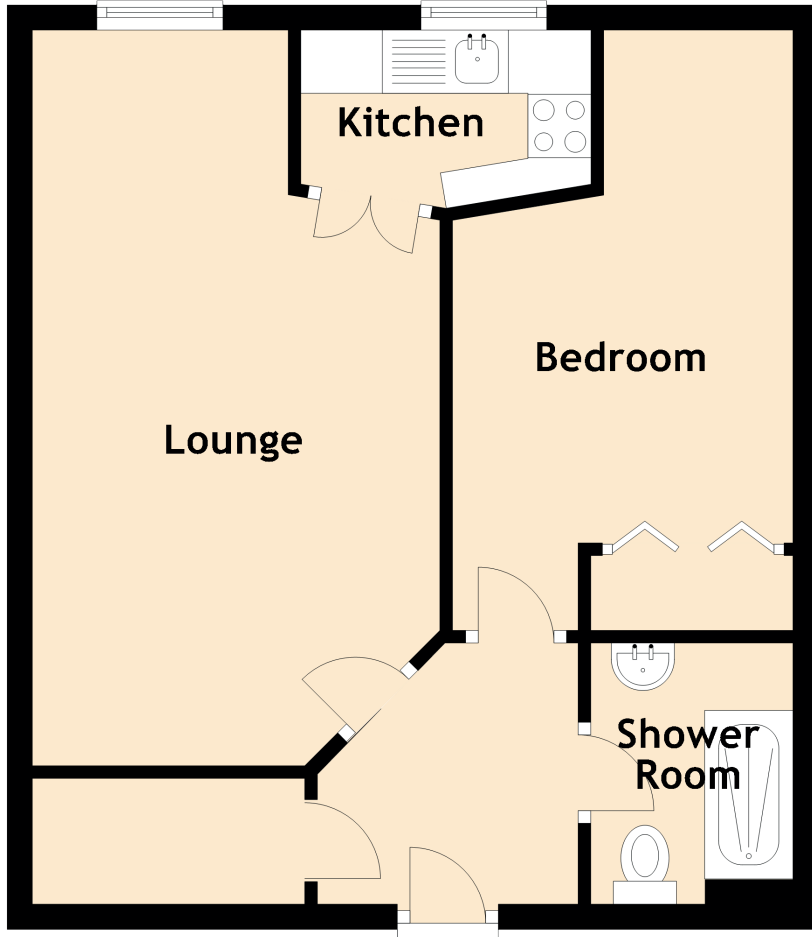

Approximate Dimensions (Taken from the widest point)

Lounge	7.10m (23'4") x 3.23m (10'7")
Kitchen	2.30m (7'7") x 1.50m (4'11")
Bedroom	4.06m (13'4") x 2.78m (9'1")
Shower Room	2.07m (6'9") x 1.60m (5'3")