

Dungarvia

INVERSHIN, LAIRG, IV27 4ET

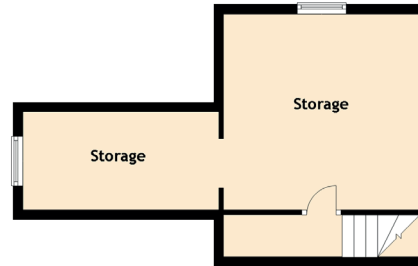

Approximate Dimensions (Taken from the widest point)

Vestibule	2.80m (9'2") x 1.90m (6'3")
Lounge	6.10m (20') x 3.00m (9'10")
Sun Room	5.20m (17'1") x 3.20m (10'6")
Kitchen/Diner	9.00m (29'6") x 3.70m (12'2")
Bedroom 1	3.50m (11'6") x 2.80m (9'2")
Bedroom 2	3.50m (11'6") x 3.00m (9'10")
Bedroom 3	3.30m (10'10") x 3.00m (9'10")
Bedroom 4	3.50m (11'6") x 1.80m (5'11")
Shower Room	3.80m (12'6") x 1.80m (5'11")
Storage	4.00m (13'1") x 4.00m (13'1")
Storage	4.00m (13'1") x 2.00m (6'7")