

# 10 Calderwood Gardens

BALLIESTON, GLASGOW, G69 7EA

Ground Floor

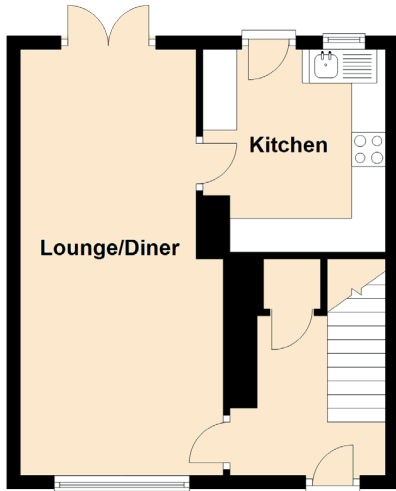

First Floor

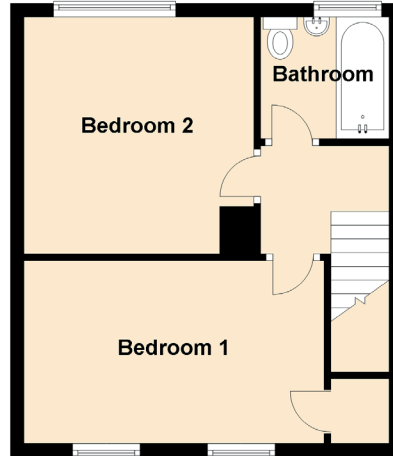

Approximate Dimensions (Taken from the widest point)

Kitchen	3.00m (9'10") x 2.70m (8'10")
Lounge/Diner	6.30m (20'8") x 3.00m (9'10")
Bathroom	1.90m (6'3") x 1.80m (5'11")
Bedroom 2	3.50m (11'6") x 3.40m (11'2")
Bedroom 1	4.40m (14'5") x 3.00m (9'10")
Attic Space	5.30m (17'5") x 3.00m (9'10")

Attic

