

# FLOOR PLAN, DIMENSIONS & MAP

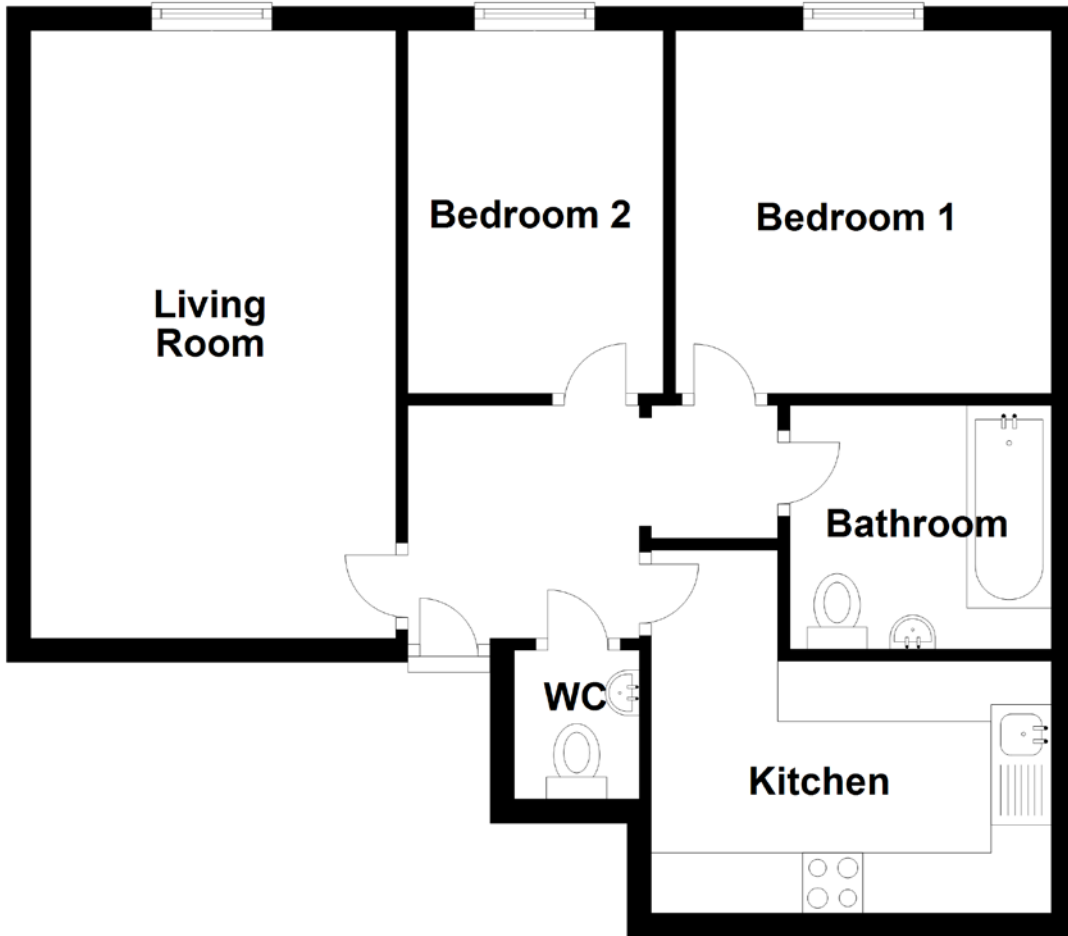

Approximate Dimensions  
(Taken from the widest point)

Living Room 5.04m (16'6") x 3.03m (9'11")  
Kitchen 3.32m (10'11") x 3.01m (9'11")  
WC 1.23m (4'1") x 1.04m (3'5")

Bedroom 1 3.12m (10'3") x 3.01m (9'11")  
Bedroom 2 3.01m (9'11") x 2.12m (6'11")  
Bathroom 2.17m (7'1") x 2.02m (6'8")

Gross internal floor area (m<sup>2</sup>): 67m<sup>2</sup>  
EPC Rating: E

