

34 Fortingall Place

KELVINDALE, GLASGOW, G12 0LT

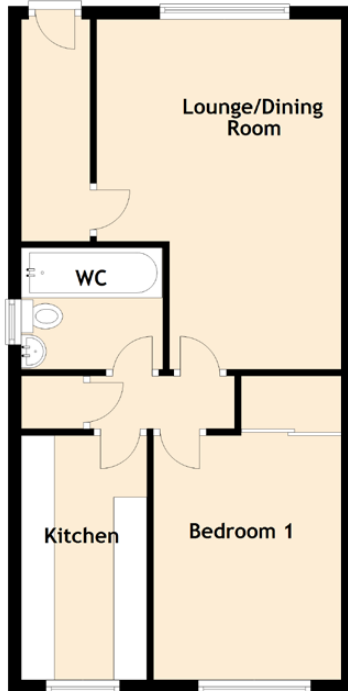

Approximate Dimensions (Taken from the widest point)

Lounge/Dining Room	5.30m (17'5") x 3.70m (12'2")
Kitchen	3.70m (12'2") x 1.90m (6'3")
Bedroom 1	3.70m (12'2") x 3.20m (10'6")
WC	1.90m (6'3") x 1.90m (6'3")

Gross internal floor area (m²) - 47m²

EPC Rating - D