

2/1, 64 Thornwood Avenue

GLASGOW, G11 7PE

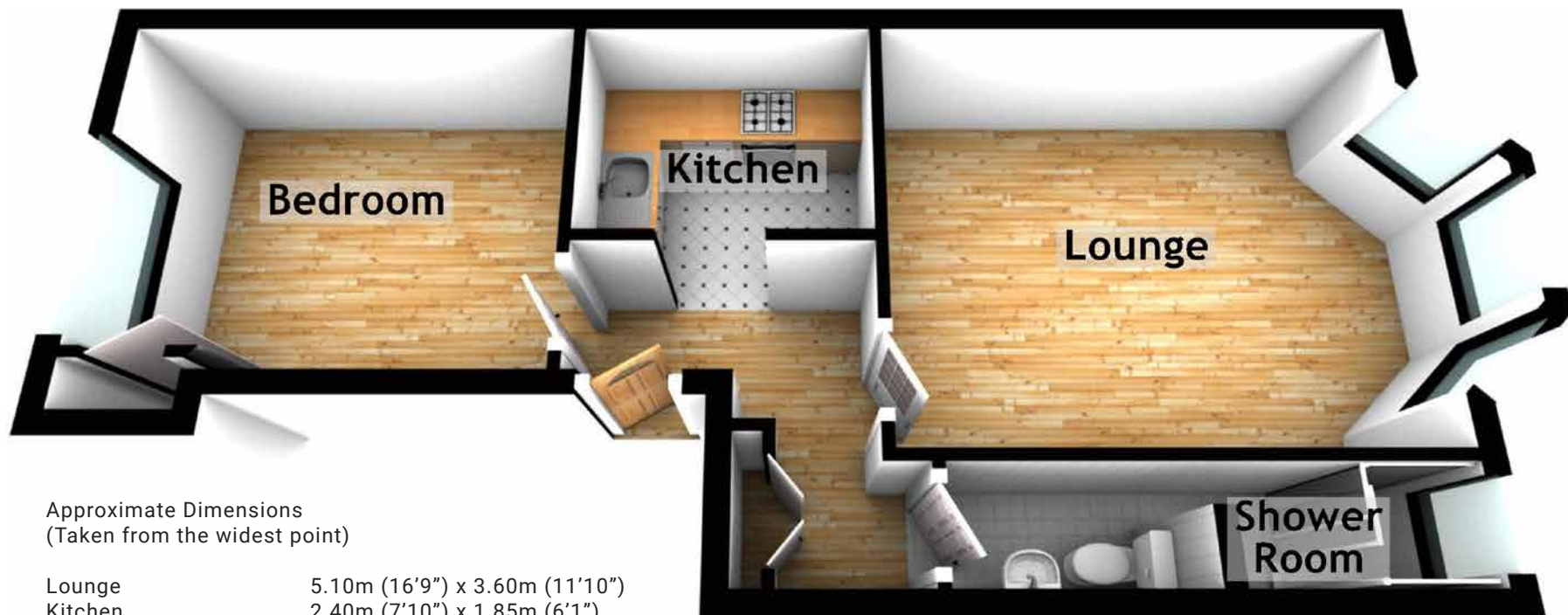

Approximate Dimensions
(Taken from the widest point)

Lounge	5.10m (16'9") x 3.60m (11'10")
Kitchen	2.40m (7'10") x 1.85m (6'1")
Bedroom	3.70m (12'2") x 3.00m (9'10")
Shower Room	3.90m (12'10") x 0.90m (2'11")

Gross internal floor area (m²): 44m²

EPC Rating: C