

# FLOOR PLAN, DIMENSIONS & MAP

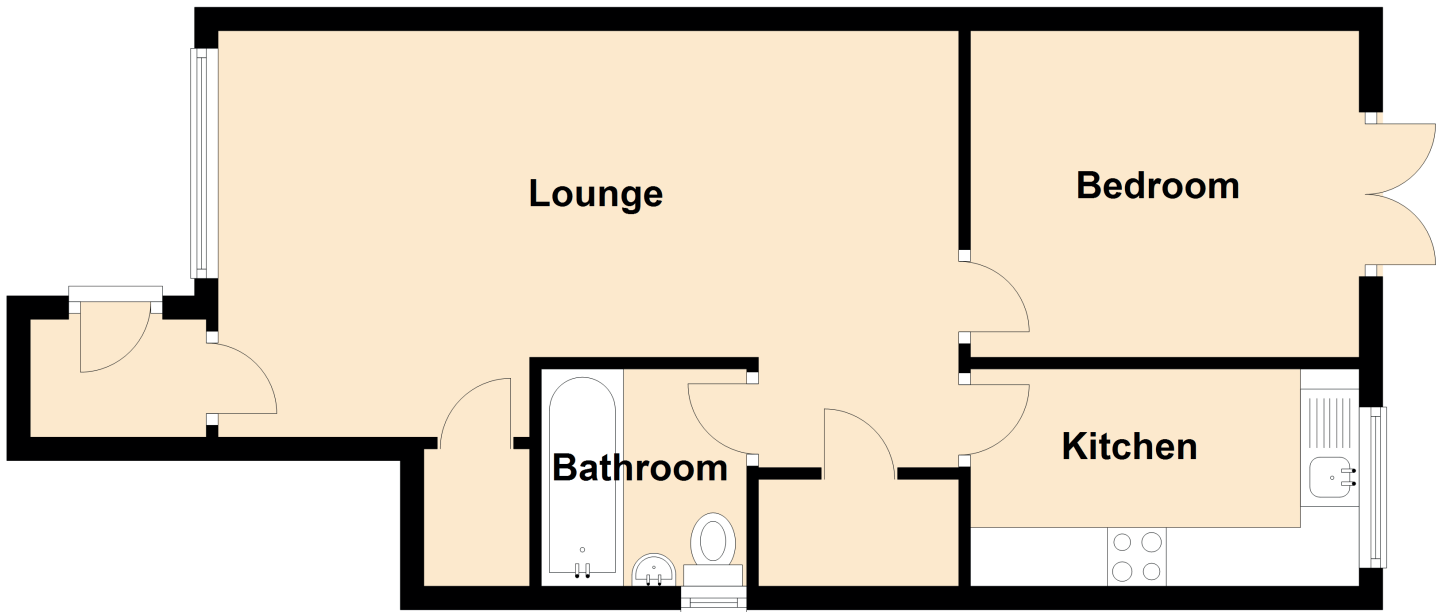

Approximate Dimensions (Taken from the widest point)

Lounge	6.31m (20'8") x 3.72m (12'2")
Kitchen	3.31m (10'10") x 1.85m (6'1")
Bedroom	3.31m (10'10") x 2.78m (9'1")
Bathroom	1.85m (6'1") x 1.75m (5'9")

Gross internal floor area (m<sup>2</sup>): 44m<sup>2</sup> | EPC Rating: C

