

FLOOR PLAN, DIMENSIONS & MAP

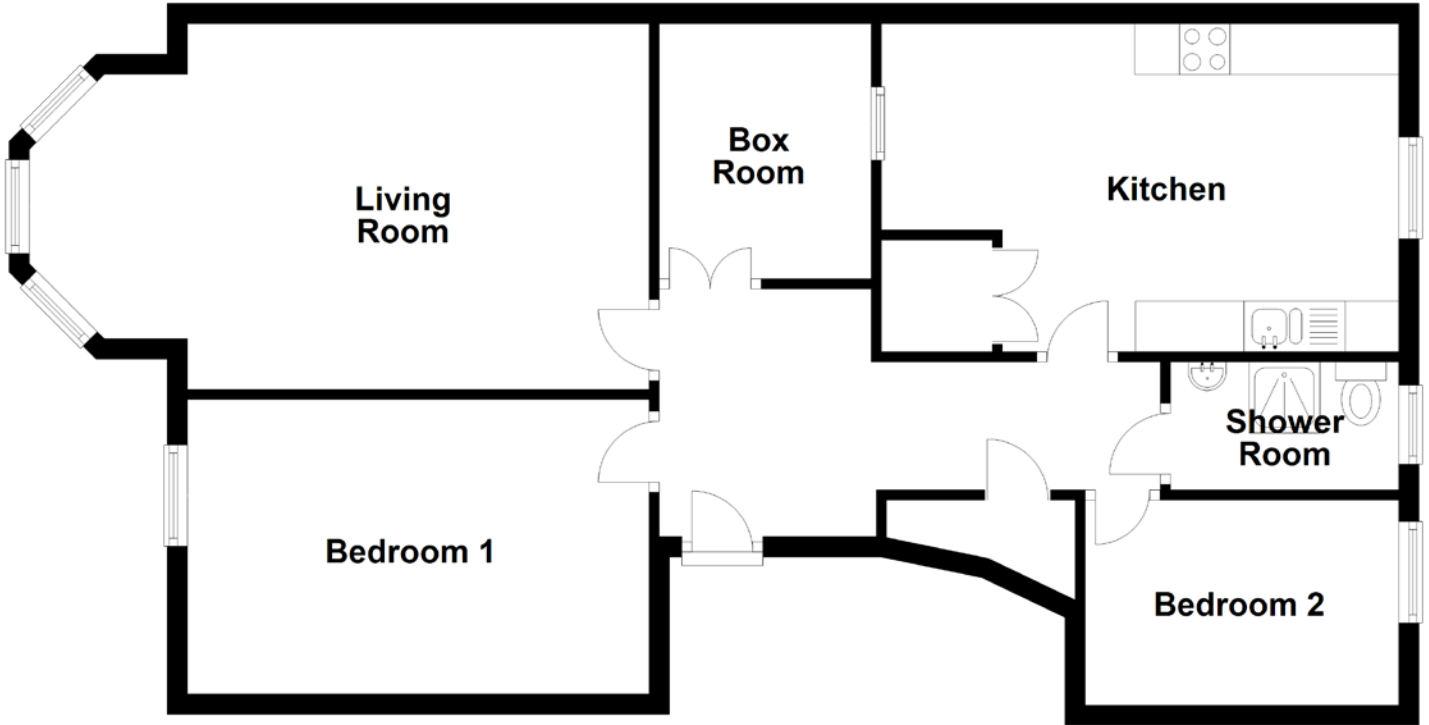

Approximate Dimensions
(Taken from the widest point)

Living Room 6.11m (20'1") x 3.60m (11'10")
 Box Room 2.51m (8'3") x 2.09m (6'10")
 Kitchen 5.10m (16'9") x 3.23m (10'7")

Bedroom 1 4.55m (14'11") x 2.90m (9'6")
 Bedroom 2 3.09m (10'2") x 2.02m (6'8")
 Shower Room 2.25m (7'5") x 1.26m (4'2")

Gross internal floor area (m²): 80m²
 EPC Rating: C

