

FLOOR PLAN, DIMENSIONS & MAP

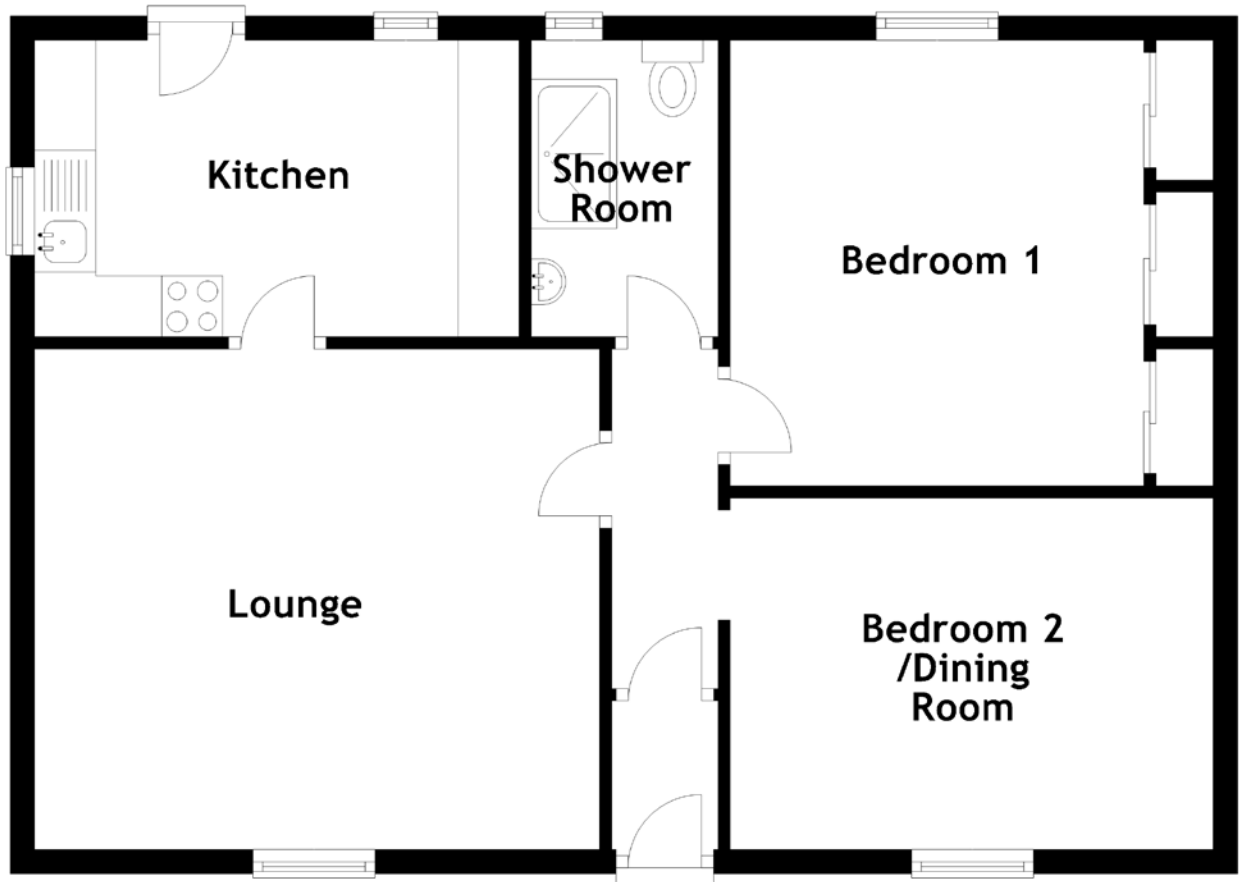

Approximate Dimensions (Taken from the widest point)

Lounge	4.63m (15'2") x 4.10m (13'5")
Kitchen	3.97m (13') x 2.43m (8')
Shower Room	2.43m (8') x 1.53m (5')
Bedroom 1	3.65m (12') x 3.39m (11'1")
Bedroom 2 /Dining Room	3.96m (13') x 2.88m (9'5")

Gross internal floor area (m²): 65m²
EPC Rating: E

Extras (Included in the sale): Furniture and freestanding appliances may be available by separate negotiation.

