

40F Sunnyside Road

COATBRIDGE, ML5 3DG

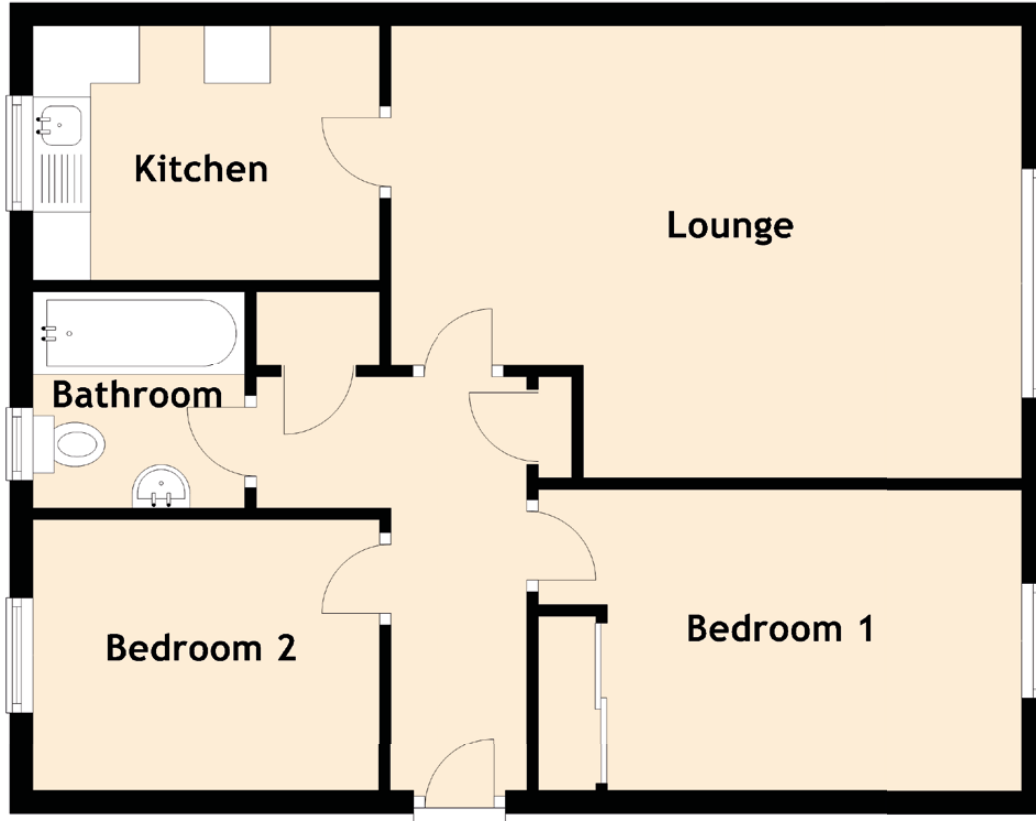

Approximate Dimensions (Taken from the widest point)

Lounge	5.50m (18'1") x 3.94m (12'11")
Kitchen	3.01m (9'11") x 2.21m (7'3")
Bedroom 1	4.21m (13'10") x 2.62m (8'7")
Bedroom 2	3.01m (9'11") x 2.39m (7'10")
Bathroom	1.89m (6'2") x 1.84m (6')

Gross internal floor area (m²): 59m²