

# Specifications & Details

FLOOR PLAN, DIMENSIONS & MAP

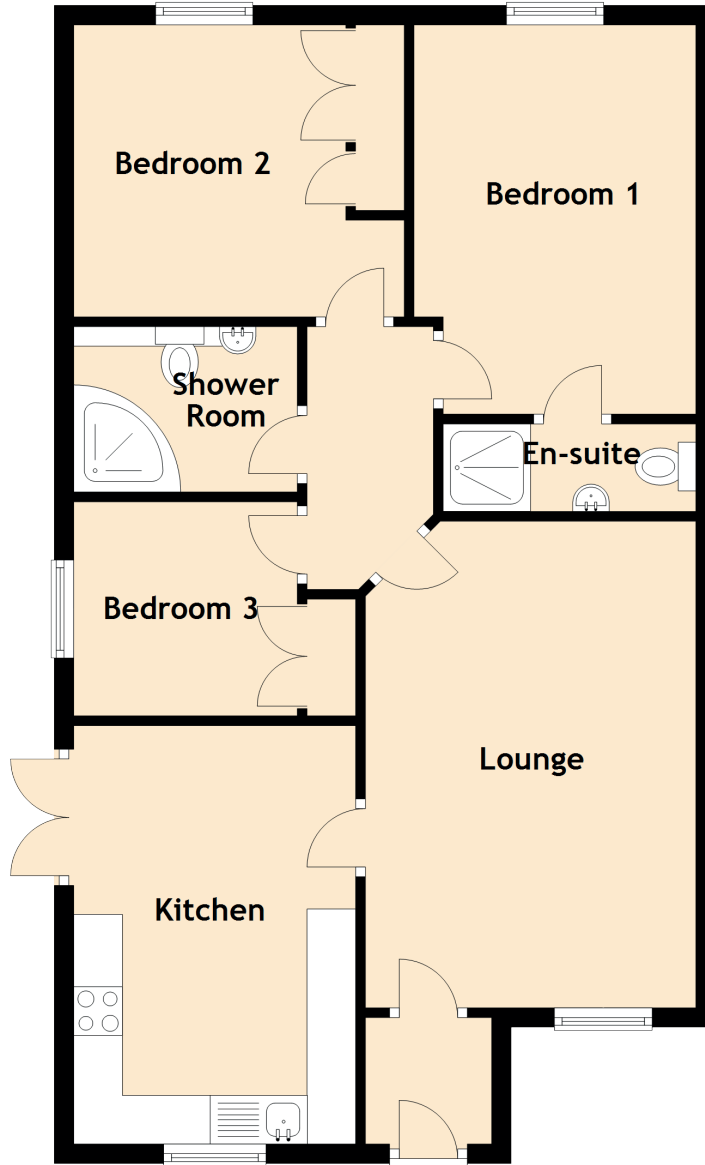

Approximate Dimensions (Taken from the widest point)

Lounge	5.00m (16'5") x 3.40m (11'2")
Kitchen	4.30m (14'1") x 2.90m (9'6")
Bedroom 1	4.00m (13'1") x 2.90m (9'6")
En-suite	2.60m (8'6") x 0.90m (2'11")
Bedroom 2	3.40m (11'2") x 3.00m (9'10")
Bedroom 3	2.30m (7'7") x 2.20m (7'3")
Shower Room	2.30m (7'7") x 1.70m (5'7")

Gross internal floor area (m<sup>2</sup>): 70m<sup>2</sup> | EPC Rating: C

Extras (Included in the sale): Floor coverings, light fittings, blinds, window dressings and integrated appliances.

