

58 Findowrie Street

DUNDEE, ANGUS, DD4 9PR

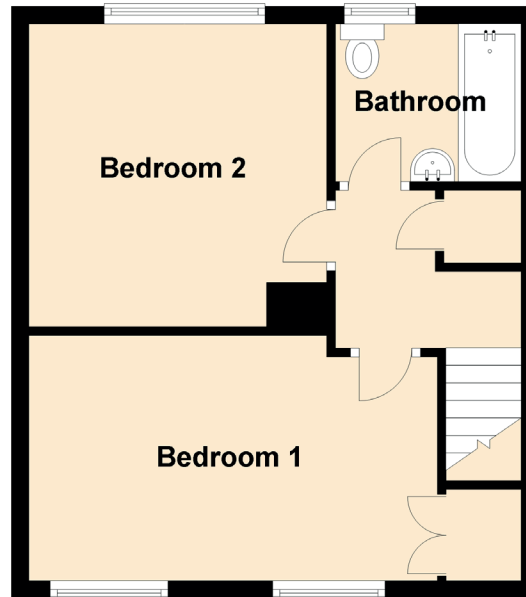
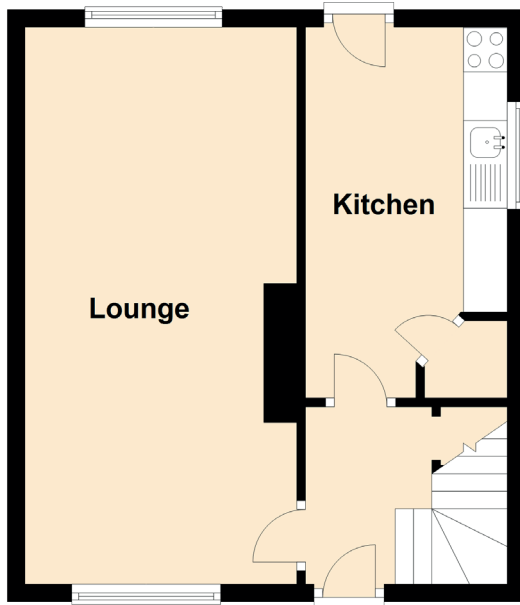

Approximate Dimensions
(Taken from the widest point)

Lounge	6.00m (19'8") x 3.10m (10'2")
Kitchen	4.10m (13'5") x 2.30m (7'7")
Bedroom 1	4.50m (14'9") x 2.80m (9'2")
Bedroom 2	3.40m (11'2") x 3.20m (10'6")
Bathroom	2.10m (6'11") x 1.80m (5'11")