

# 1 Braemore Road

STEWARTON, KILMARNOCK, KA3 3HB

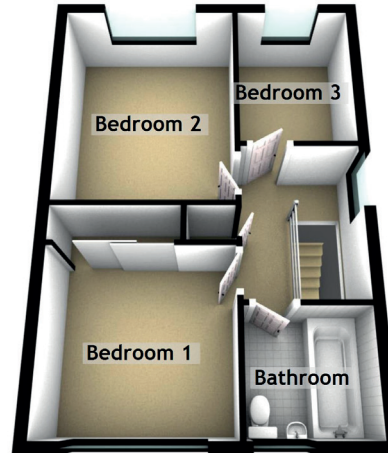
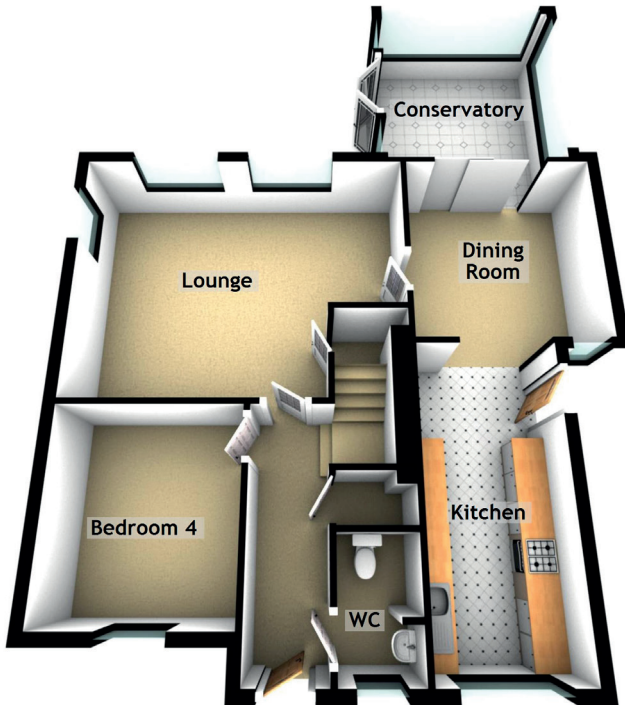

Approximate Dimensions (Taken from the widest point)

## Ground Floor

Lounge	5.50m (18'1") x 4.30m (14'1")
Kitchen	4.90m (16'1") x 2.20m (7'3")
Dining Room	3.30m (10'10") x 3.20m (10'6")
Conservatory	3.30m (10'10") x 3.20m (10'6")
Bedroom 4	3.20m (10'6") x 2.90m (9'6")
WC	2.00m (6'7") x 1.20m (3'11")

## First Floor

Bedroom 1	3.10m (10'2") x 3.00m (9'10")
Bedroom 2	3.60m (11'10") x 3.10m (10'2")
Bedroom 3	2.70m (8'10") x 2.10m (6'11")
Bathroom	2.03m (6'8") x 2.00m (6'7")