

FLOOR PLAN, DIMENSIONS & MAP

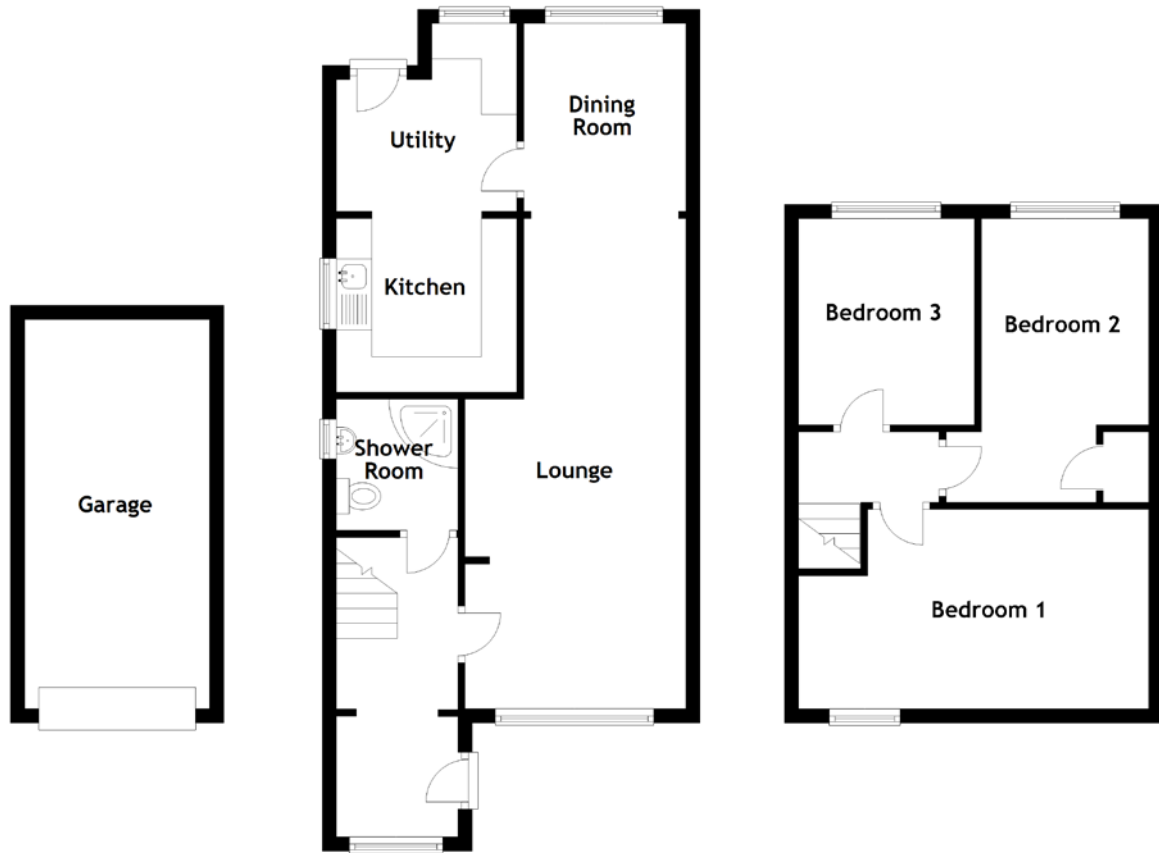

Approximate Dimensions (Taken from the widest point)

Lounge	6.91m (22'8") x 3.11m (10'2")
Dining Room	2.65m (8'8") x 2.25m (7'5")
Kitchen	2.54m (8'4") x 2.45m (8')
Utility	2.54m (8'4") x 1.86m (6'1")
Shower Room	1.85m (6'1") x 1.65m (5'5")

Bedroom 1	4.90m (16'1") x 2.81m (9'3")
Bedroom 2	4.00m (13'1") x 2.85m (9'4")
Bedroom 3	2.91m (9'6") x 2.47m (8'1")
Garage	5.49m (18') x 2.60m (8'6")

Gross internal floor area (m²): 85m²
EPC Rating: C

