

LAND REGISTER
OF SCOTLAND

Officer's ID/Date
4580
31/5/2014



Title Number
BER5371

SUPPLEMENTARY PLAN
TO THE TITLE PLAN

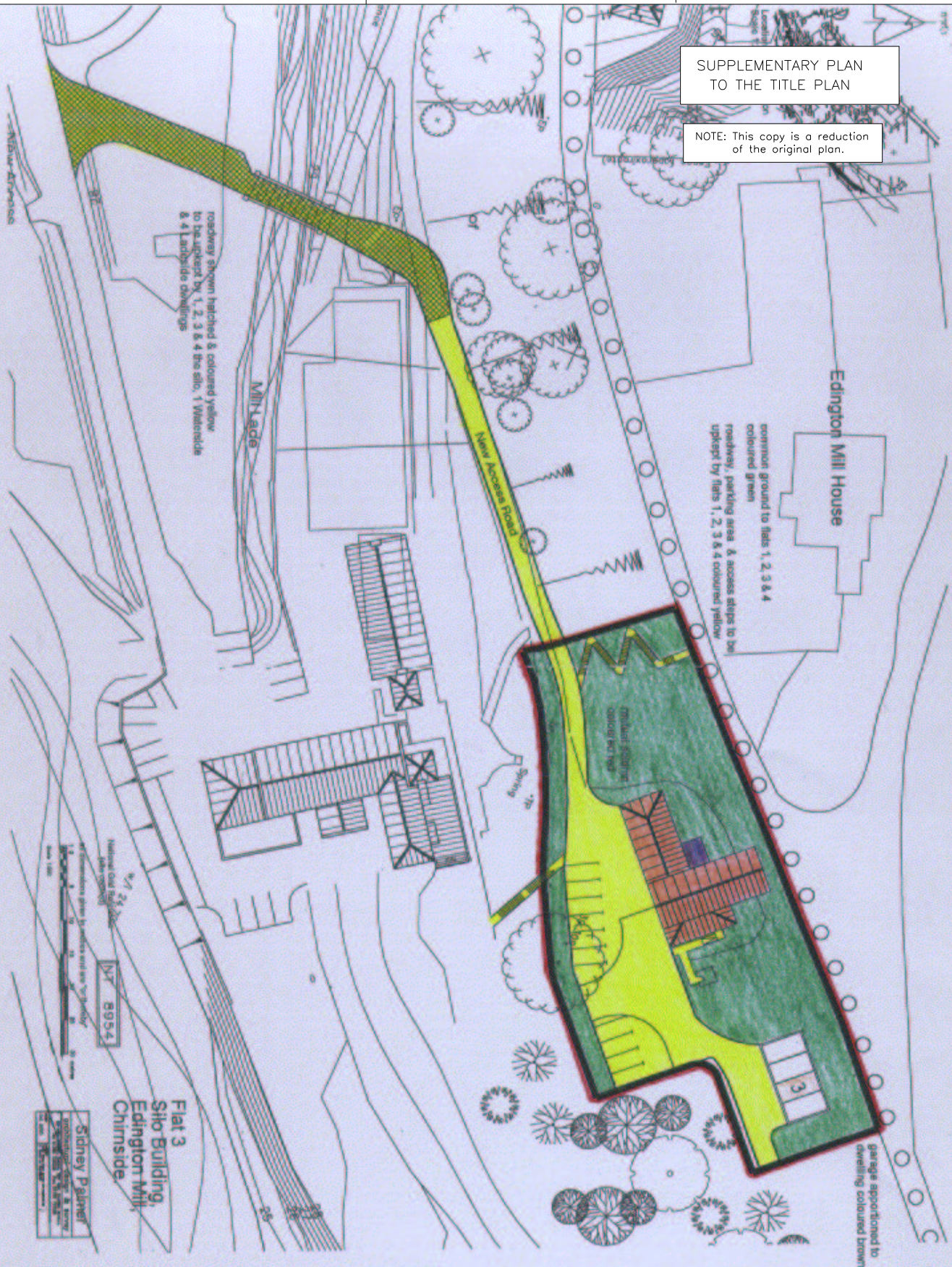
NOTE: This copy is a reduction
of the original plan.



Kelso. 12/07/07.
This is the plan referred to in the foregoing Deed of Conditions.

 LAND REGISTER OF SCOTLAND	Officer's ID / Date	TITLE NUMBER
	4580 31/5/2014	BER5371
 ORDNANCE SURVEY NATIONAL GRID REFERENCE	140m	
	Survey Scale	
NT8854 NT8954 NT9054 NT8855		1/2500
<small>CROWN COPYRIGHT © - This copy has been produced from the RGS Digital Mapping System on 01/06/2014 with the authority of Ordnance Survey under Section 47 of the Copyright, Designs and Patents Act 1988. Unless there is a relevant exception to copyright, the copy must not be copied without the prior permission of the copyright owner. OS Licence no 100041182.</small>		

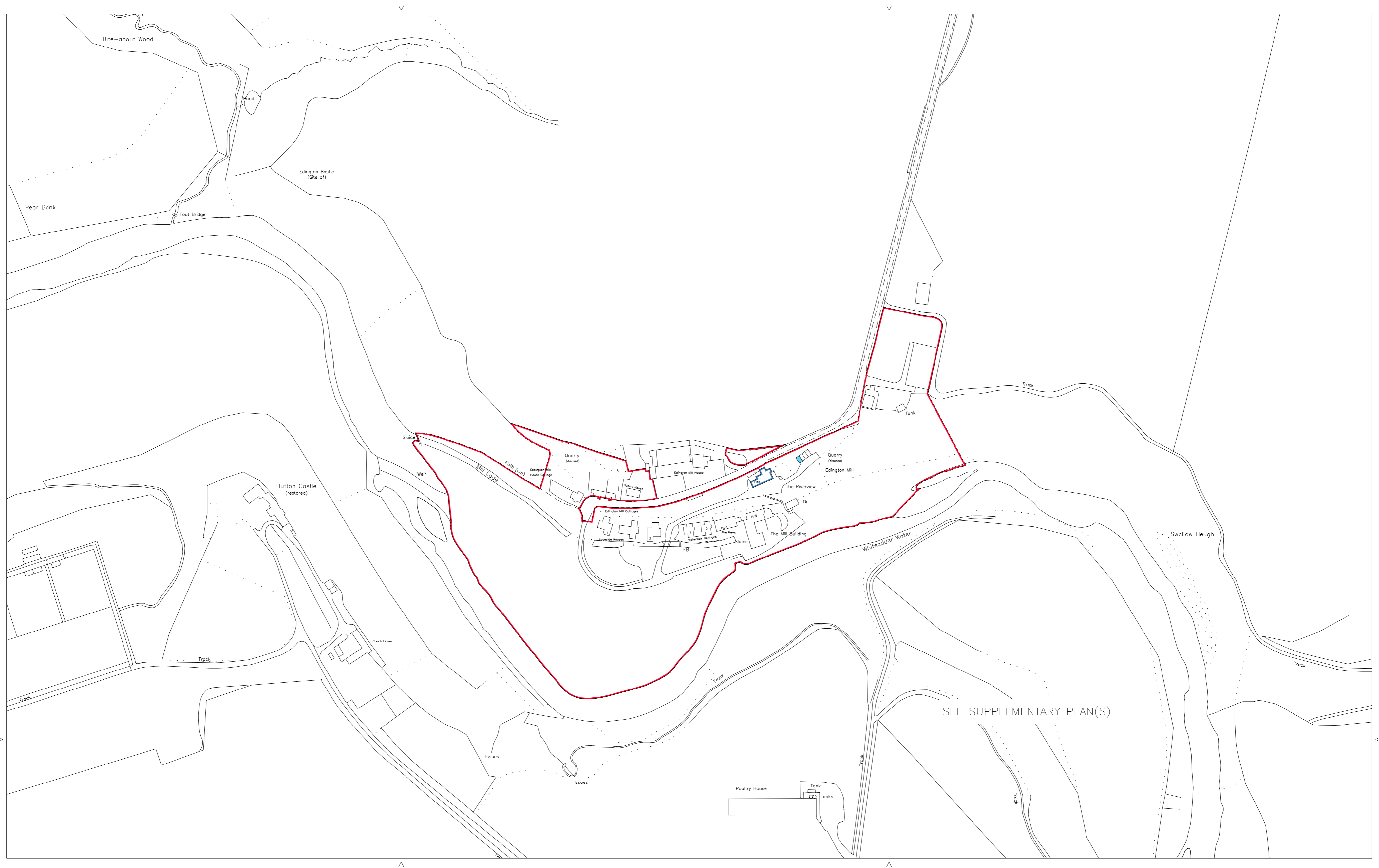

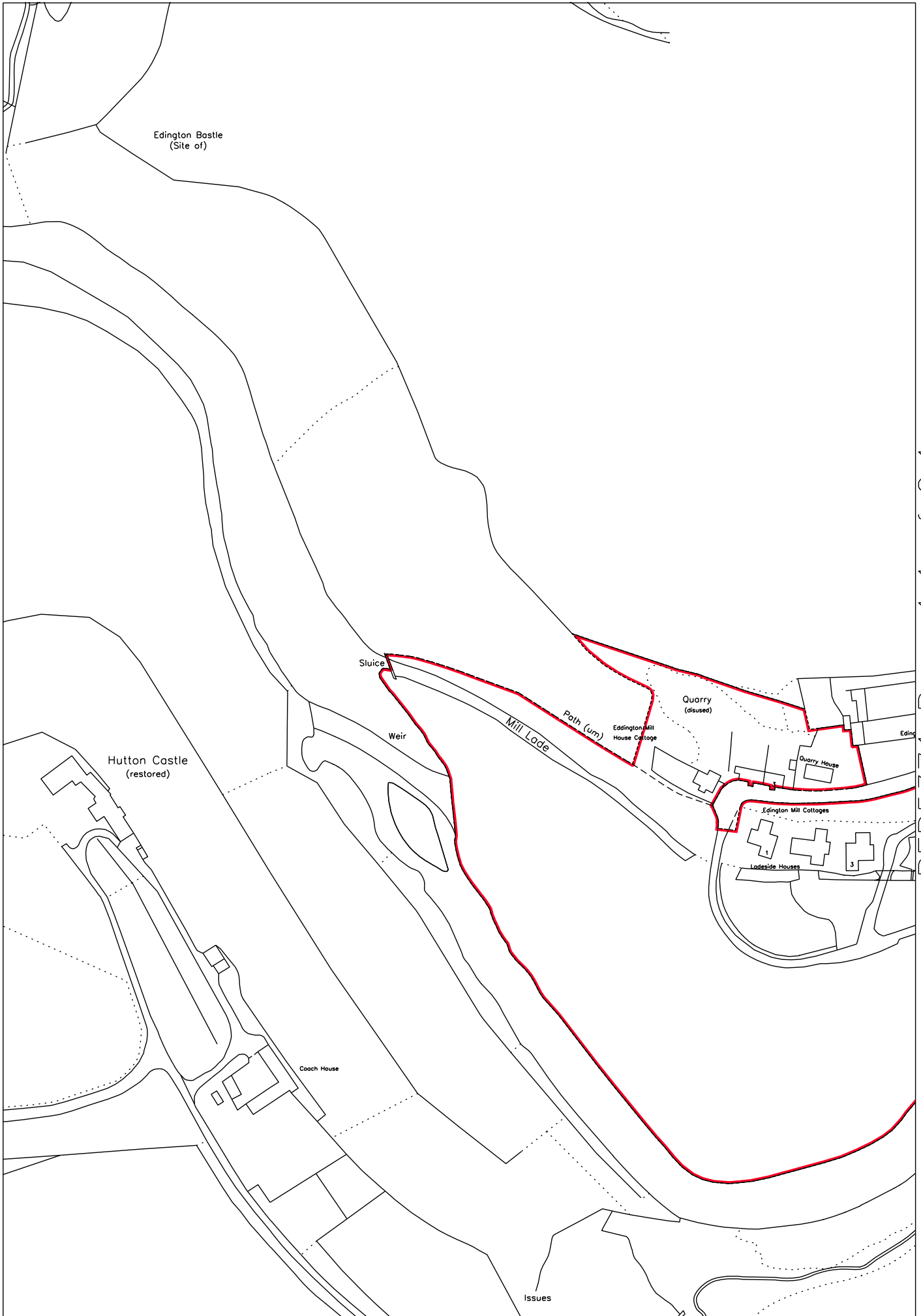



LAND REGISTER
OF SCOTLAND

Officer's ID / Date

4580
31/5/2014

TITLE NUMBER

BER5371



ORDNANCE SURVEY
NATIONAL GRID REFERENCE

140m

NT8854 NT8954 NT8855 NT8955

Survey Scale

1/2500

CROWN COPYRIGHT © - This copy has been produced from the ROS Digital Mapping System on 01/06/2014 with the authority of Ordnance Survey under Section 47 of the Copyright, Designs and Patents Act 1988. Unless there is a relevant exception to copyright, the copy must not be copied without the prior permission of the copyright owner. OS Licence no 100041182.

