



LAND REGISTER
OF SCOTLAND

Officer's ID / Date

4946
17/7/2019

TITLE NUMBER

AYR111091



ORDNANCE SURVEY
NATIONAL GRID REFERENCE

70m



NS3240NE NS3340NW NS3241SE NS3341

Survey Scale

1/1250

CROWN COPYRIGHT © – This copy has been produced from the ROS Digital Mapping System on 21/03/2021 with the authority of Ordnance Survey under Section 47 of the Copyright, Designs and Patents Act 1988. Unless there is a relevant exception to copyright, the copy must not be copied without the prior permission of the copyright owner. OS Licence no 100041182.

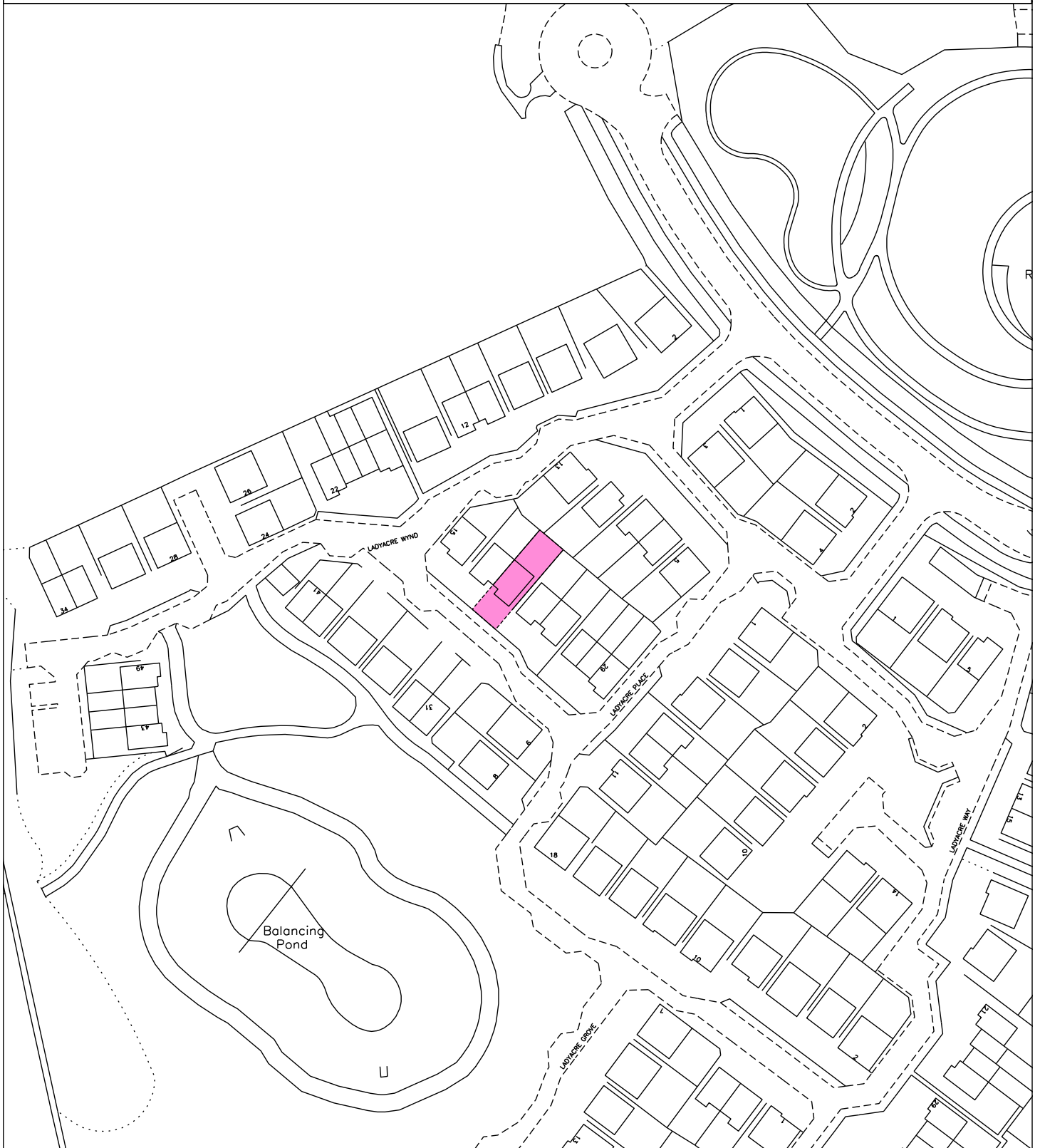

LAND REGISTER
OF SCOTLAND

Officer's ID/Date

4946
17/7/2019

Title Number

AYR111091



SUPPLEMENTARY PLAN 1
TO THE TITLE PLAN

NOTE: This copy is a reduction
of the original plan.

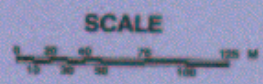

Handwritten signature

This is the plan referred to in the foregoing head of Conditions by The North Ayrshire Council over subjects at **Montgomery Park, Irvine.**

This is plan 2, referred to in the foregoing disposition by The North Ayrshire Council in favour of **Resmoran Homes Limited** in respect of **Sites 13, Montgomery Park, Irvine.**

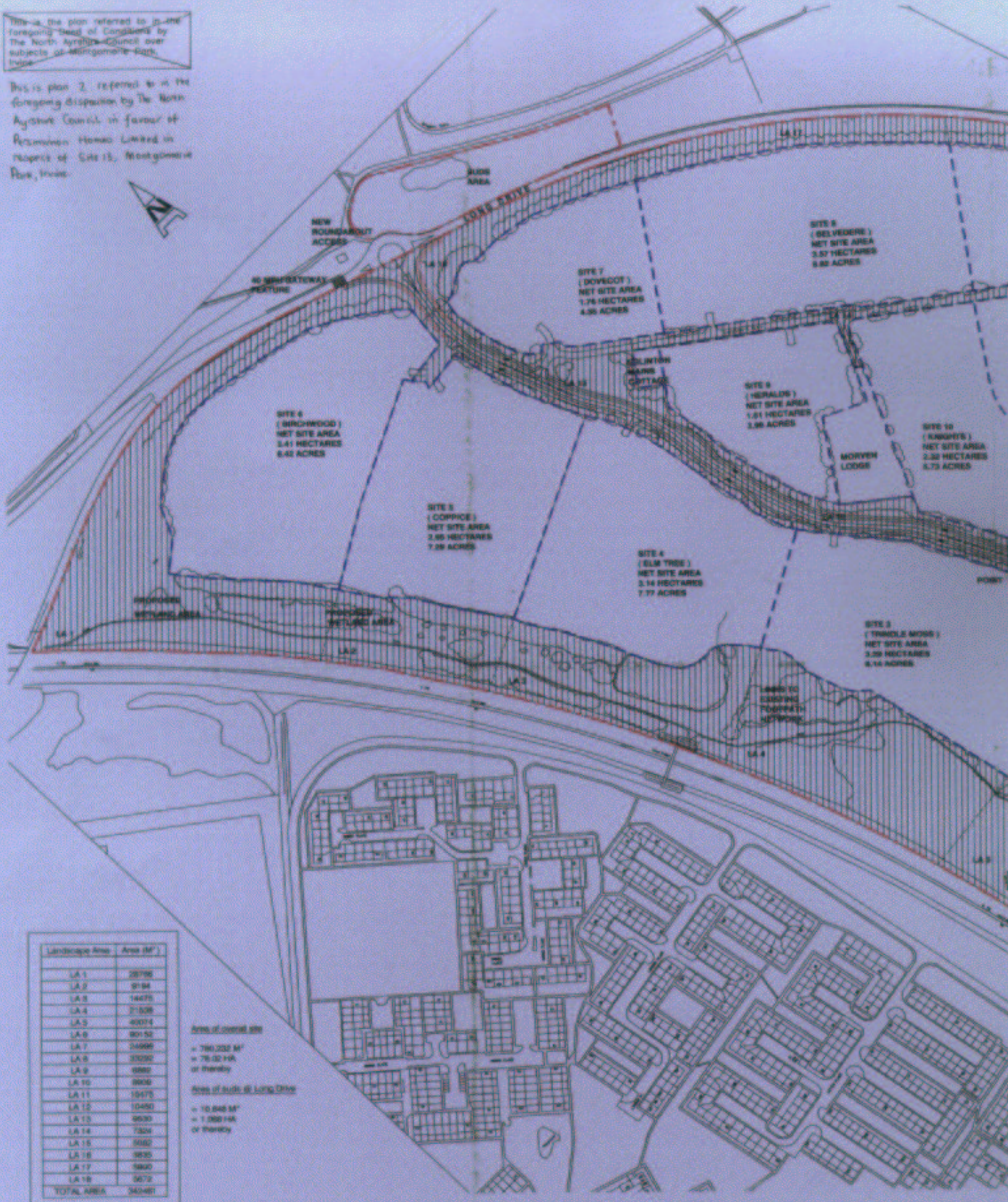

Landscape Area	Area (M ²)
LA 1	28796
LA 2	9194
LA 3	14475
LA 4	71308
LA 5	40274
LA 6	90152
LA 7	34699
LA 8	33092
LA 9	6882
LA 10	8836
LA 11	19475
LA 12	10480
LA 13	9530
LA 14	7324
LA 15	5582
LA 16	9535
LA 17	5800
LA 18	5672
TOTAL AREA	342481

Area of central site
= 786,232 M²
= 76.00 HA
of hereby

Area of south of Long Drive
= 10,848 M²
= 1.069 HA
of hereby

All areas noted are to be considered to be approximate or thereby.

- Overall site boundary indicated thus ---
- Individual housing site boundary indicated thus ---
- Individual other use site boundary indicated thus ---
- SS / OS = Substation / Gas Overhead

LAND REGISTER OF SCOTLAND

Officer's ID/Date

4946
17/7/2019

Title Number

AYR111091

SUPPLEMENTARY PLAN 2
TO THE TITLE PLAN

NOTE: This copy is a reduction
of the original plan.

THIS IS THE PLAN REFERRED TO IN THE FOREGOING
DEED OF CONDITIONS BY THE NORTH AYRSHIRE COUNCIL, IRVINE HOUSING ASSOCIATION LIMITED AND DAVID WILSON HOMES LIMITED
Montgomery Park, Irvine

Plot 1 - area within red boundary = 69.02 hectares (170.69 acres) or thereby, excluding areas hatched blue
Plot 2 - area within red boundary & hatched green = 1.40 hectares (3.47 acres) or thereby

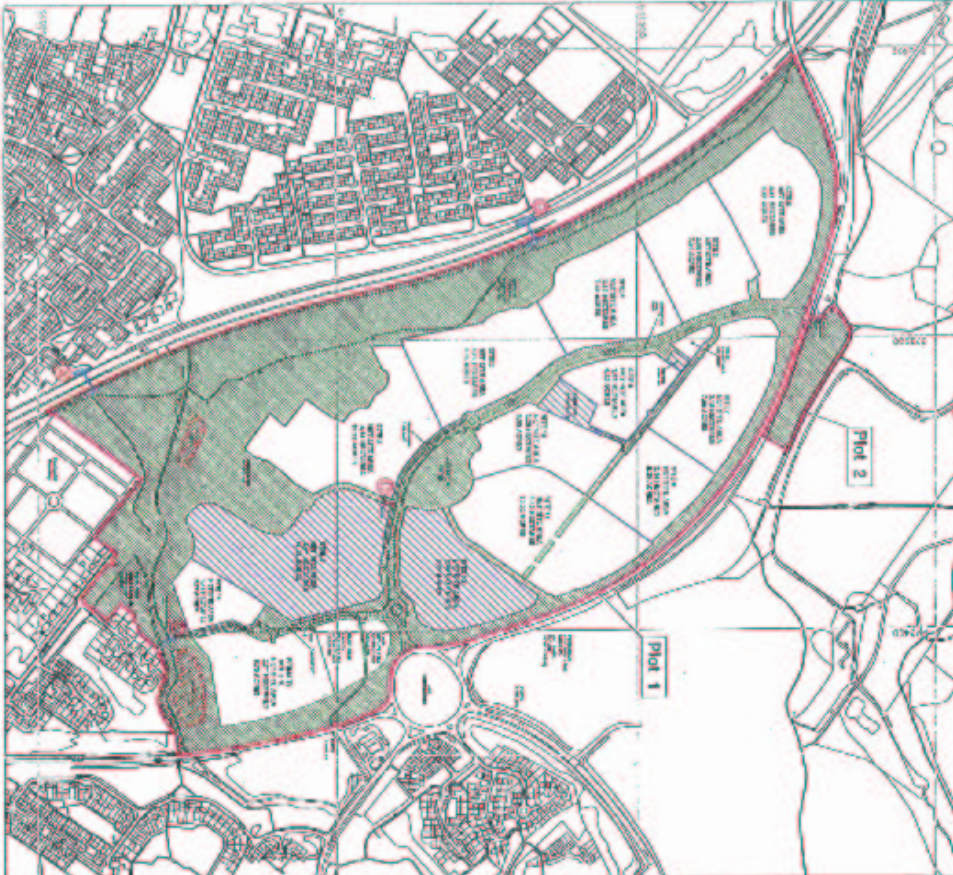

Site	Area	Hectares
1	12.28	4.87
2	10.72	4.14
3	8.05	3.28
4	7.82	3.16
5	7.57	2.98
6	8.42	3.41
7	7.88	3.19
8	6.25	2.54
9	4.75	1.88
10	3.55	2.25
11	10.89	4.42
12	7.27	2.94
13	2.77	1.11
14	0.50	0.20
15	0.83	0.33
16	1.25	0.75
17	3.70	2.71
18	2.70	1.08

- Total landscaped area (34.79 hectares or 85.92 acres or thereby)
- Housing sites 1 & 13, Morven Lodge & Eglington Molins - excluded (8.45 hectares or 20.88 acres or thereby)
- Ponds - already constructed
- Individual residential site boundaries
- Individual non-residential site boundaries
- Bridge structures (coloured light blue)
- Sub station (coloured red)



North Ayrshire
A 7 FORMER
GENERAL DEDUCTIVE SYSTEM
OF THE
DUNDEE BY
FROM WILKINSON
L1415
OS/OS/2011
DRAWING No. X064 V8
SCALE 1/17500
OS SHEET N82540

Robert J. ...
...
4/17



Boundary information supplied by a 2.4 metre, May 2008, photograph
Downloaded from the Ordnance Survey map with the permission of the Controller
of Her Majesty's Stationery Office Crown Copyright Licence No. 100020200

LAND REGISTER OF SCOTLAND







Officer's ID/Date

4946
17/7/2019

Title Number

AYR111091



-  Total landscaped area (34.79 hectares or 85.92 acres or thereby)
-  Housing sites 1, 11, 13 & 14, Morven Lodge & Eglinton Mains - excluded (13.84 hectares or 34.23 acres or thereby)
-  Ponds - already constructed
-  Individual residential site boundaries
-  Individual non-residential site boundaries
-  Bridge structures (coloured light blue)
-  Sub station (coloured red)

Plot 1 - area within pale blue boundary = 69.02 hectares (170.59 acres) or thereby, excluding areas hatched blue
 Plot 2 - area within pale blue boundary and hatched green = 1.40 hectares (3.47 acres) or thereby

SUPPLEMENTARY PLAN 3
TO THE TITLE PLAN

NOTE: This copy is a reduction of the original plan.



DESIGNED BY	Dave Wainwright
DATE	07/09/2019
DRAWING NO	ZSA-P
SCALE	1:7500
OS SHEET	NB5540

THIS IS PLAN 2 REFERRED TO IN THE FOREGOING DISPOSITION BY THE NORTH AYRSHIRE COUNCIL IN FAVOUR OF PERSIMMON HOMES LIMITED IN RESPECT OF OF:
Site 2, Montgomerie Park, Irvine
 Area within red boundary = 4.24 hectares (10.48 acres) or thereby

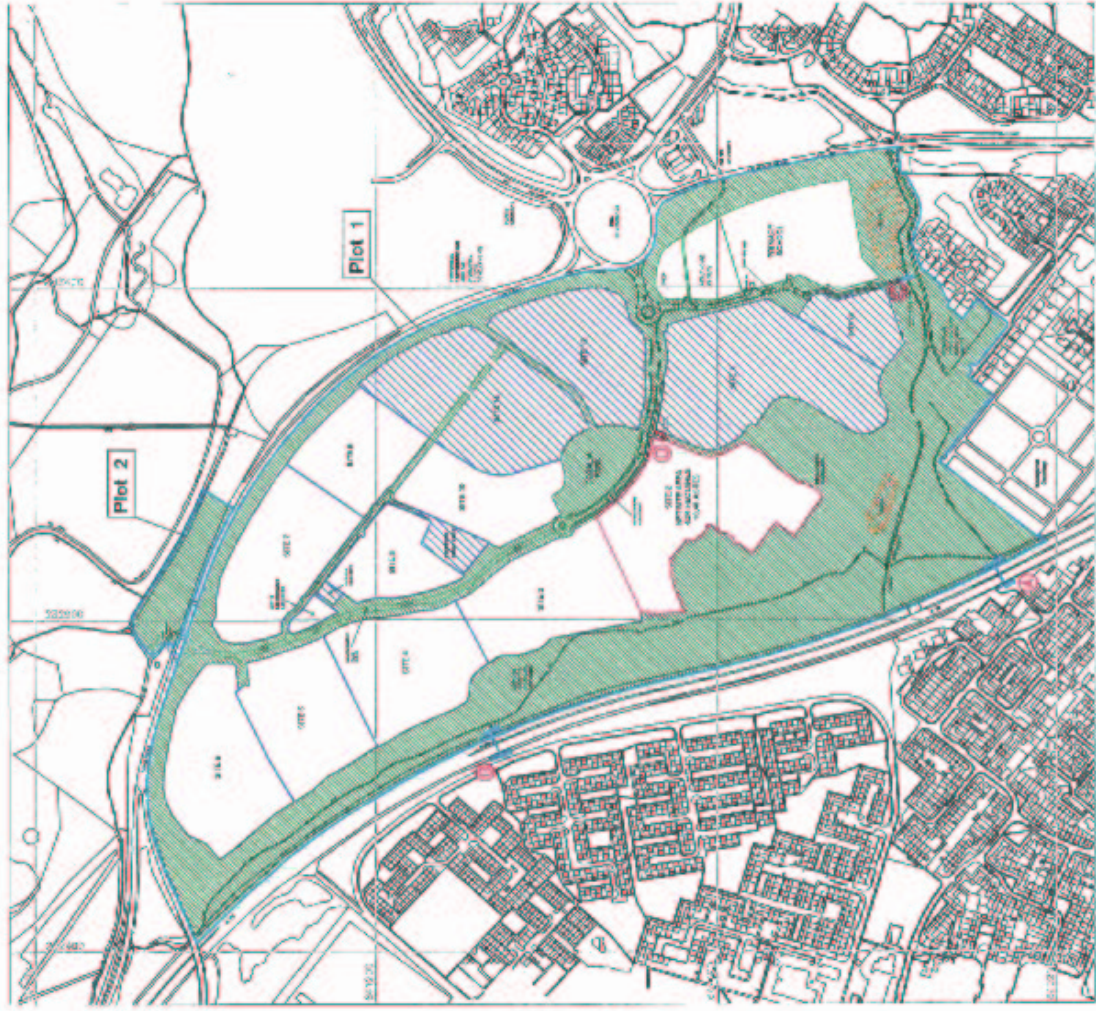

Boundary information supplied by 3 3 Logic, May 2007. Information & Inspection Homes Viability Plan, July 2012. Reproduced from the Ordnance Survey map with the permission of The Controller of Her Majesty's Stationery Office. Copyright Licence No. 100023393