



<div></div> <div>LAND REGISTER OF SCOTLAND</div>		Officer's ID / Date	TITLE NUMBER
		4639 3/8/2011	<b>INV23926</b>
<div></div>	ORDNANCE SURVEY NATIONAL GRID REFERENCE		<div><div></div>140m<div></div></div>
NH3708 NH3808 NH3709 NH3809			Survey Scale
			1/2500

CROWN COPYRIGHT © – This copy has been produced from the ROS Digital Mapping System on 26/03/2021 with the authority of Ordnance Survey under Section 47 of the Copyright, Designs and Patents Act 1988. Unless there is a relevant exception to copyright, the copy must not be copied without the prior permission of the copyright owner. OS Licence no 100041182.



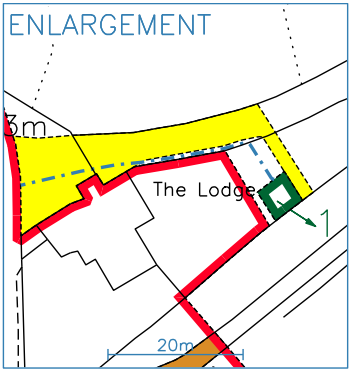
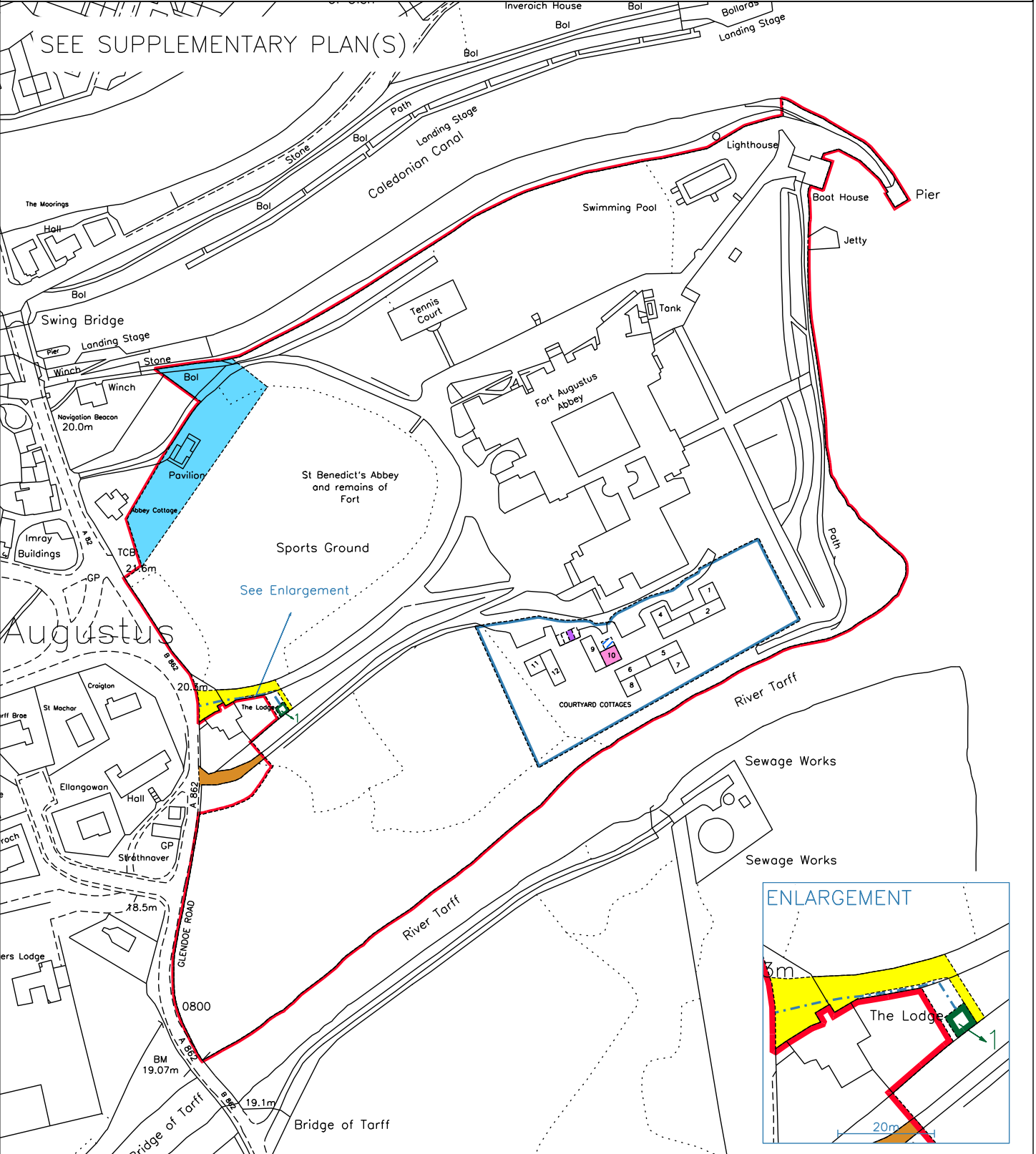

LAND REGISTER OF SCOTLAND	Officer's ID/Date	Title      Number
	4639 3/8/2011	INV23926

SUPPLEMENTARY PLAN  
TO THE TITLE PLAN

This is the plan referred to in the foregoing disposition.

POSTAL ADDRESS:  
The Boat House  
St Benedict's Abbey  
Fort Augustus  
Inverness-shire  
PH32 4SL

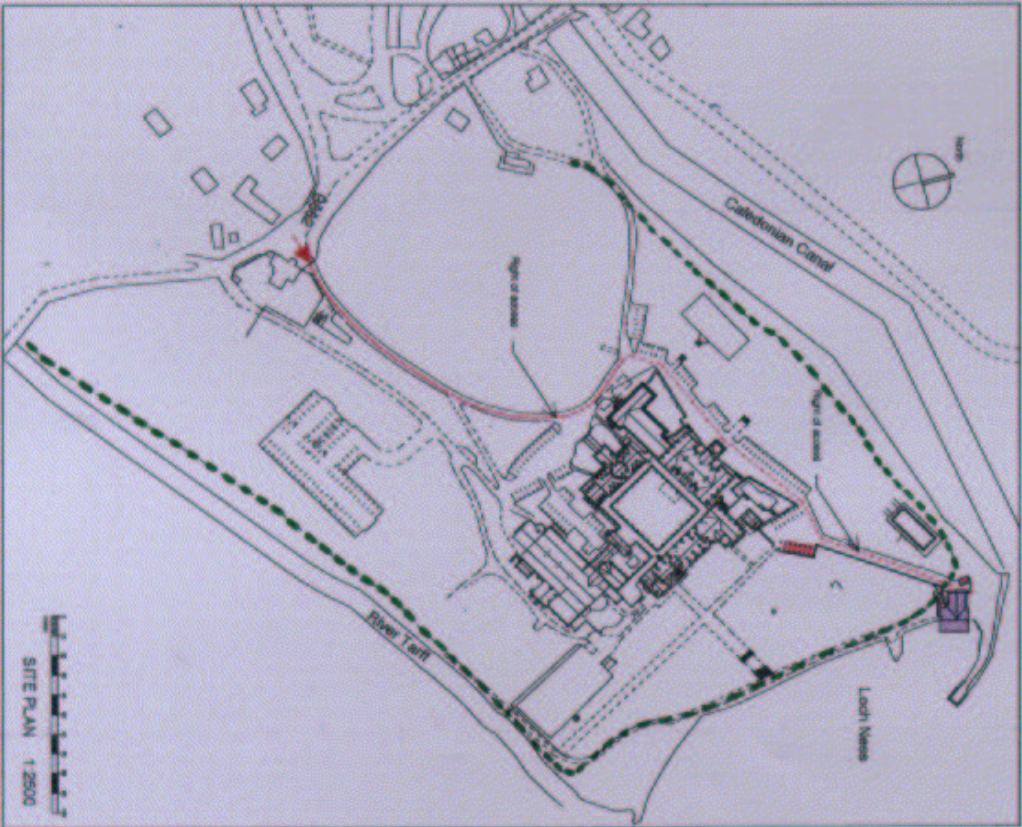
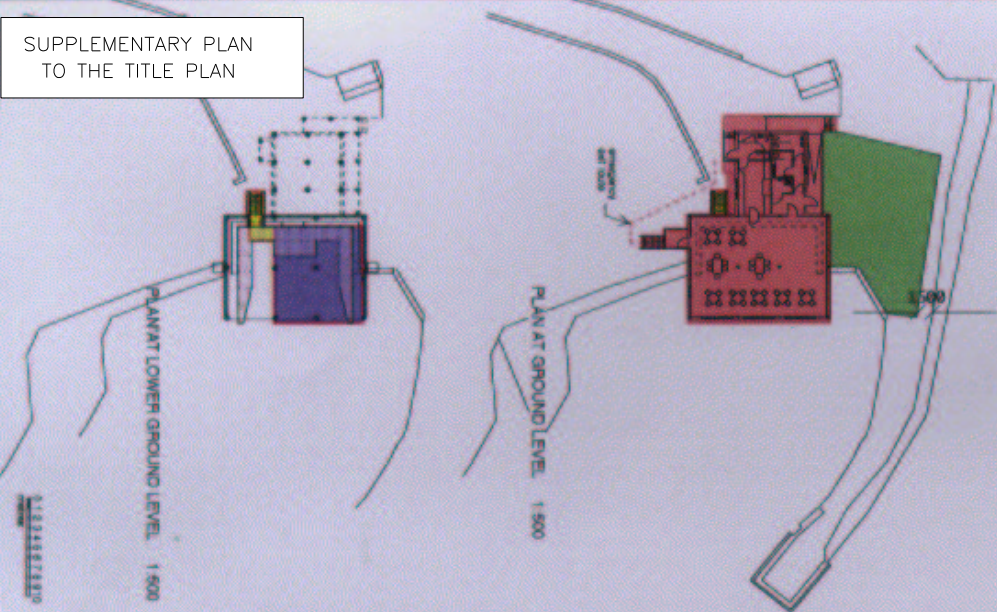

This is Plan 3 referred to in the foregoing Constitutive Deed  
of Conditions and Real Burdens by Raven Highlands Limited.

*[Handwritten signature]*  
*[Handwritten signature]*  
(witness)