



LAND REGISTER  
OF SCOTLAND

Officer's ID / Date

6707  
4/11/2016

TITLE NUMBER

**MID119457**



ORDNANCE SURVEY  
NATIONAL GRID REFERENCE

70m

NT2776SW NT2776NW

Survey Scale

1/1250

CROWN COPYRIGHT © – This copy has been produced from the ROS Digital Mapping System on 30/03/2021 with the authority of Ordnance Survey under Section 47 of the Copyright, Designs and Patents Act 1988. Unless there is a relevant exception to copyright, the copy must not be copied without the prior permission of the copyright owner. OS Licence no 100041182.

SEE SUPPLEMENTARY PLAN(S)

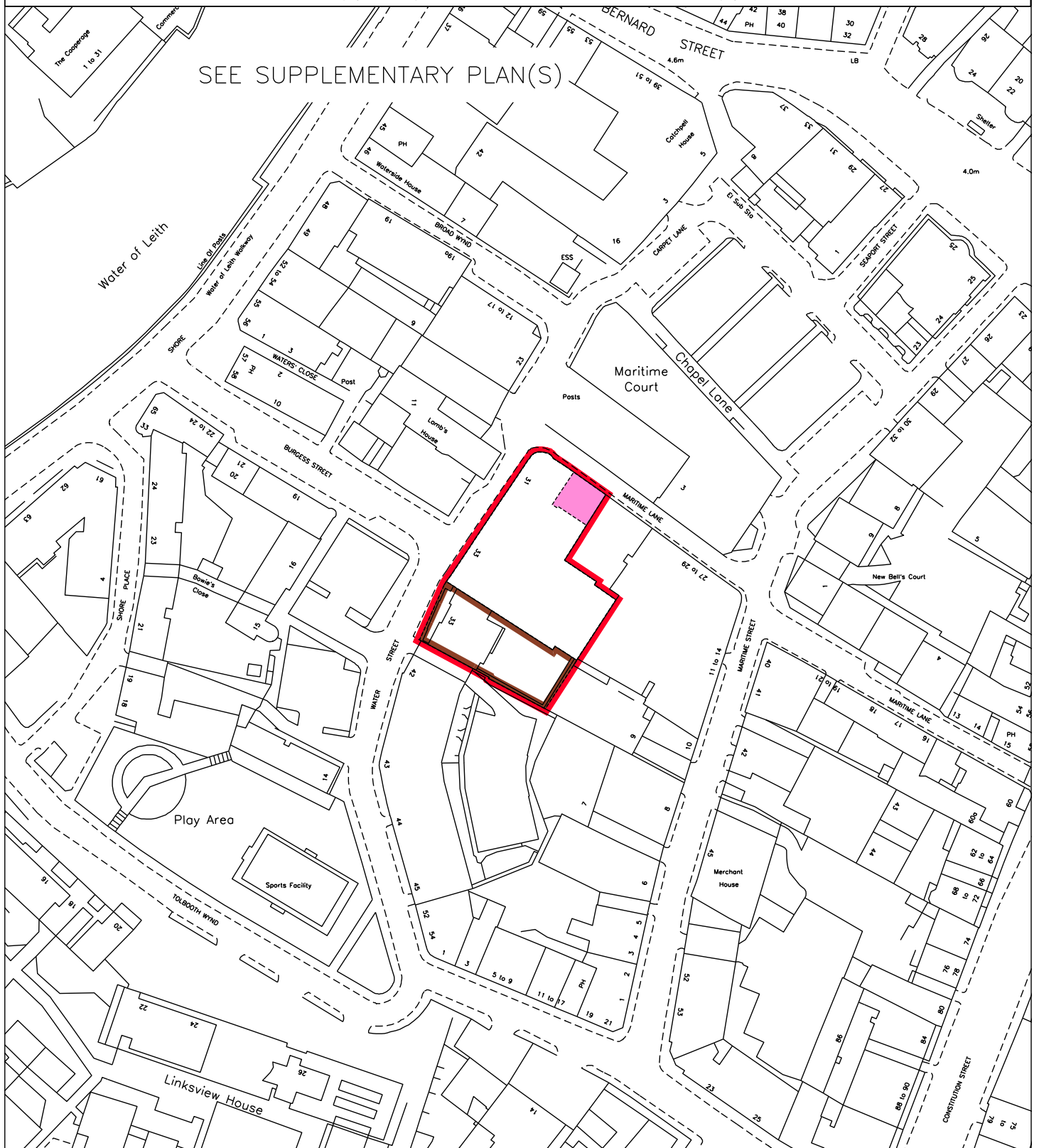

LAND REGISTER  
OF SCOTLAND

Officer's ID/Date

6707  
4/11/2016

Title Number

MID119457

SUPPLEMENTARY PLAN 2  
TO THE TITLE PLAN

NOTE: This copy is a reduction  
of the original plan.

**young&gault**  
Chartered Accountants  
Chartered Surveyors  
Chartered Engineers  
Chartered Quantity Surveyors

1000001100  
Maritime House  
33 Water Street, Leith  
EDINBURGH EH6 6EJ

**A3**  
Title Plan  
33 Water Street (Amenity Deck)  
Date:  
Scale:  
Sheet No:  
Project No:  
745/980002  
Checked By:  
Date:

**YG**  
Young & Gault  
1000001100  
Maritime House  
33 Water Street, Leith  
EDINBURGH EH6 6EJ  
www.youngandgault.co.uk



Amenity Deck

This is the Plan No. 2 referred to in the foregoing deed of declaration of Conditions by Fairmair Limited with consent in respect of Maritime Road, Water Street, Leith, Edinburgh.

42  
3271000  
S. J. [Signature]  
S. J. [Signature]  
D. T. [Signature]  
Gates  
50s pt Burely  
B. M. [Signature]  
60s pt Burely  
in [Signature]  
in [Signature]

LAND REGISTER  
OF SCOTLAND

Officer's ID/Date  
6707  
4/11/2016

Title Number  
MID119457

SUPPLEMENTARY PLAN 1  
TO THE TITLE PLAN

NOTE: This copy is a reduction  
of the original plan.

**young and gault**  
Chartered Architects  
Masterplanners  
Development Consultancy

Project Title  
Marketing Board  
31 - 33 Water Street, Leith  
EDINBURGH EH6 6JZ

**A3**  
Title Plan  
33 Water Street  
Ground Floor  
Scale  
Date  
Drawn By  
Checked By  
Date

**ys**  
Yasmin Siddiqui  
745090001  
11/01/2016  
11/01/2016  
11/01/2016  
www.youngandgault.co.uk

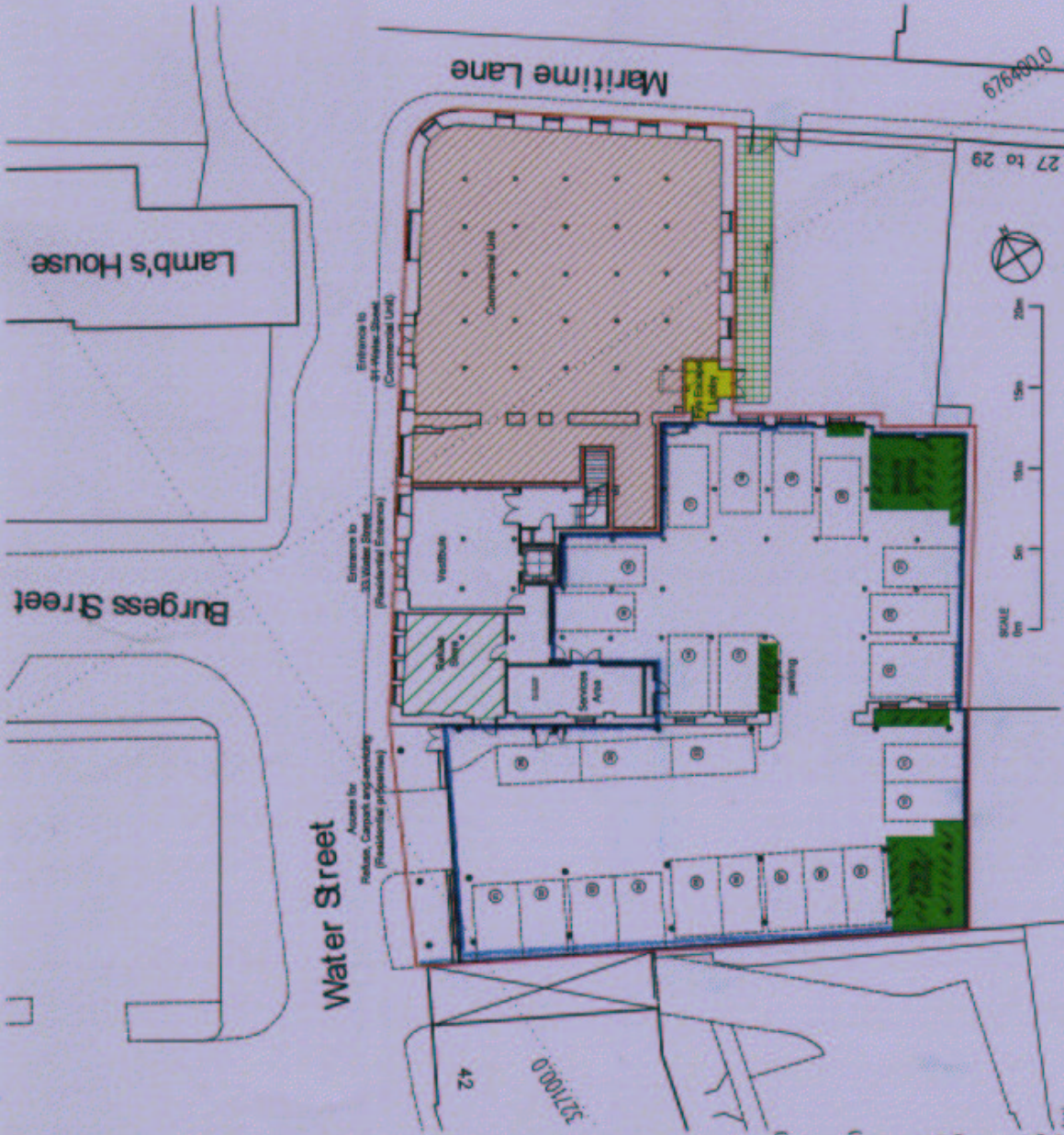

- Site boundary
- Boundary between Residential and Commercial
- Deposit
- Right of access
- Right of Access across neighbouring land
- Commercial Unit
- Residence
- Cycle tracks

This is the Plan No. 1 referred to in the foregoing Deed of Declaration of Conditions by Harumair Limited with consents in respect of Maritime Hall, Water Street, Leith, Edinburgh.

*David T. Suddock*  
*Chris*  
*B. J. M. Munro*