



LAND REGISTER  
OF SCOTLAND

Officer's ID / Date

2585  
26/11/2008

Supplementary Plan to Title

**GLA191294-1**



ORDNANCE SURVEY  
NATIONAL GRID REFERENCE

70m

NS6064SW

Survey Scale

1/1250

CROWN COPYRIGHT © - This copy has been produced from the ROS Digital Mapping System on 01/03/2009 and was made with the authority of Ordnance Survey pursuant to Section 47 of the Copyright, Designs and Patents Act 1988. Unless that act provides a relevant exception to copyright, the copy must not be copied without the prior permission of the copyright owner.

NOTE : THE LAND TINTED GREEN HEREON  
IS NOT INCLUDED IN THE TITLE

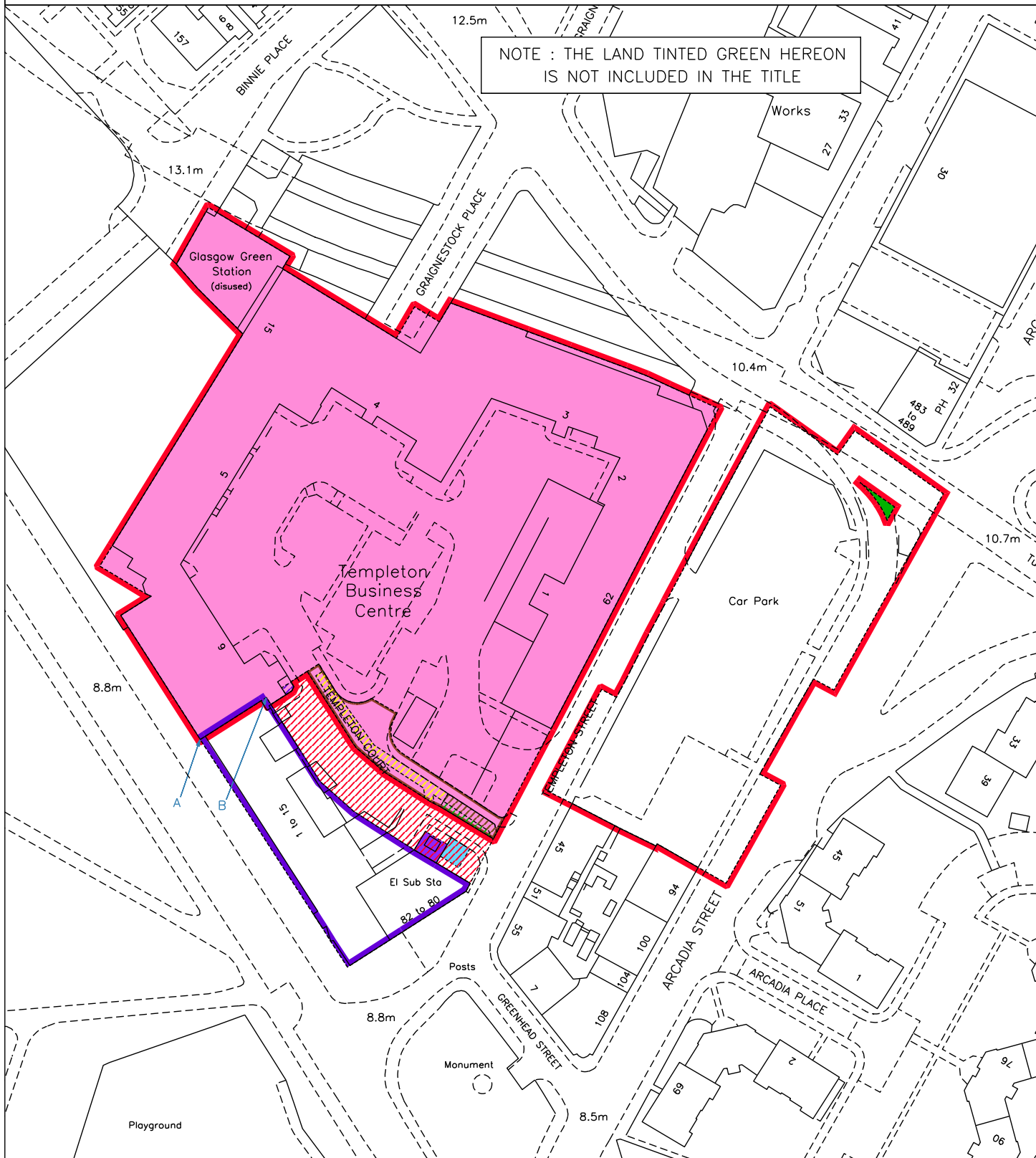

LAND REGISTER OF SCOTLAND	Officer's ID/Date	Title Number
	4916 22/1/2009	GLA191294

NOTE: This copy is a reduction of the original plan.

SUPPLEMENTARY PLAN 2  
TO THE TITLE PLAN

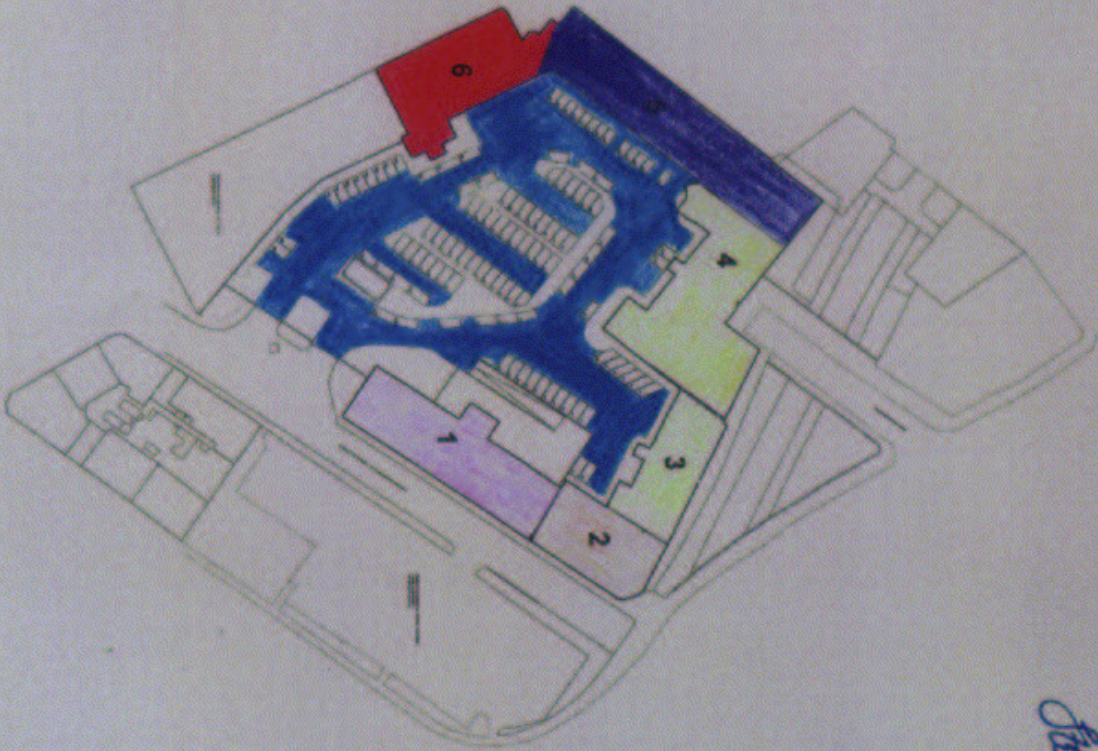

*This will be prepared by the planning  
department of Glasgow City Council  
Glasgow University*

Planning as Existing

- Complex Usage
- 1. Access - car
  - 2. Access - bicycle
  - 3. Access - pedestrian
  - 4. Access - wheelchair
  - 5. Access - horse
  - 6. Access - dog

STANDARD TITLE PLAN

1:1000

DATE: 22/1/2009

OFFICER: 4916

PROJECT: SUPPLEMENTARY PLAN 2

SCALE: 1:1000

APPENDIX

*[Handwritten signature]*



LAND REGISTER  
OF SCOTLAND

Officer's ID / Date

4916  
22/1/2009

TITLE NUMBER

**GLA191294**



ORDNANCE SURVEY  
NATIONAL GRID REFERENCE

70m

NS6064SW

Survey Scale

1/1250

CROWN COPYRIGHT © - This copy has been produced from the ROS Digital Mapping System on 01/03/2009 and was made with the authority of Ordnance Survey pursuant to Section 47 of the Copyright, Designs and Patents Act 1988. Unless that act provides a relevant exception to copyright, the copy must not be copied without the prior permission of the copyright owner.

