



LAND REGISTER
OF SCOTLAND

Officer's ID / Date

6709
23/3/2017

TITLE NUMBER

MID148764



ORDNANCE SURVEY
NATIONAL GRID REFERENCE

70m

NT3467NE NT3567

Survey Scale

1/1250

CROWN COPYRIGHT © – This copy has been produced from the ROS Digital Mapping System on 31/03/2021 with the authority of Ordnance Survey under Section 47 of the Copyright, Designs and Patents Act 1988. Unless there is a relevant exception to copyright, the copy must not be copied without the prior permission of the copyright owner. OS Licence no 100041182.

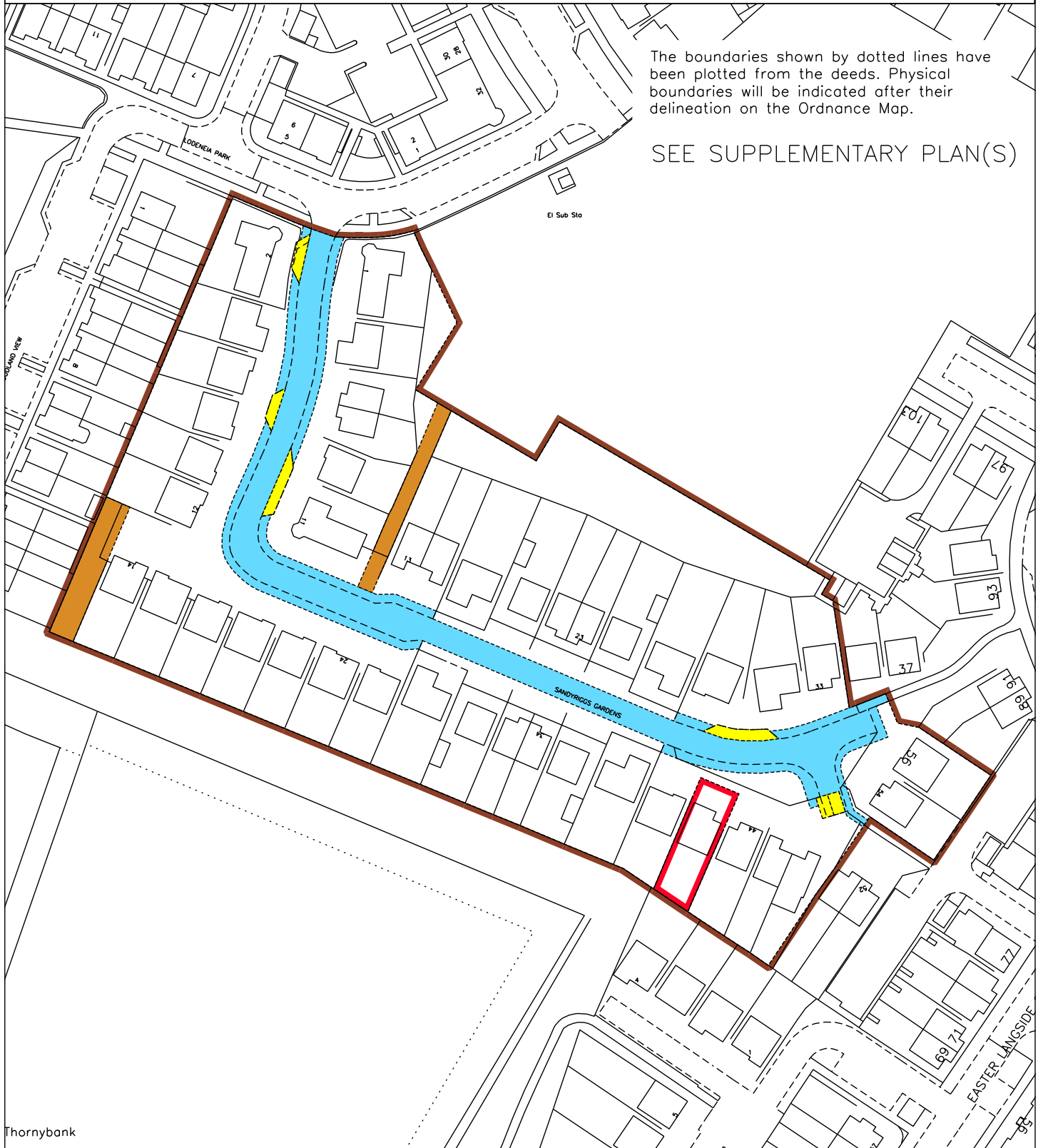

LAND REGISTER
OF SCOTLAND

Officer's ID/Date

6709
23/3/2017

Title Number

MID148764

SUPPLEMENTARY PLAN
TO THE TITLE PLAN

LEGEND

Red	RESERVATION	Yellow	GRAVEL LAND
Blue	ROAD	Green	WOODLAND
Light Blue	UNIMPROVED LAND (ROAD)	Light Green	WOODLAND
Light Purple	LAND UNDER LEASE	Dark Green	WOODLAND

NOTES:

1. NO MET SCALE
2. LAND TO BE DEMONSTRATED AS RESERVED ALONG THE EXTENT OF ROADWAY THAT FALLS SHORT OF RESERVATION BOUNDARIES ABOVE IS DETACHED TO BE PART OF THE RESERVATION LAND.



This is the Plan referred to in the foregoing HEAD OF RESERVATIONS AND CONDITIONS between THE LAMB DISTRICT and SHAW'S CONTRACTS (ROMANVILLE) LIMITED

Amended
C.O. Stewart
23/3/2017

NOTE: This copy is a reduction of the original plan.