

LAND REGISTER OF SCOTLAND	Officer's ID/Date	Title	Number
	6921 16/5/2018		MID199462

PLAN E This is the plan referred to in the foregoing Deed of Declaration of Conditions by Shawfair LLP and Others in respect of subjects South East Wedge, Edinburgh

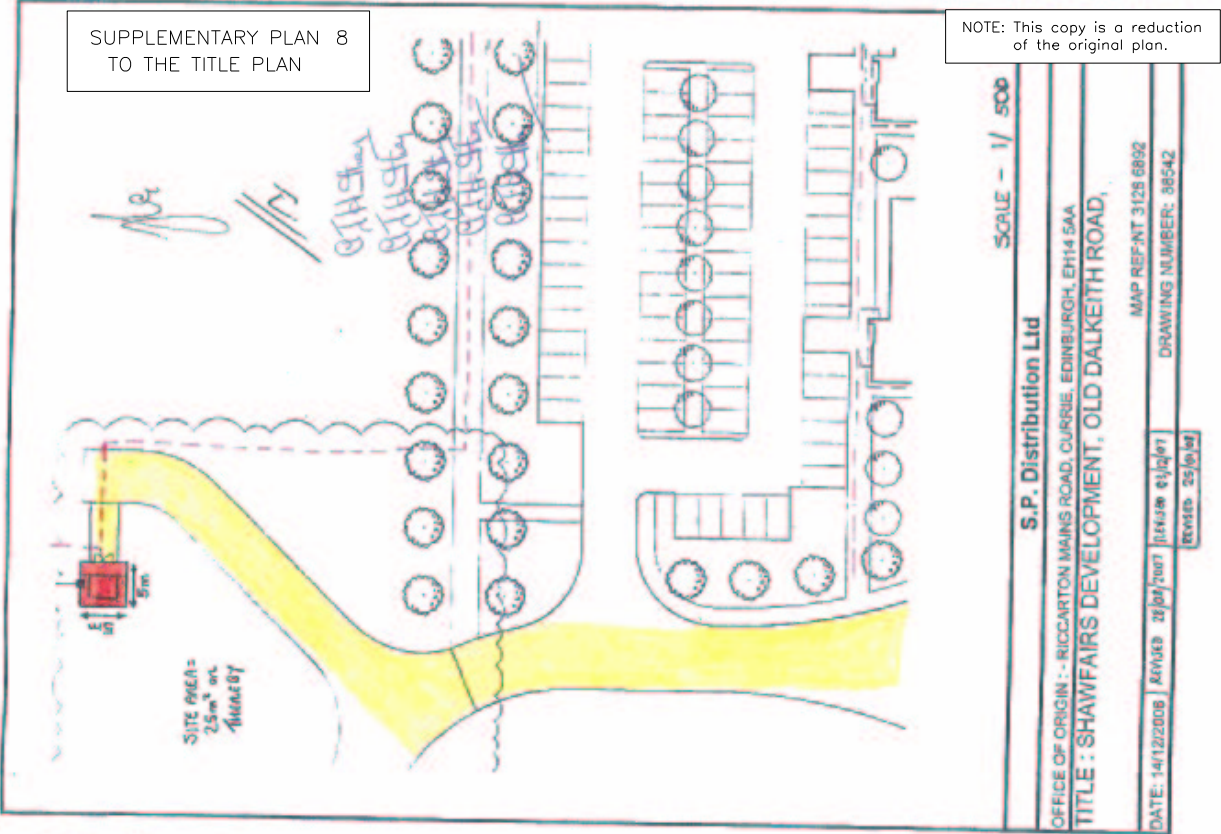

LAND REGISTER OF SCOTLAND	Officer's ID/Date	Title	Number
	6921 16/5/2018		MID199462

PLAN D This is the plan preferred to in the foregoing Deed of Declaration of Conditions by Shawfair LLP and Others in respect of subjects South East Wedge, Edinburgh

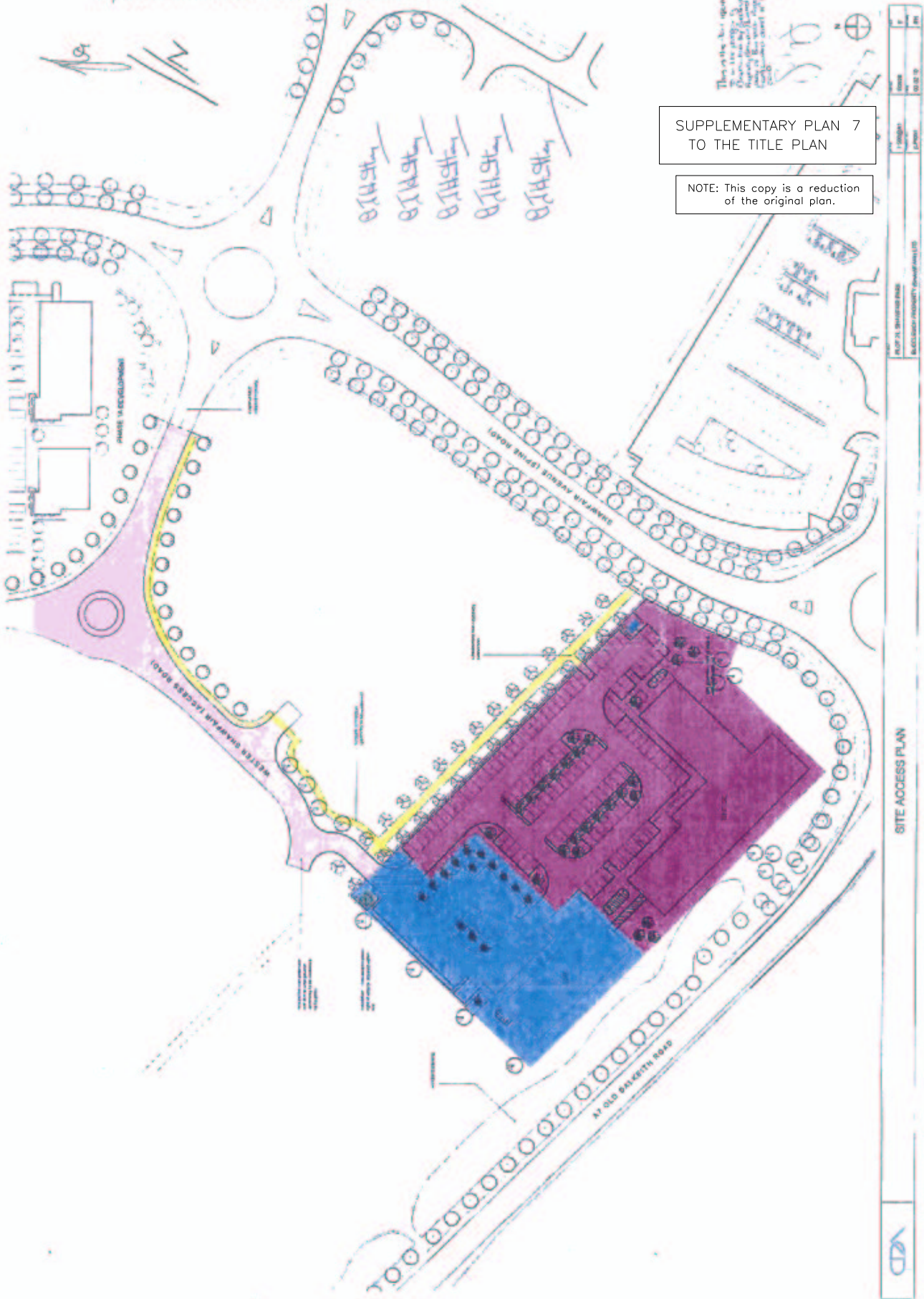

LAND REGISTER OF SCOTLAND	Officer's ID/Date	Title	Number
	6921 16/5/2018		MID199462

PLAN B This is the plan referred to in the foregoing Deed of Declaration of Conditions by Shawfair LLP and Others in respect of subjects South East Wedge, Edinburgh

NOTE: This copy is a reduction of the original plan.

SUPPLEMENTARY PLAN 5
TO THE TITLE PLAN

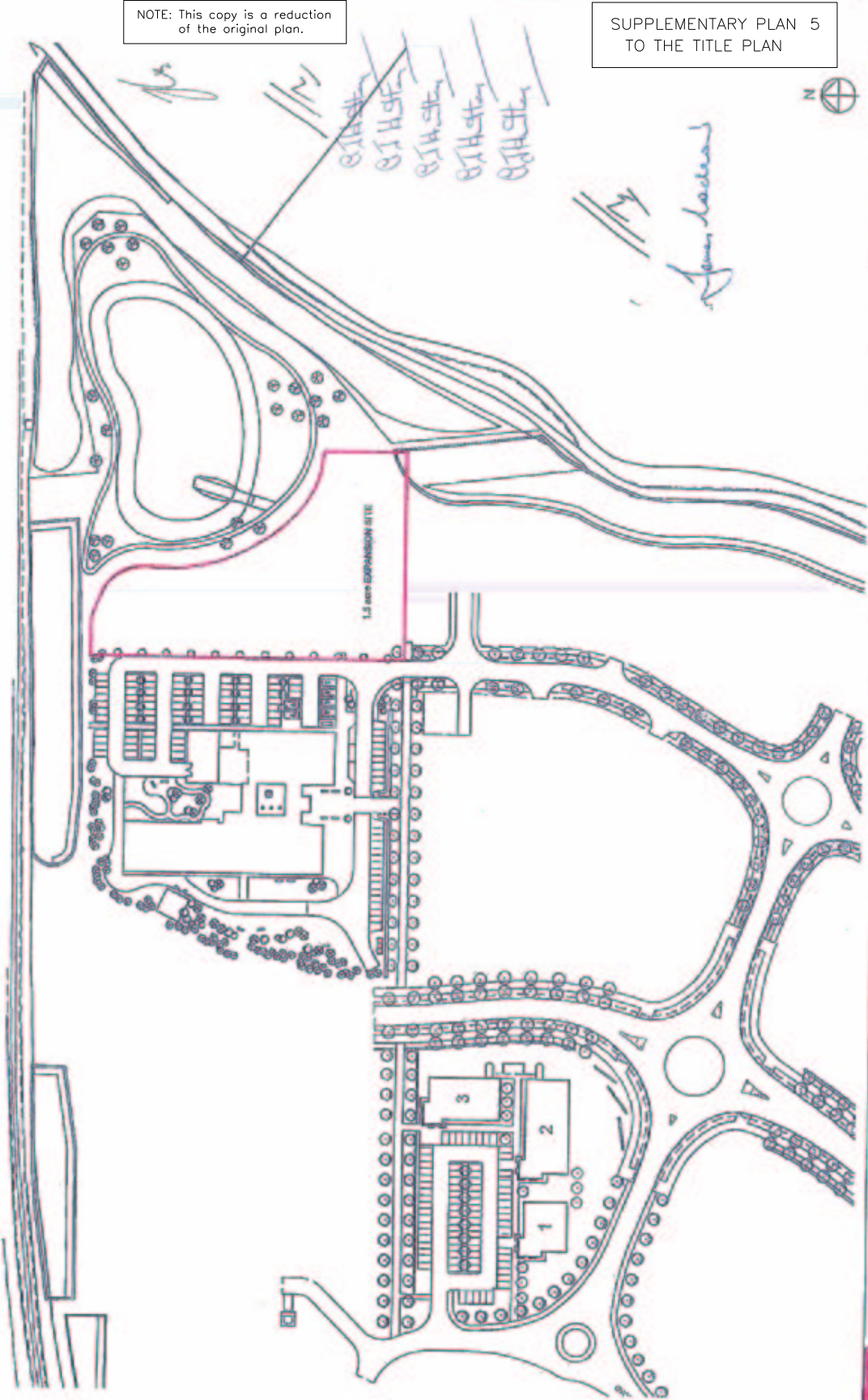

	SPIRE HOSPITAL, expansion site				
	project Spire Hospital, Shawfair Park, Edinburgh		plan no EI 164	rev (-)013	revision -
	client Buddleth Property	date 11.10.22	revision J5		
	description INFORMATION				

SPIRE HOSPITAL, expansion site



LAND REGISTER OF SCOTLAND	Officer's ID/Date	Title	Number
	6921 16/5/2018	MID199462	

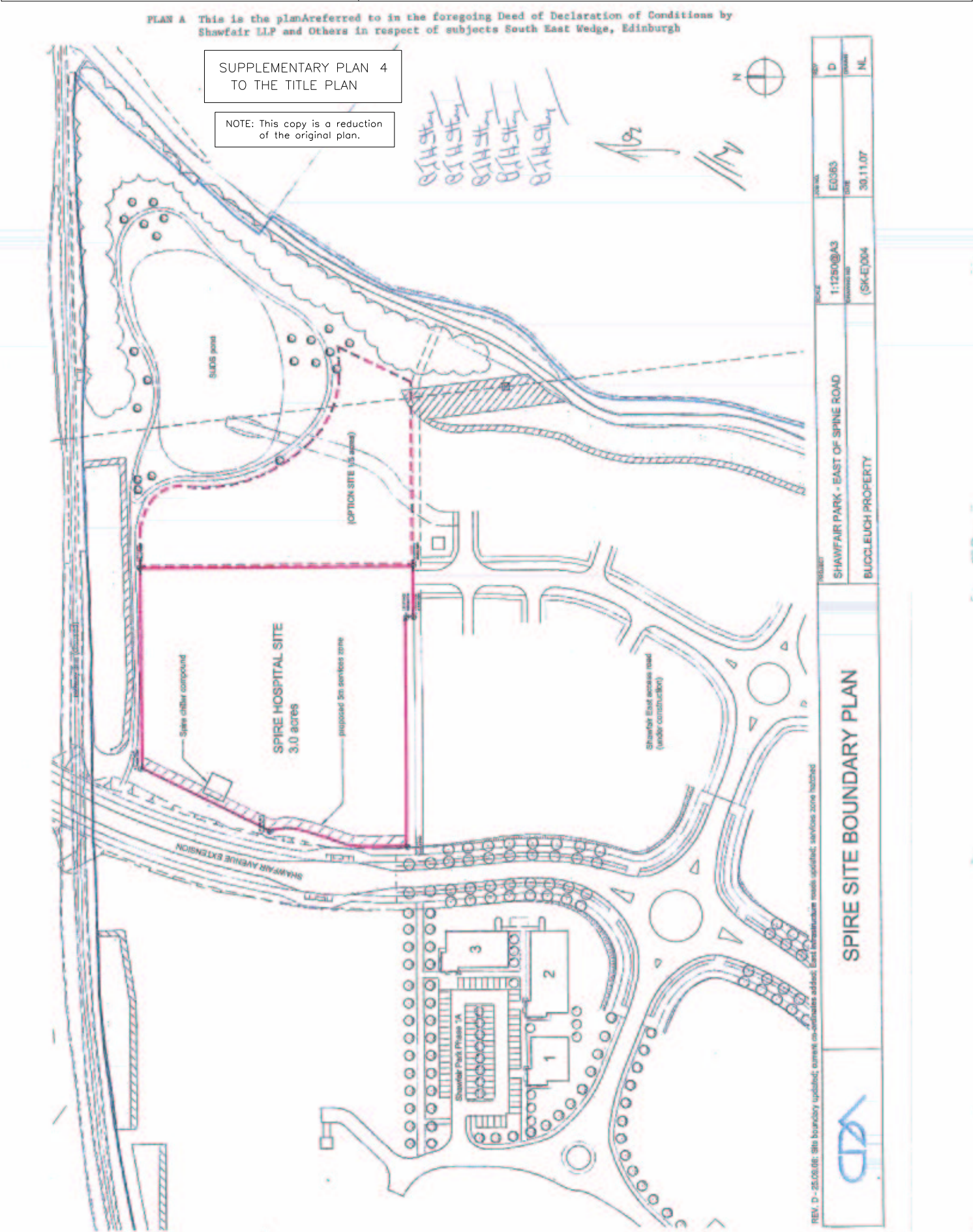

LAND REGISTER OF SCOTLAND	Officer's ID/Date	Title Number
	6921 16/5/2018	MID199462

This is the plan referred to in the foregoing Deed of Declaration of Conditions by Shawfair LLP and Buccleuch Property (Shawfair) Limited, in respect of subjects South East Wedge, Edinburgh

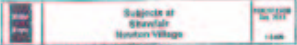

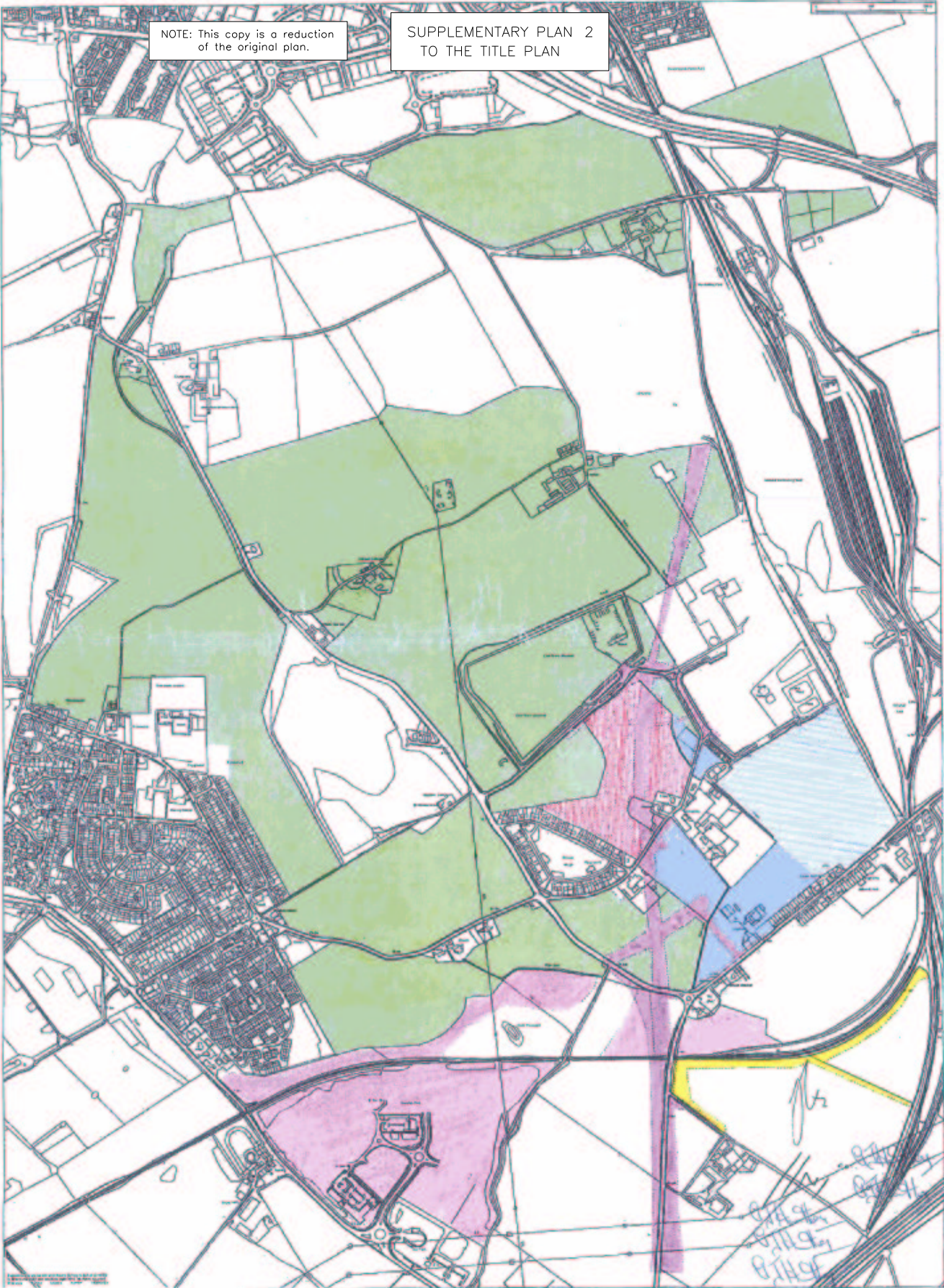

NOTE: This copy is a reduction of the original plan.

SUPPLEMENTARY PLAN 2
TO THE TITLE PLAN

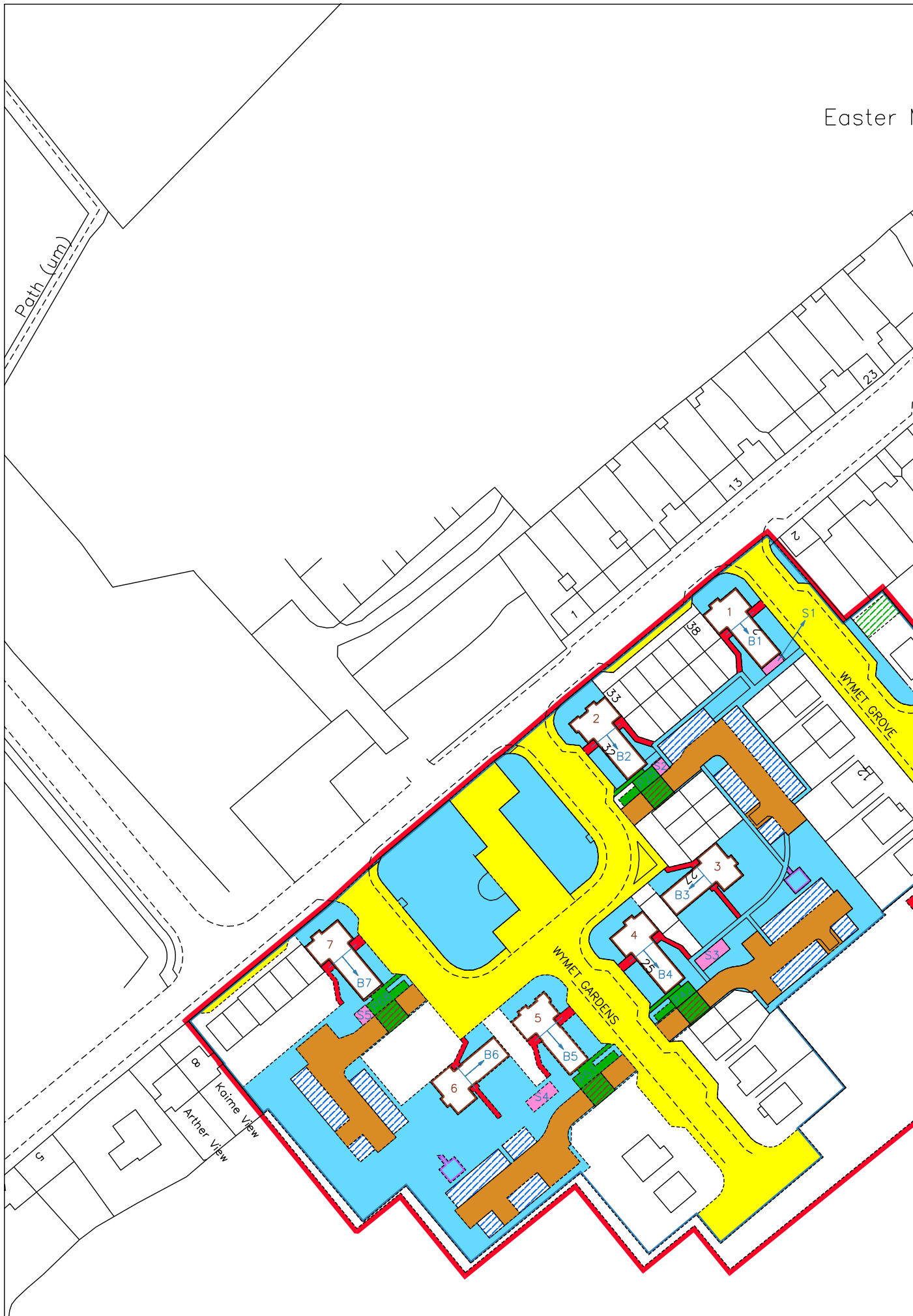



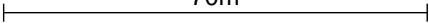

 LAND REGISTER OF SCOTLAND	Officer's ID / Date	Supplementary Plan to Title
	5995 15/3/2018	MID199462-1
	ORDNANCE SURVEY NATIONAL GRID REFERENCE	70m 
NT3269		Survey Scale
		1/2500

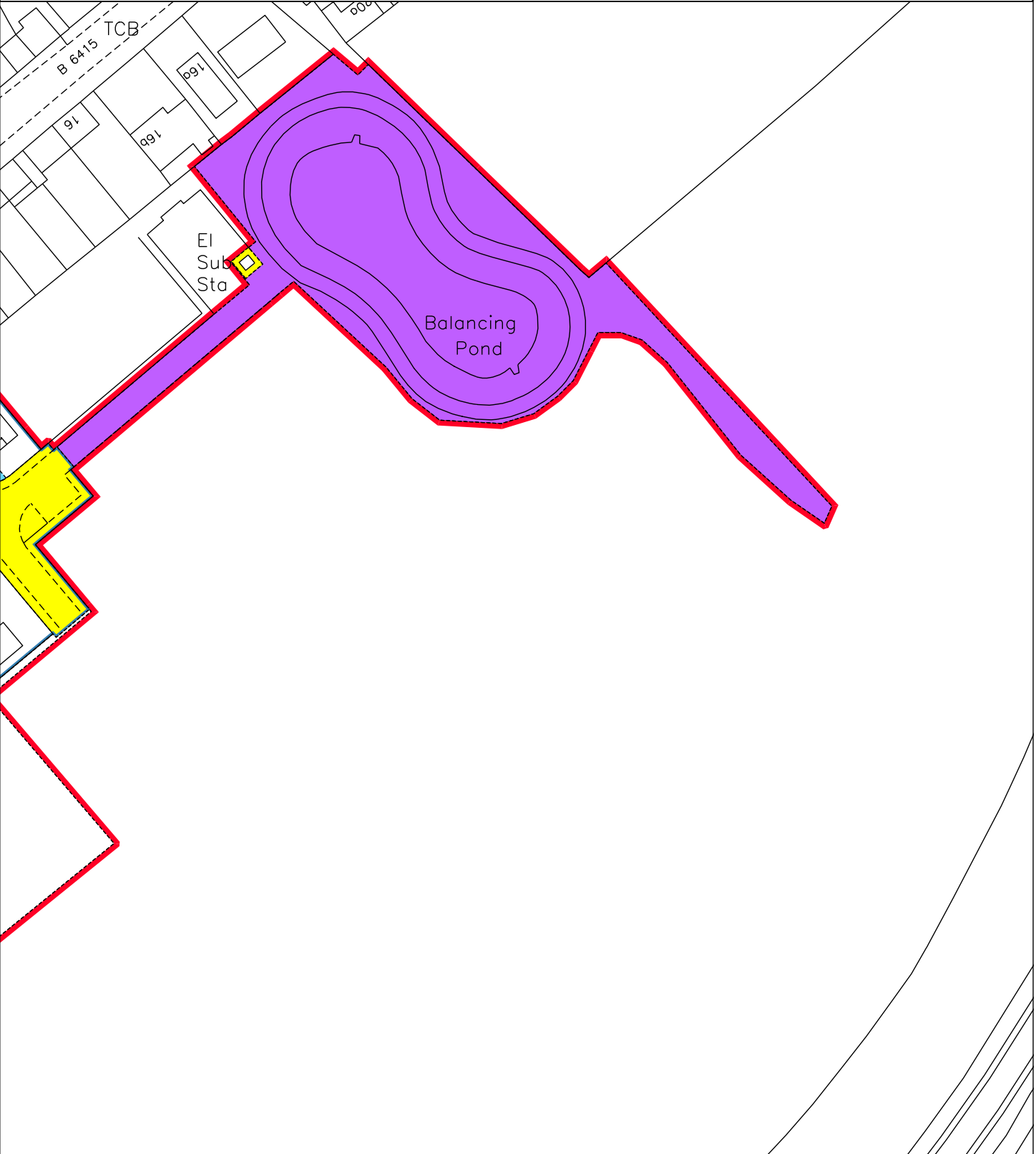
CROWN COPYRIGHT © – This copy has been produced from the ROS Digital Mapping System on 03/08/2021 with the authority of Ordnance Survey under Section 47 of the Copyright, Designs and Patents Act 1988. Unless there is a relevant exception to copyright, the copy must not be copied without the prior permission of the copyright owner. OS Licence no 100041182.



<div> LAND REGISTER OF SCOTLAND</div>	Officer's ID / Date	TITLE NUMBER
	6921 16/5/2018	MID199462
<div></div>	ORDNANCE SURVEY NATIONAL GRID REFERENCE	140m
NT3269		Survey Scale
		1/2500

CROWN COPYRIGHT © – This copy has been produced from the ROS Digital Mapping System on 03/08/2021 with the authority of Ordnance Survey under Section 47 of the Copyright, Designs and Patents Act 1988. Unless there is a relevant exception to copyright, the copy must not be copied without the prior permission of the copyright owner. OS Licence no 100041182.

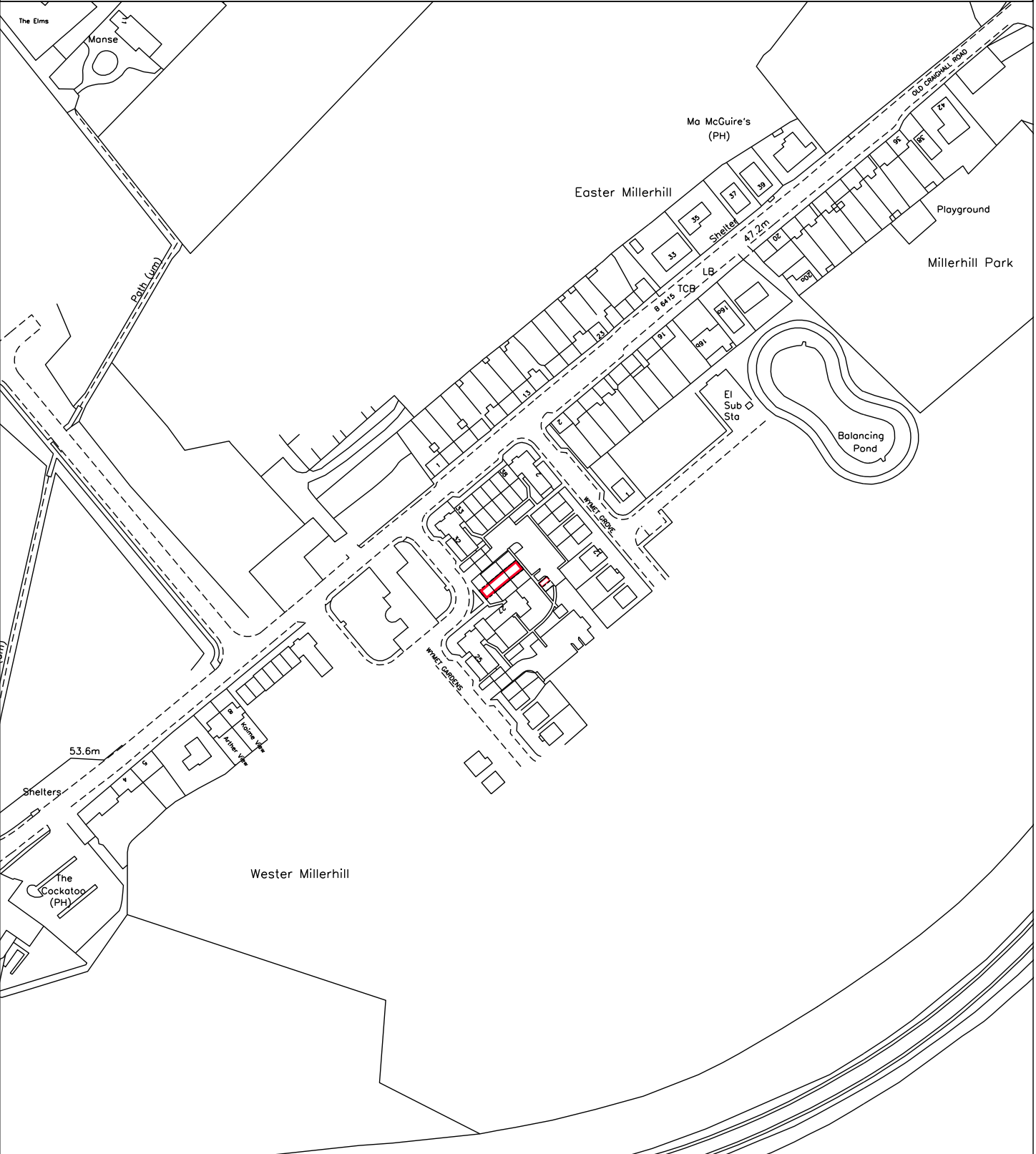

LAND REGISTER OF SCOTLAND	Officer's ID/Date	Title	Number
	6921 16/5/2018		MID199462

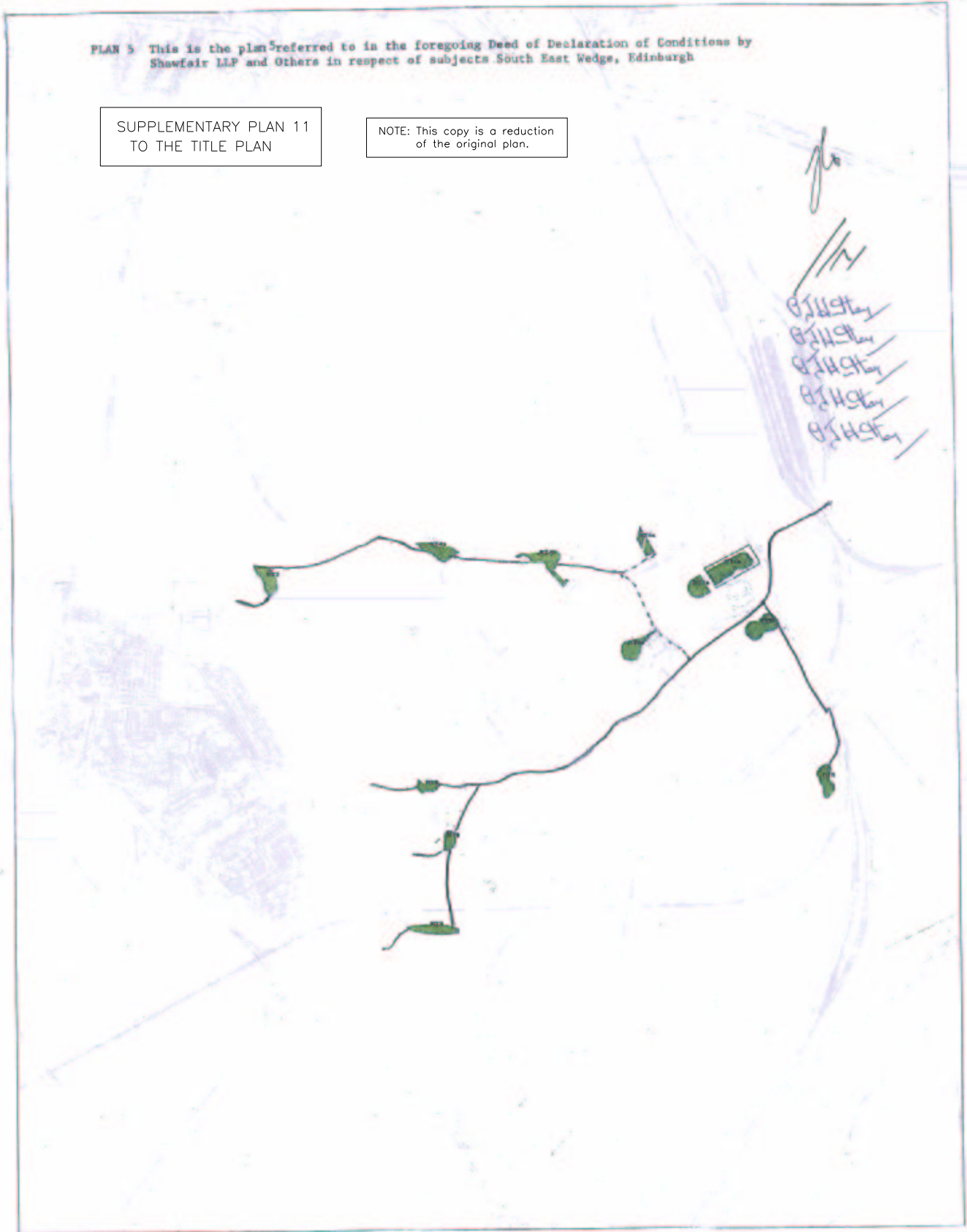

LAND REGISTER OF SCOTLAND	Officer's ID/Date	Title	Number
	6921 16/5/2018	MID199462	



LAND REGISTER OF SCOTLAND	Officer's ID/Date	Title	Number
	6921 16/5/2018		MID199462