 LAND REGISTER OF SCOTLAND	Officer's ID / Date	TITLE NUMBER
	5404 26/10/2012	ROX4237
	ORDNANCE SURVEY NATIONAL GRID REFERENCE	 140m
NT5441 NT5541 NT5641 NT5442		Survey Scale 1/2500
<small>CROWN COPYRIGHT © - This copy has been produced from the ROS Digital Mapping System on 27/10/2012 with the authority of Ordnance Survey under Section 47 of the Copyright, Designs and Patents Act 1988. Unless there is a relevant exception to copyright, the copy must not be copied without the prior permission of the copyright owner. OS Licence no 100041182.</small>		

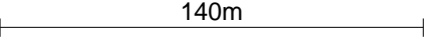

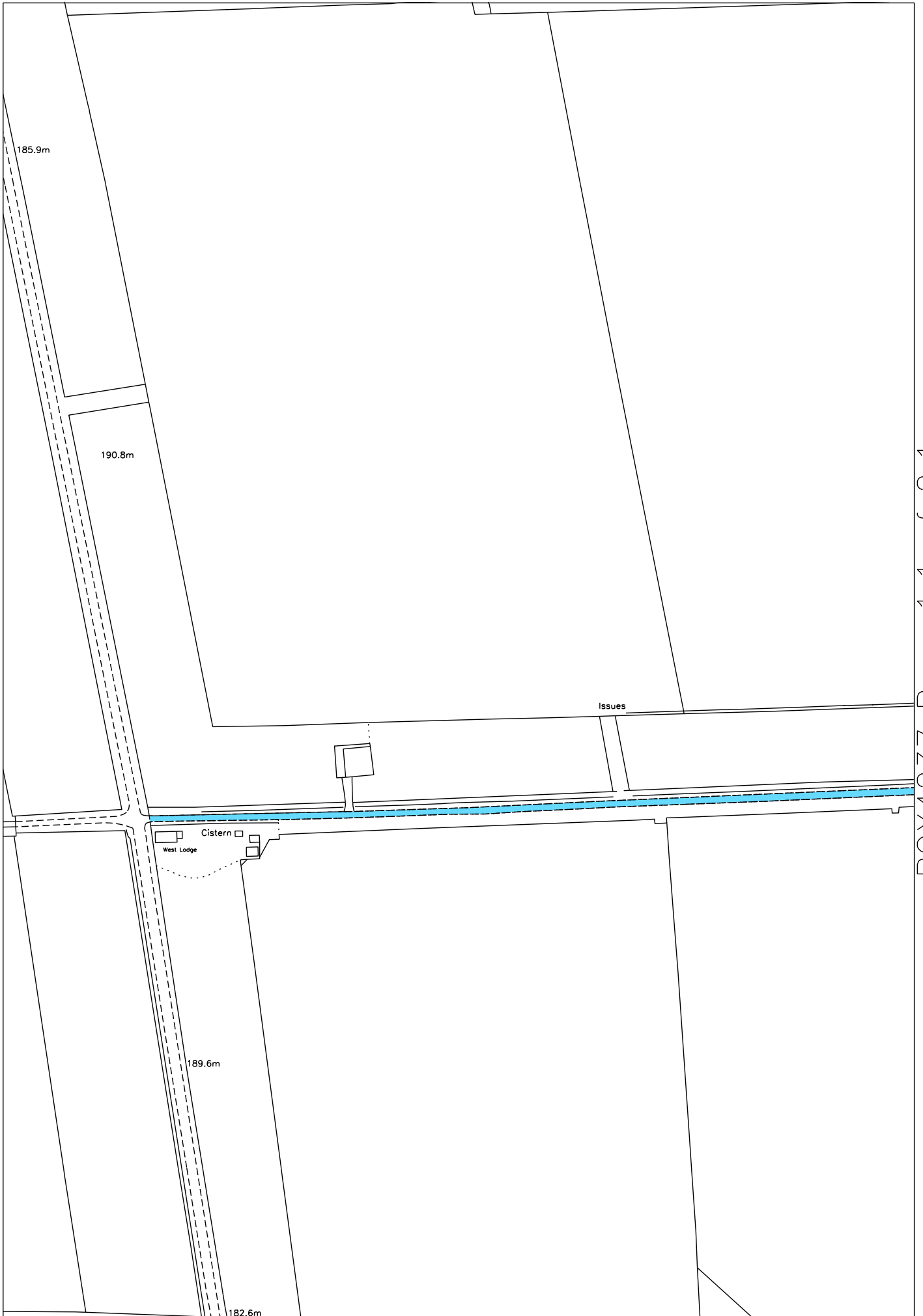



LAND REGISTER
OF SCOTLAND

Officer's ID / Date

5404
26/10/2012

TITLE NUMBER

ROX4237



ORDNANCE SURVEY
NATIONAL GRID REFERENCE

140m

NT5541 NT5641 NT5542 NT5642

Survey Scale

1/2500

CROWN COPYRIGHT © – This copy has been produced from the ROS Digital Mapping System on 27/10/2012 with the authority of Ordnance Survey under Section 47 of the Copyright, Designs and Patents Act 1988. Unless there is a relevant exception to copyright, the copy must not be copied without the prior permission of the copyright owner. OS Licence no 100041182.

The boundaries shown by dotted lines have been plotted from the deeds. Physical boundaries will be indicated after their delineation on the Ordnance Map.

