

LAND REGISTER OF SCOTLAND	Officer's ID/Date	Title Number
	4703 12/1/2012	MID126229

SUPPLEMENTARY PLAN 1
TO THE TITLE PLAN

NOTE: This copy is a reduction
of the original plan.



LAND REGISTER OF SCOTLAND	Officer's ID/Date	Title Number
	4703 12/1/2012	MID126229

Title	Number
-------	--------

MID126229

NOTE: This copy is a reduction of the original plan.

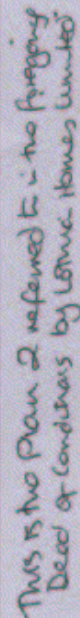

Plot 20A - TITLE PLAN - LEVEL 0
SCALE 1:400

1:400

LAND REGISTER OF SCOTLAND	Officer's ID/Date	Title Number
	4703 12/1/2012	MID126229

Title	Number
-------	--------



MID126229

NOTE: This copy is a reduction
of the original plan.

This is the Plan 3 referred to in the foregoing deed of conditions by Linn's Homeo limited

LA

At Sea

	Roof Common Pairs
	Roof Common Pairs

通

But, according to the EPA, the Agency is not required to consider any other factors in its decision-making process. The Agency is not required to consider any other factors in its decision-making process. The Agency is not required to consider any other factors in its decision-making process.

(3) H_A^2

Product	On delivery (sent only to those and not reply to) the main text
Date	
For Shading Contact Form	
Security	

FOR INFORMATION

CRUDEN HOMES (EAST) LTD.

REGIONAL DEVELOPMENT
PLAT 20 & 20A, NORTHEASTERN
QUARTER, SECTION 1

gilberts

LAND REGISTER OF SCOTLAND	Officer's ID/Date	Title Number
	4703 12/1/2012	MID126229

NOTE: This copy is a reduction of the original plan.

THIS is the Plan I referred to in the foregoing
Deed of Conveyance by John A. Horner et al.

Dr. J. H. Stiles



Plot 20A - TITLE PLAN - ROOF
SCALE 1:400

[illegible]

(Plants)

			
Black	Black	Black	Black

00090946	Many don't like to see our way of the plan
NAME	For Building Control Bureau
ADDRESS	10000000
City	

FOR INFORMATION

CRUDEN HOMES (EAST) LTD

RESIDENTIAL DEVELOPMENT
PLOT 20 & 20A, FORTHQUARRTER
GRANTON, EDINBURGH

PLDT 20A
TITLE PLATE
ROOF

gilberts

LAND REGISTER OF SCOTLAND	Officer's ID/Date	Title Number
	4703 12/1/2012	MID126229

NOTE: This copy is a reduction
of the original plan.

This architectural floor plan shows a building layout with a central corridor. The plan includes several rooms, some of which are labeled with letters (A, B, C, D, E, F, G, H, I, J, K, L, M, N, O, P, Q, R, S, T, U, V, W, X, Y, Z) and numbers (1, 2, 3, 4, 5, 6, 7, 8, 9, 10, 11, 12, 13, 14, 15, 16, 17, 18, 19, 20, 21, 22, 23, 24, 25, 26, 27, 28, 29, 30, 31, 32, 33, 34, 35, 36, 37, 38, 39, 40, 41, 42, 43, 44, 45, 46, 47, 48, 49, 50, 51, 52, 53, 54, 55, 56, 57, 58, 59, 60, 61, 62, 63, 64, 65, 66, 67, 68, 69, 70, 71, 72, 73, 74, 75, 76, 77, 78, 79, 80, 81, 82, 83, 84, 85, 86, 87, 88, 89, 90, 91, 92, 93, 94, 95, 96, 97, 98, 99, 100). The plan also shows a central corridor and various rooms, including a large room labeled 'A' at the top, a room labeled 'B' on the left, and a room labeled 'C' on the right. The plan is detailed with architectural symbols and dimensions.

The proposed 1000-ft-tall seawall and impound the property of other respondents. The respondents claim that the proposed seawall would not only displace the respondents' property but also displace the respondents' businesses. The respondents claim that the proposed seawall would not only displace the respondents' property but also displace the respondents' businesses. The respondents claim that the proposed seawall would not only displace the respondents' property but also displace the respondents' businesses.

5. 26.12.2017 Meeting attended to add about comments of 24 March 2008
6. 26.12.2017 Meeting with Dr. V. S. Srinivasan, General Secy, IIT Madras, Madras
7. 26.12.2017 Meeting attended to add about comments of 18 March 2009
8. 26.12.2017 Meeting attended to add about comments of meeting of 18 February 2008
9. 12.10.2018 Dr. Ding (Attended)

RESIDENTIAL DEVELOPMENT
PLOT 20, FORTHQUARTER
GRANTON EDINBURGH

PLOT 20
 TITLE PLAN
 BASEMENT

gibberts

LAND REGISTER OF SCOTLAND	Officer's ID/Date	Title Number
	4703 12/1/2012	MID126229

SUPPLEMENTARY PLAN 3
TO THE TITLE PLAN

NOTE: This copy is a reduction
of the original plan.

THIS IS PLAN 2 REFERRED TO IN
THE FOREGOING DISPOSITION BY
PORT GREENWICH LIMITED IN FAVOUR
OF WEST GRANTON HOUSING
CO-OPERATIVE LIMITED

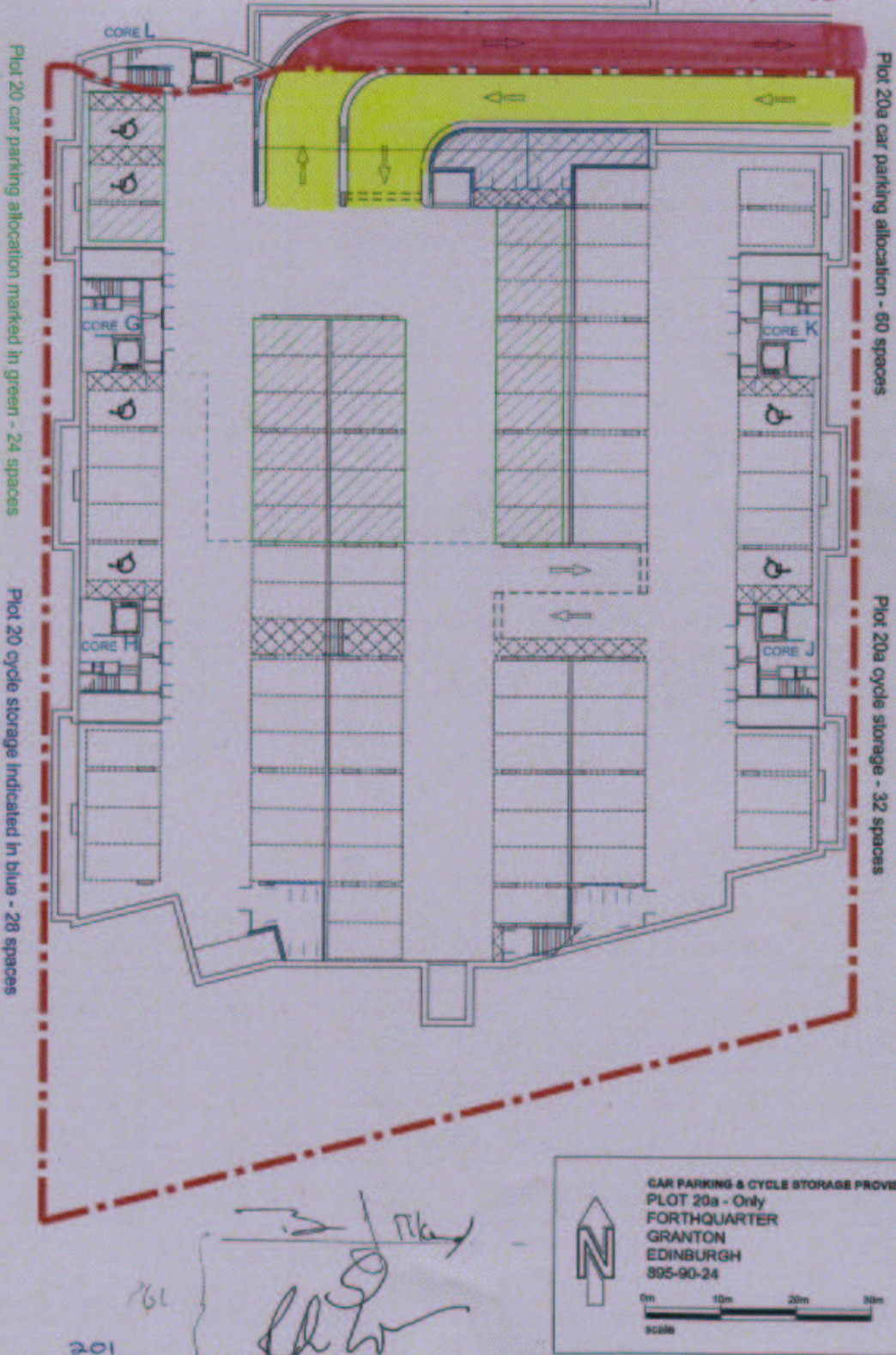

LAND REGISTER OF SCOTLAND

Officer's ID/Date

4703
12/1/2012

Title Number

MID126229

SUPPLEMENTARY PLAN 2 TO THE TITLE PLAN

NOTE: This copy is a reduction
of the original plan.

*This is Plan 1 referred to
in the Planning Department
by 101 Edinburgh Limited
in favour of 101 Edinburgh
Limited*



AREA SUMMARY (acres / hectares)	
1. PLOT 18	1.55 acres / 0.6 ha or thereby
2. PLOT 19	1.48 acres / 0.6 ha or thereby
3. PLOT 20A	1.19 acres / 0.48 ha or thereby
4. PLOT 20B	1.14 acres / 0.48 ha or thereby

Note: Site Grid Coordinates/National Grid
- Eastings Prefixed by 52 and Northings Prefixed by 67
(National Grid Ref: NT 2276)
This drawing has been prepared utilising information
obtained from OS Drawing of the site and other
topographical information of the existing site

BOUNDARY UPDATED		REMARKS	
Date	By	Date	By

RESIDENTIAL PLOTS 18, 19, 20A & 20B
TITLE PLAN
A007-BS 3103 CS 165



GRANTON DEVELOPMENT

NATIONAL GRID PROPERTY HOLDINGS LTD



2nd Floor
71 Congreave Road
Skelton
S10 8ST

Consulting Engineers

<div></div> <div>LAND REGISTER OF SCOTLAND</div>		Officer's ID / Date	TITLE NUMBER
		4703 12/1/2012	MID126229
<div></div>	ORDNANCE SURVEY NATIONAL GRID REFERENCE		<div><div></div><div>70m</div><div></div></div>
NT2176SE NT2176NE			Survey Scale
			1/1250

CROWN COPYRIGHT © – This copy has been produced from the ROS Digital Mapping System on 30/03/2021 with the authority of Ordnance Survey under Section 47 of the Copyright, Designs and Patents Act 1988. Unless there is a relevant exception to copyright, the copy must not be copied without the prior permission of the copyright owner. OS Licence no 100041182.

