 <b>LAND REGISTER OF SCOTLAND</b>	Officer's ID / Date	TITLE NUMBER
	3305 10/11/2006	<b>INV5377</b>
 <b>ORDNANCE SURVEY NATIONAL GRID REFERENCE</b>	140m	
	Survey Scale	
NH7746 NH7846 NH7946 NH7747		1/2500
<small>CROWN COPYRIGHT © - This copy has been produced from the ROS Digital Mapping System on 01/02/2008 and was made with the authority of Ordnance Survey pursuant to Section 47 of the Copyright, Designs and Patents Act 1988. Unless that act provides a relevant exception to copyright, the copy must not be copied without the prior permission of the copyright owner.</small>		

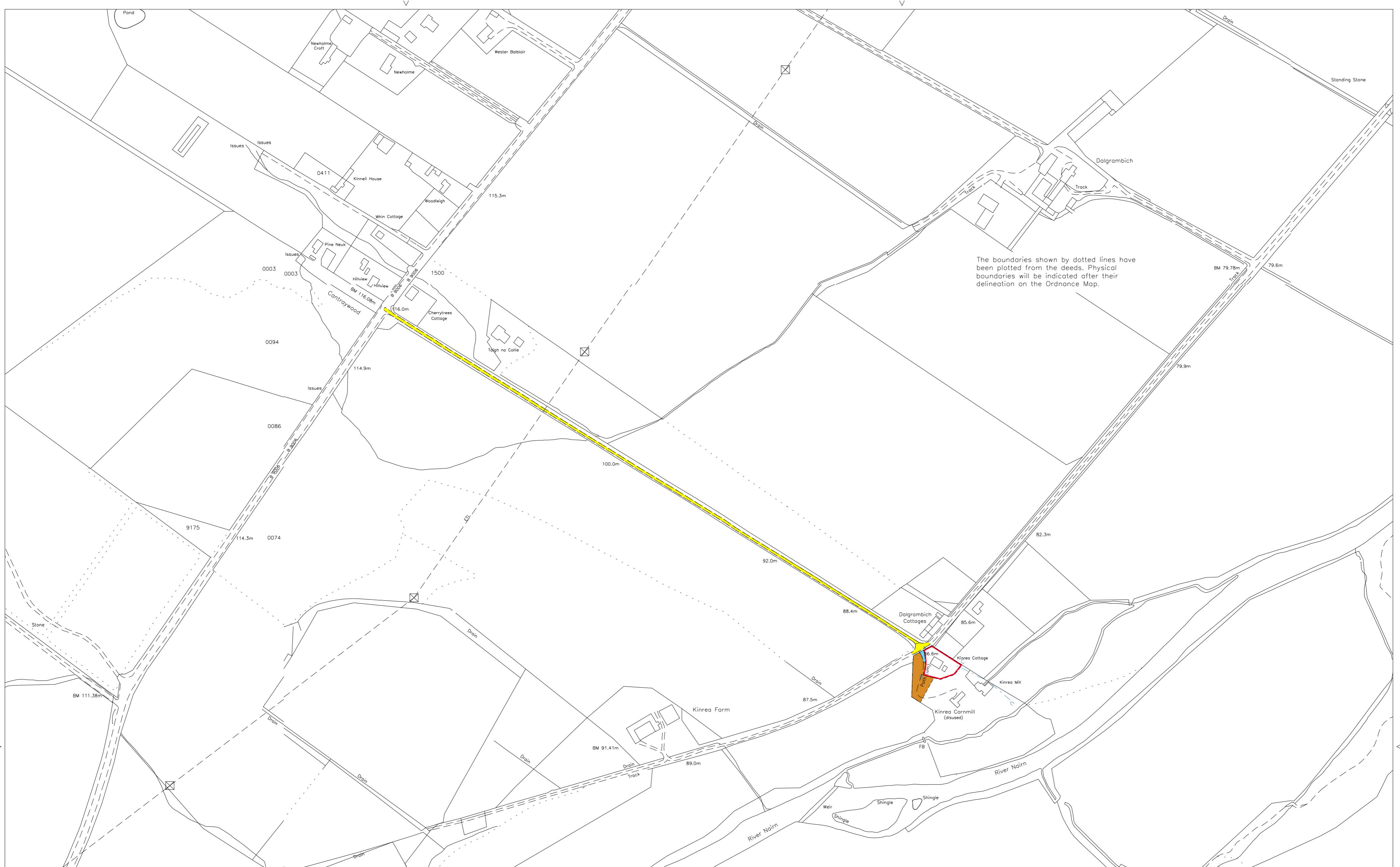

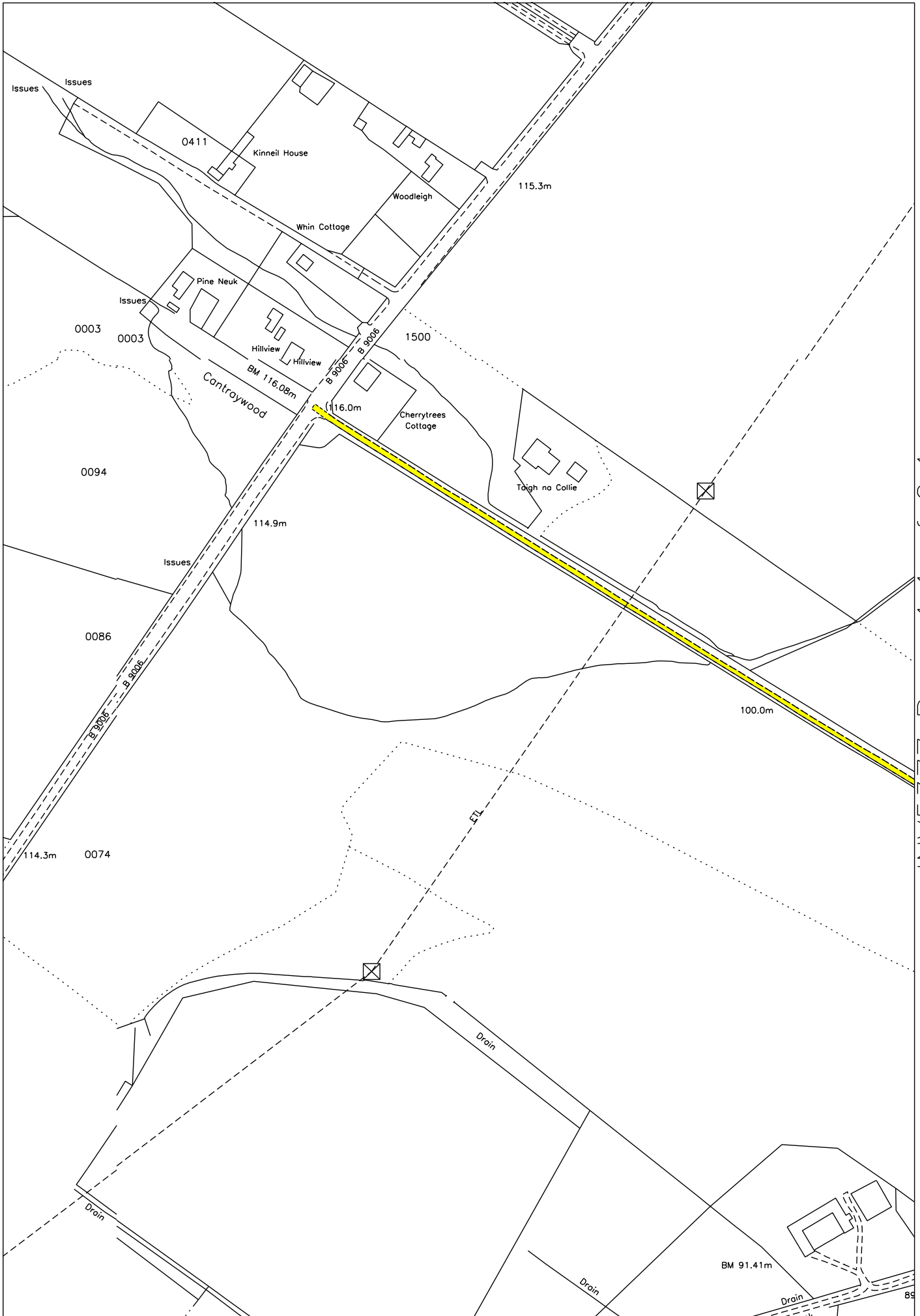



LAND REGISTER  
OF SCOTLAND

Officer's ID / Date

3305  
10/11/2006

TITLE NUMBER

**INV5377**



ORDNANCE SURVEY  
NATIONAL GRID REFERENCE

140m

NH7746 NH7846 NH7747 NH7847

Survey Scale

1/2500

CROWN COPYRIGHT © – This copy has been produced from the ROS Digital Mapping System on 01/02/2008 and was made with the authority of Ordnance Survey pursuant to Section 47 of the Copyright, Designs and Patents Act 1988. Unless that act provides a relevant exception to copyright, the copy must not be copied without the prior permission of the copyright owner.

The boundaries shown by dotted lines have been plotted from the deeds. Physical boundaries will be indicated after their delineation on the Ordnance Map.

