



LAND REGISTER
OF SCOTLAND

Officer's ID / Date

6820
10/3/2017

Supplementary Plan to Title

MID174861-1



ORDNANCE SURVEY
NATIONAL GRID REFERENCE

70m

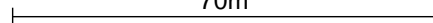

NT2275NE NT2375NW NT2276SE NT2376SW

Survey Scale

1/1250

CROWN COPYRIGHT © – This copy has been produced from the ROS Digital Mapping System on 21/02/2018 with the authority of Ordnance Survey under Section 47 of the Copyright, Designs and Patents Act 1988. Unless there is a relevant exception to copyright, the copy must not be copied without the prior permission of the copyright owner. OS Licence no 100041182.

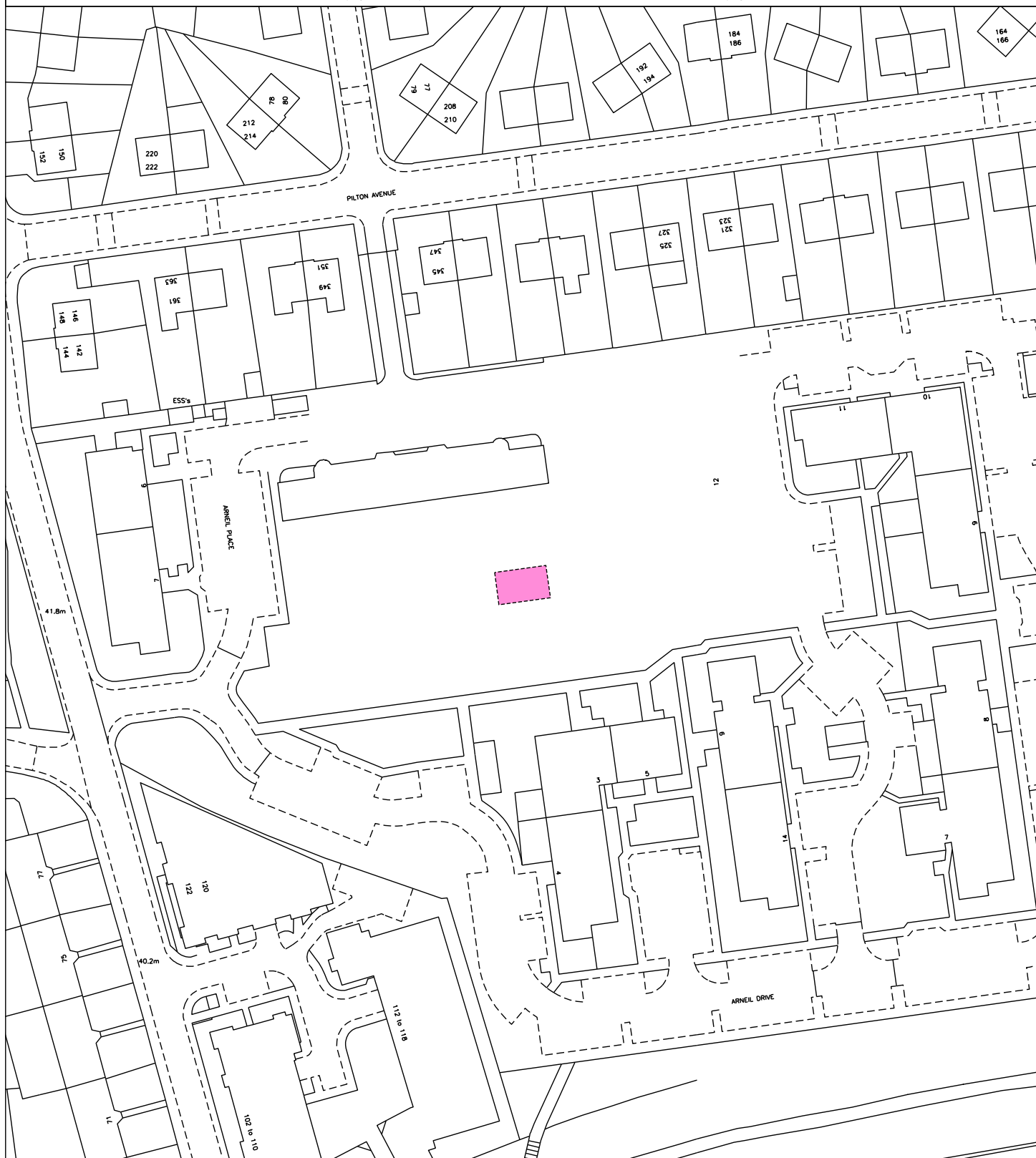

LAND REGISTER OF SCOTLAND

Officer's ID/Date

3569
20/2/2018

Title Number

MID174861

NOTE: This copy is a reduction of the original plan.

Drawn: 1:38 and 1:105

Q.E. Ref: 2018/174861

Relaxed: 2018/174861

Project Number: 2018/174861

Revision: 1:38 and 1:105

Drawn by: M. J. M. (M.J.M.)

Checked by: M. J. M. (M.J.M.)

1. Electrical layout of power network in the

2. Electrical layout of power network in the

3. Electrical layout of power network in the

4. Electrical layout of power network in the

5. Electrical layout of power network in the

6. Electrical layout of power network in the

7. Electrical layout of power network in the

8. Electrical layout of power network in the

9. Electrical layout of power network in the

10. Electrical layout of power network in the

11. Electrical layout of power network in the

12. Electrical layout of power network in the

13. Electrical layout of power network in the

14. Electrical layout of power network in the

15. Electrical layout of power network in the

16. Electrical layout of power network in the

17. Electrical layout of power network in the

18. Electrical layout of power network in the

19. Electrical layout of power network in the

20. Electrical layout of power network in the

21. Electrical layout of power network in the

22. Electrical layout of power network in the

23. Electrical layout of power network in the

24. Electrical layout of power network in the

25. Electrical layout of power network in the

26. Electrical layout of power network in the

27. Electrical layout of power network in the

28. Electrical layout of power network in the

29. Electrical layout of power network in the

30. Electrical layout of power network in the

31. Electrical layout of power network in the

32. Electrical layout of power network in the

33. Electrical layout of power network in the

34. Electrical layout of power network in the

35. Electrical layout of power network in the

36. Electrical layout of power network in the

37. Electrical layout of power network in the

38. Electrical layout of power network in the

39. Electrical layout of power network in the

40. Electrical layout of power network in the

41. Electrical layout of power network in the

42. Electrical layout of power network in the

43. Electrical layout of power network in the

44. Electrical layout of power network in the

45. Electrical layout of power network in the

46. Electrical layout of power network in the

47. Electrical layout of power network in the

48. Electrical layout of power network in the

49. Electrical layout of power network in the

50. Electrical layout of power network in the

51. Electrical layout of power network in the

52. Electrical layout of power network in the

53. Electrical layout of power network in the

54. Electrical layout of power network in the

55. Electrical layout of power network in the

56. Electrical layout of power network in the

57. Electrical layout of power network in the

58. Electrical layout of power network in the

59. Electrical layout of power network in the

60. Electrical layout of power network in the

61. Electrical layout of power network in the

62. Electrical layout of power network in the

63. Electrical layout of power network in the

64. Electrical layout of power network in the

65. Electrical layout of power network in the

66. Electrical layout of power network in the

67. Electrical layout of power network in the

68. Electrical layout of power network in the

69. Electrical layout of power network in the

70. Electrical layout of power network in the

71. Electrical layout of power network in the

72. Electrical layout of power network in the

73. Electrical layout of power network in the

74. Electrical layout of power network in the

75. Electrical layout of power network in the

76. Electrical layout of power network in the

77. Electrical layout of power network in the

78. Electrical layout of power network in the

79. Electrical layout of power network in the

80. Electrical layout of power network in the

81. Electrical layout of power network in the

82. Electrical layout of power network in the

83. Electrical layout of power network in the

84. Electrical layout of power network in the

85. Electrical layout of power network in the

86. Electrical layout of power network in the

87. Electrical layout of power network in the

88. Electrical layout of power network in the

89. Electrical layout of power network in the

90. Electrical layout of power network in the

91. Electrical layout of power network in the

92. Electrical layout of power network in the

93. Electrical layout of power network in the

94. Electrical layout of power network in the

95. Electrical layout of power network in the

96. Electrical layout of power network in the

97. Electrical layout of power network in the

98. Electrical layout of power network in the

99. Electrical layout of power network in the

100. Electrical layout of power network in the

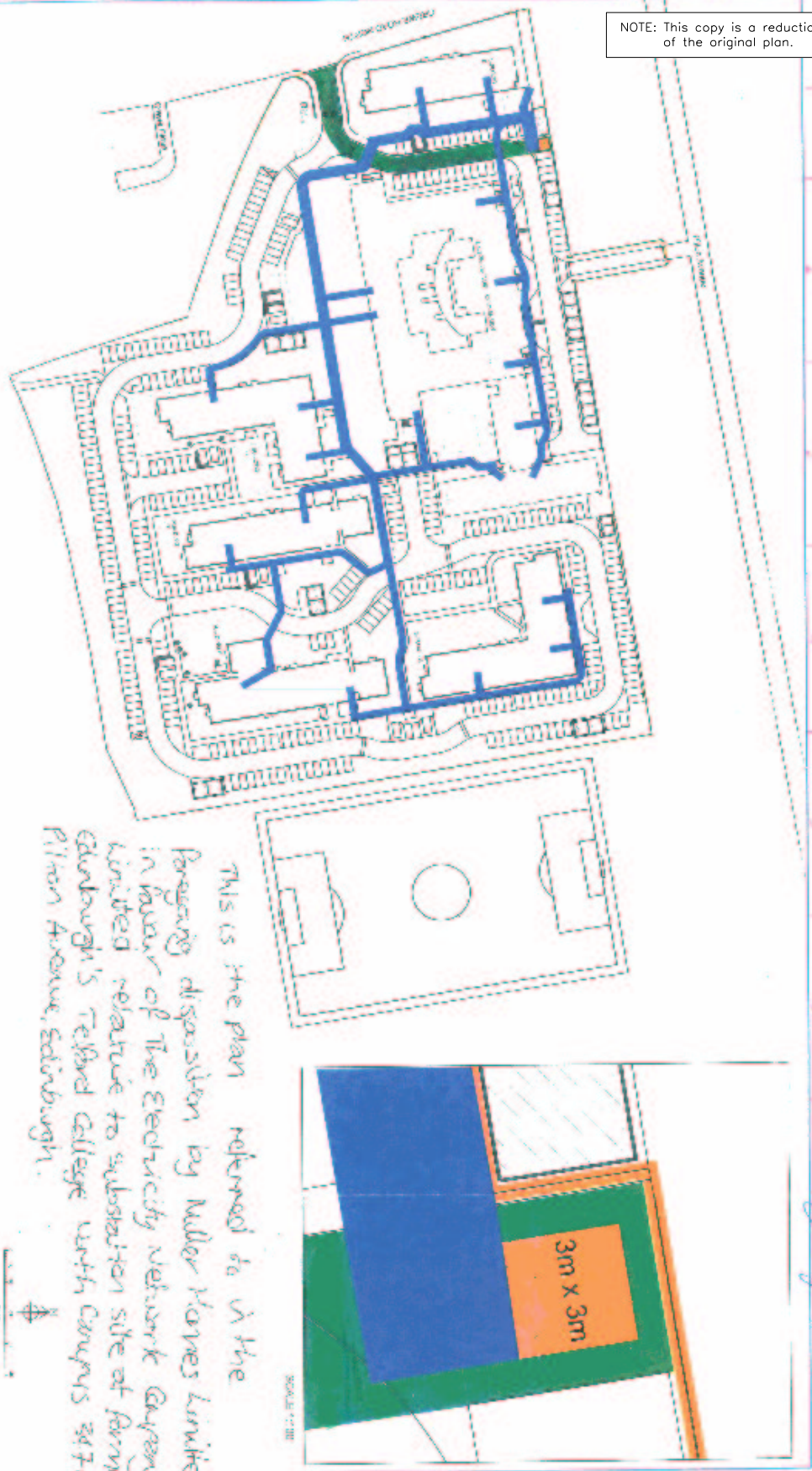

[Handwritten signature]

SUPPLEMENTARY PLAN 2 TO THE TITLE PLAN

LAND REGISTER
OF SCOTLAND

Officer's ID/Date

3569
20/2/2018

Title

Number

MID174861

NOTE: This copy is a reduction of the original plan.

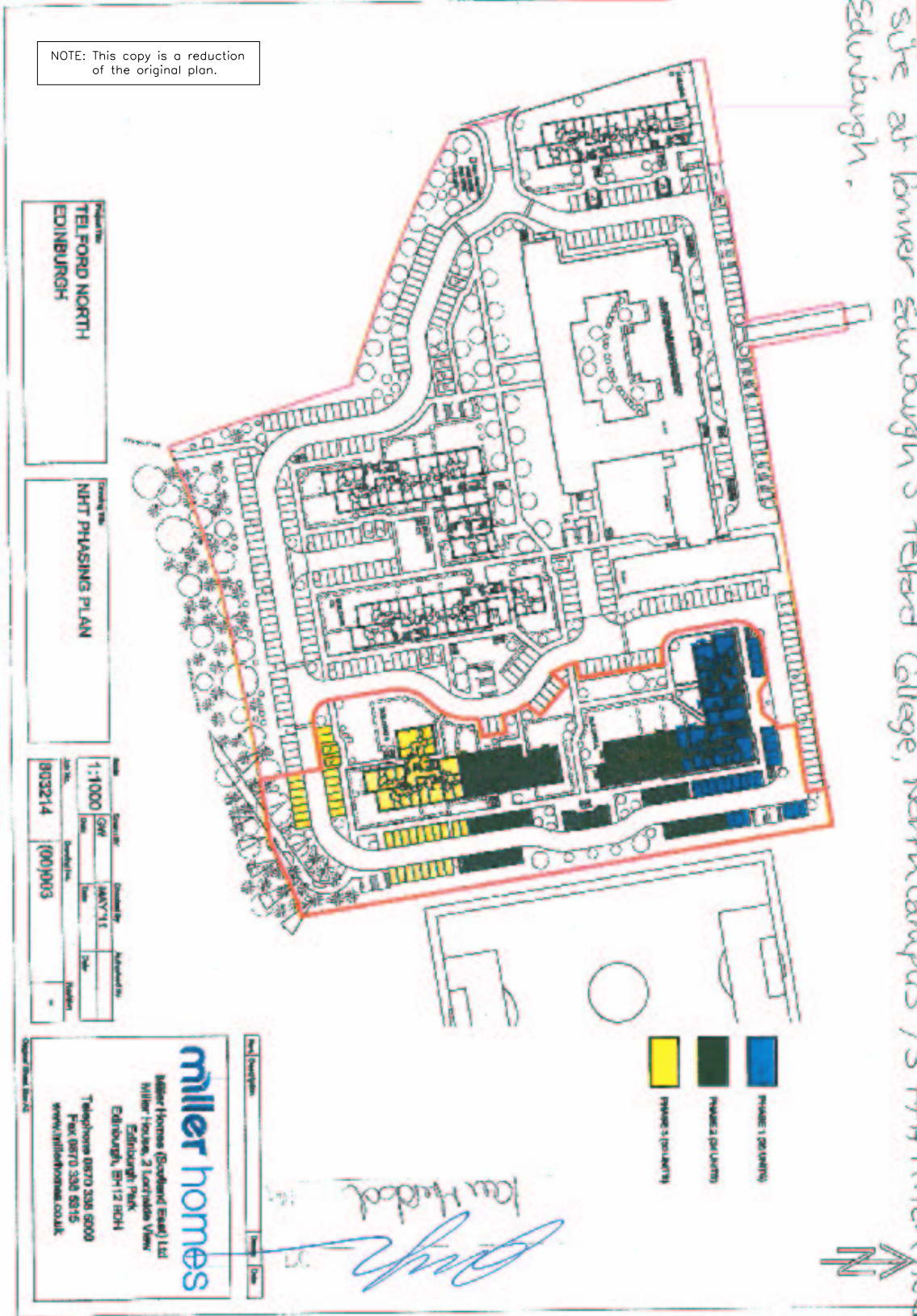

This is Plan 2 referred to in the foregoing disposition by Miller Homes Limited in favour of The Electricity Network Company Limited relative to substation site at former Edinburgh's Telford College, North campus, 377A Pitten Avenue Edinburgh.

Plot No.
TEL FORD NORTH
EDINBURGH

Control No.
NHT PHASING PLAN

Scale
1:1000
Date
03/02/14
Author
GWS
Checked by
JAW/TJ
Date
09/03/03

miller homes
Miller Homes (Scotland) Ltd
Miller House, 2 Lockriss View
Edinburgh, EH12 6CH
Telephone 0870 336 6000
Fax 0870 336 6315
www.millerhomes.co.uk



This is the plan referred to
in the foregoing Framework Deed of
Real Burdens and grant of Servitude
Rights by Miller Homes Limited

(Handwritten signature)

A BUILDING A & BUILDING B BOUNDARIES REMOVED
GW 30.08.11

Rev.	Description	Drawn	Date
------	-------------	-------	------

miller-homes

Miller Homes (Scotland East) Ltd
Miller House, 2 Lochside View
Edinburgh Park
Edinburgh, EH12 9DH

Telephone 0870 336 5000
Fax 0870 338 5315
www.millerhomes.co.uk

Scale	Drawn By	Checked By	Authorised By
1:1000	GW	JULY '11	
	Date	Date	Date

Job No.	Drawing No.	Revision
803214	(00)005	A

PLAN

LAND REGISTER
OF SCOTLAND

Officer's ID/Date

3569
20/2/2018

Title Number

MID174861

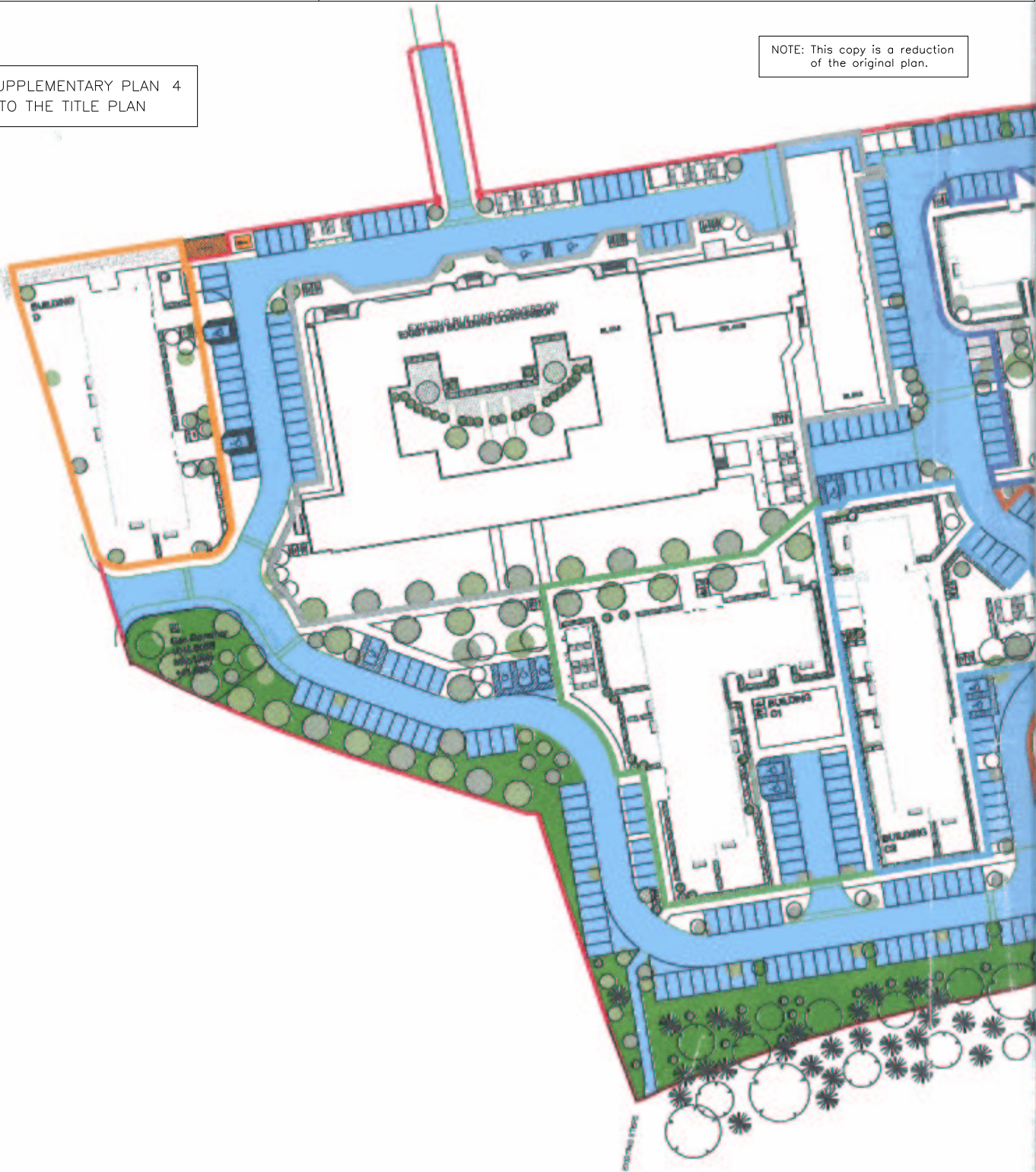

SUPPLEMENTARY PLAN 4
TO THE TITLE PLAN

NOTE: This copy is a reduction
of the original plan.



Project Title
**TELFORD NORTH
EDINBURGH**

Drawing Title
**TELFORD NORTH
OVERARCHING
DEED OF CONDITIONS PLAN**

 LAND REGISTER OF SCOTLAND	Officer's ID / Date	TITLE NUMBER
	3569 20/2/2018	MID174861
 ORDNANCE SURVEY NATIONAL GRID REFERENCE	70m	
	Survey Scale	
NT2275NE NT2375NW NT2276SE NT2376SW	1/1250	
<small>CROWN COPYRIGHT © - This copy has been produced from the ROS Digital Mapping System on 21/02/2018 with the authority of Ordnance Survey under Section 47 of the Copyright, Designs and Patents Act 1988. Unless there is a relevant exception to copyright, the copy must not be copied without the prior permission of the copyright owner. OS Licence no 100041182.</small>		

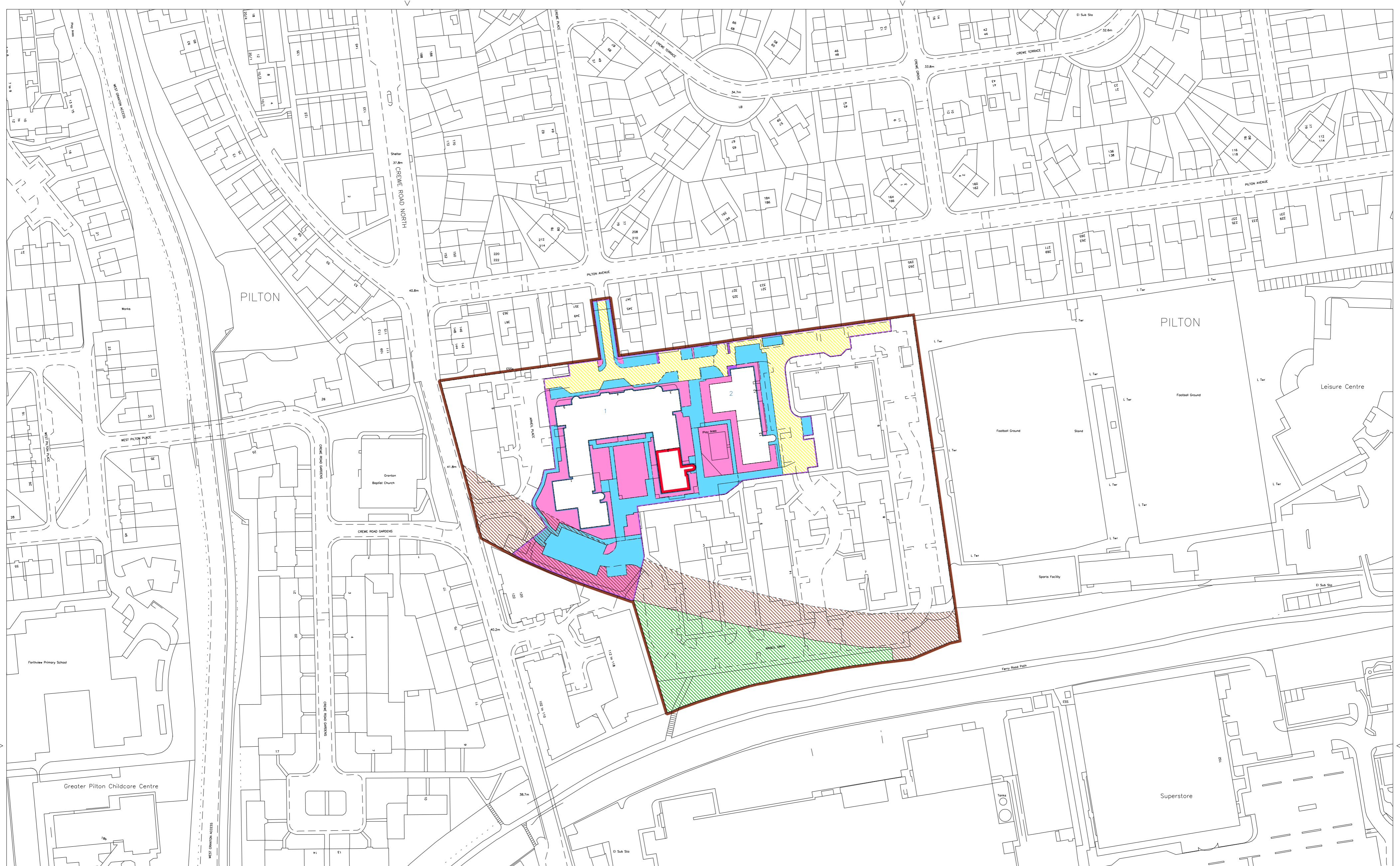

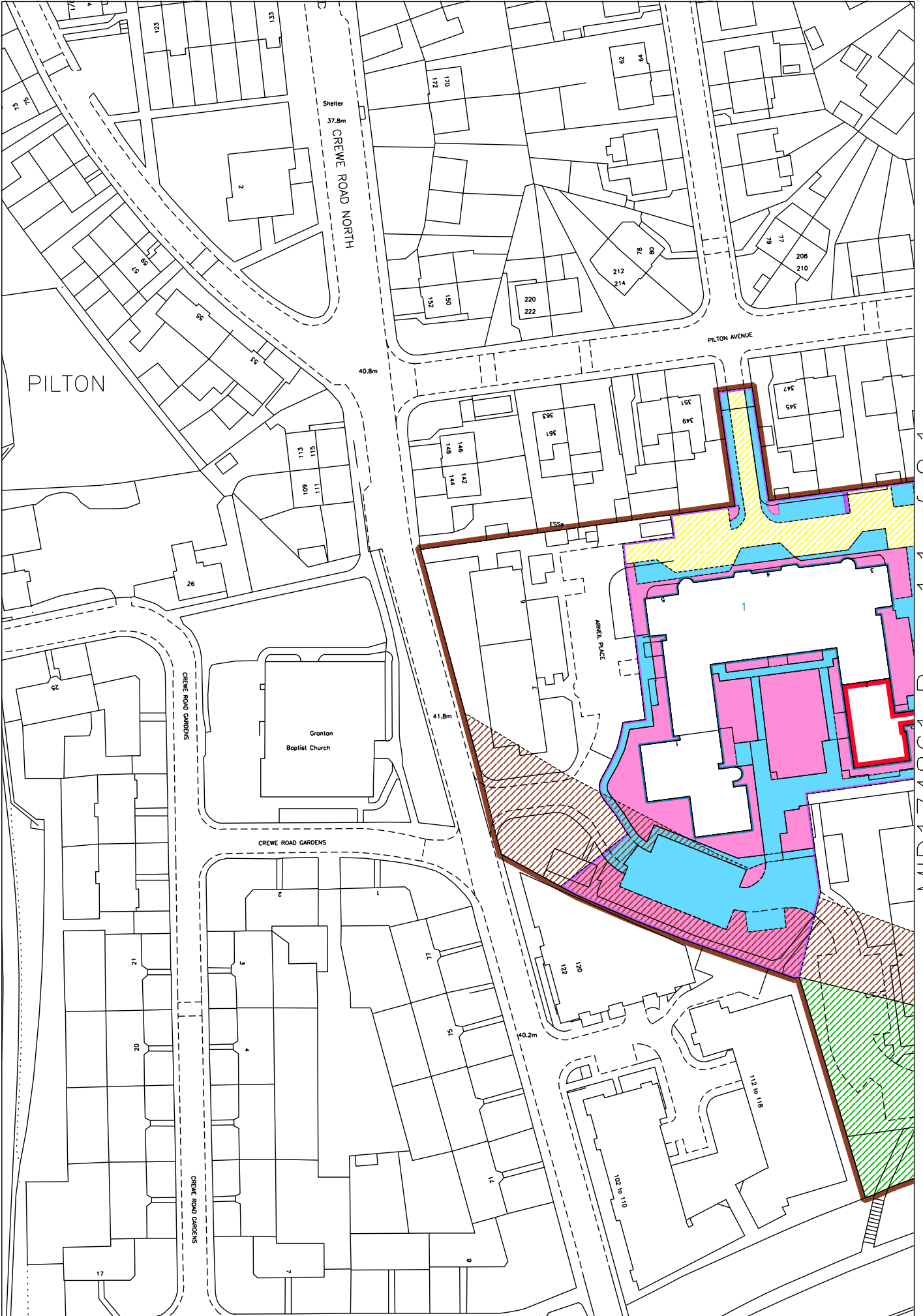



LAND REGISTER
OF SCOTLAND

Officer's ID / Date

3569
20/2/2018

TITLE NUMBER

MID174861



ORDNANCE SURVEY
NATIONAL GRID REFERENCE

70m

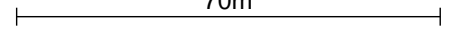

NT2275NE NT2375NW NT2276SE NT2376SW

Survey Scale

1/1250

CROWN COPYRIGHT © - This copy has been produced from the ROS Digital Mapping System on 21/02/2018 with the authority of Ordnance Survey under Section 47 of the Copyright, Designs and Patents Act 1988. Unless there is a relevant exception to copyright, the copy must not be copied without the prior permission of the copyright owner. OS Licence no 100041182.

