 <b>LAND REGISTER OF SCOTLAND</b>	Officer's ID / Date	TITLE NUMBER
	5139 23/5/2019	<b>LAN181970</b>
	<b>ORDNANCE SURVEY NATIONAL GRID REFERENCE</b>	
<b>NS7870 NS7970 NS7871 NS7971</b>		<b>Survey Scale</b> 1/2500

CROWN COPYRIGHT © – This copy has been produced from the ROS Digital Mapping System on 30/06/2019 with the authority of Ordnance Survey under Section 47 of the Copyright, Designs and Patents Act 1988. Unless there is a relevant exception to copyright, the copy must not be copied without the prior permission of the copyright owner. OS Licence no 100041182.

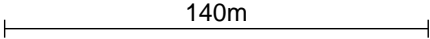

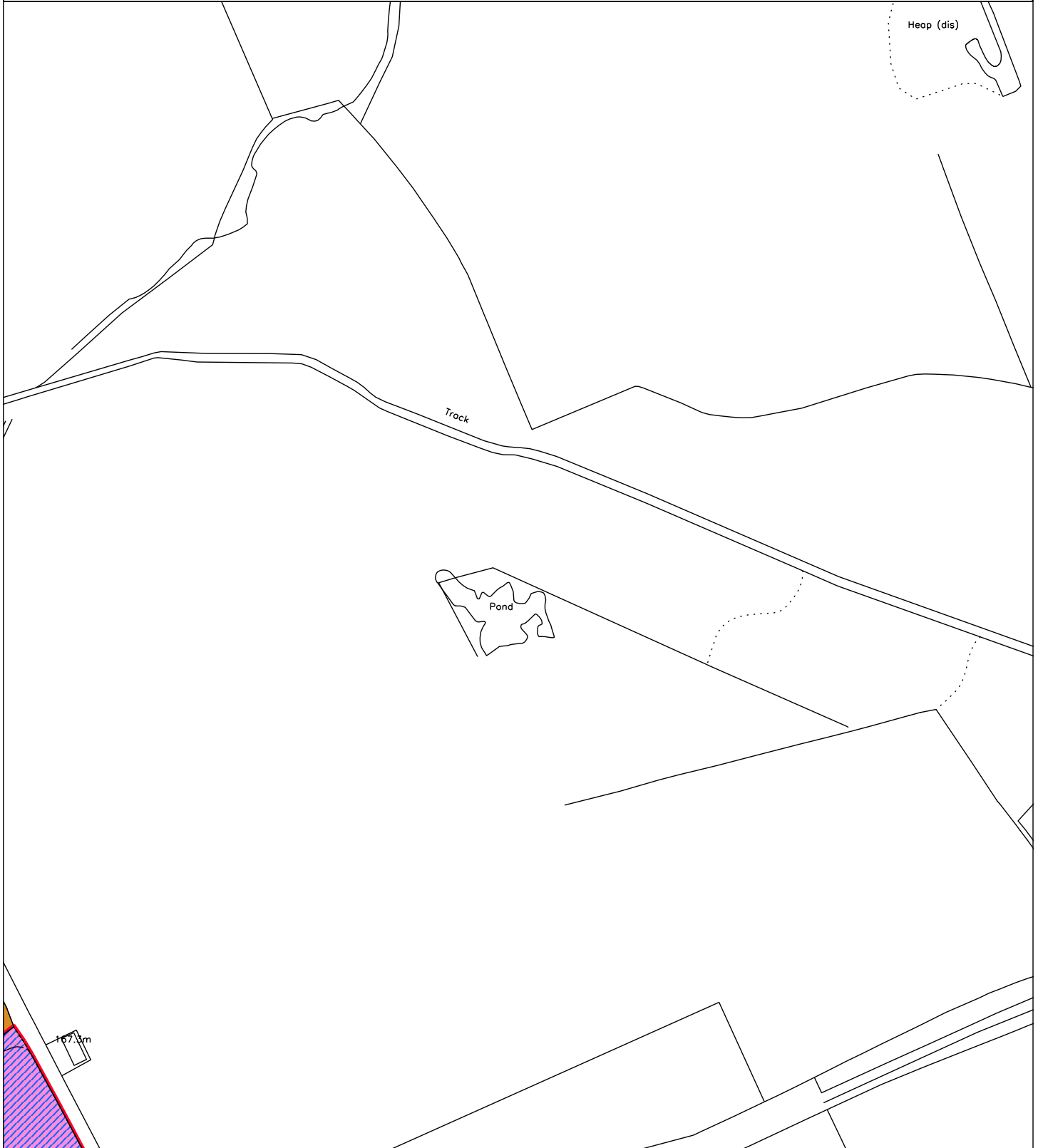

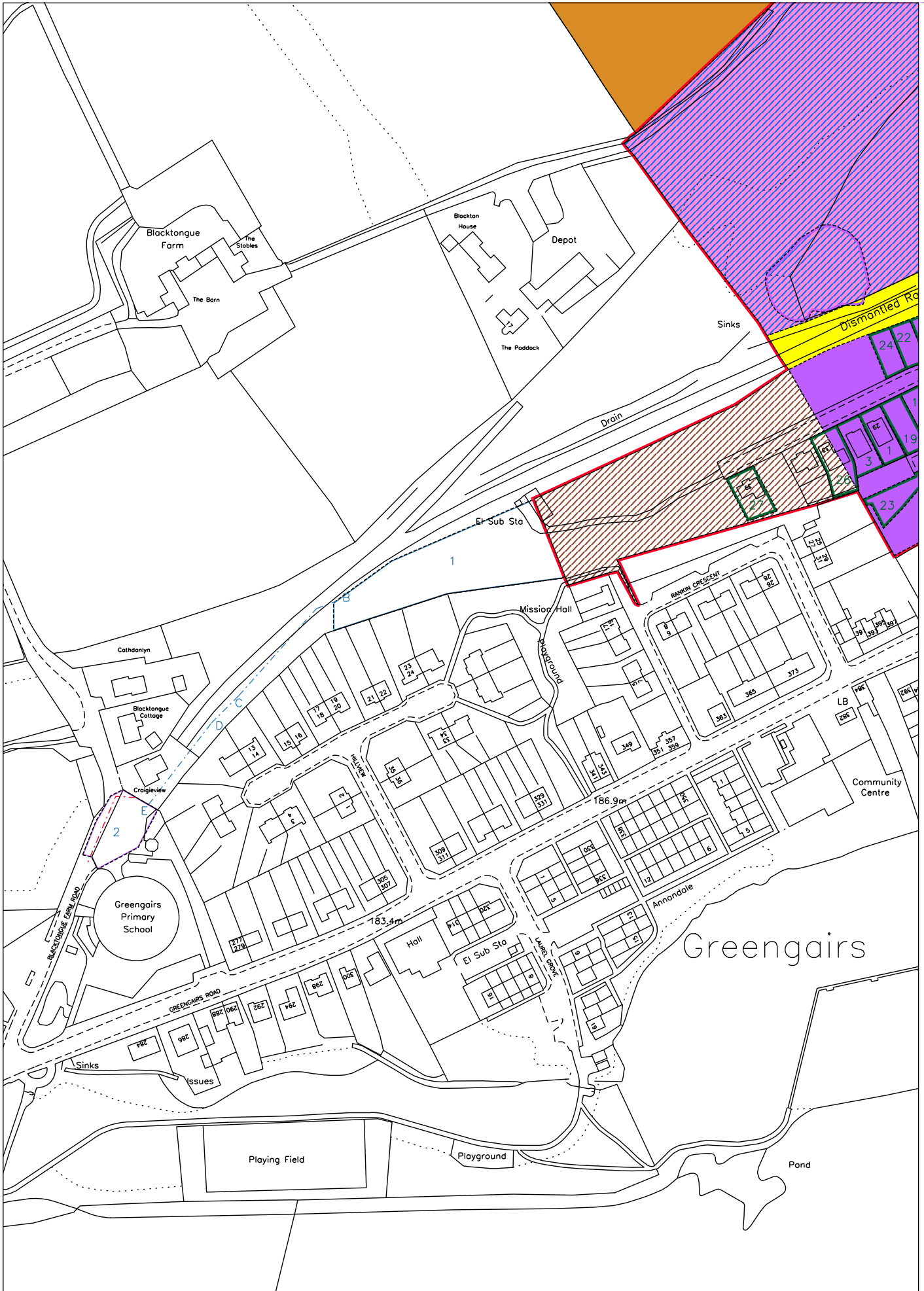

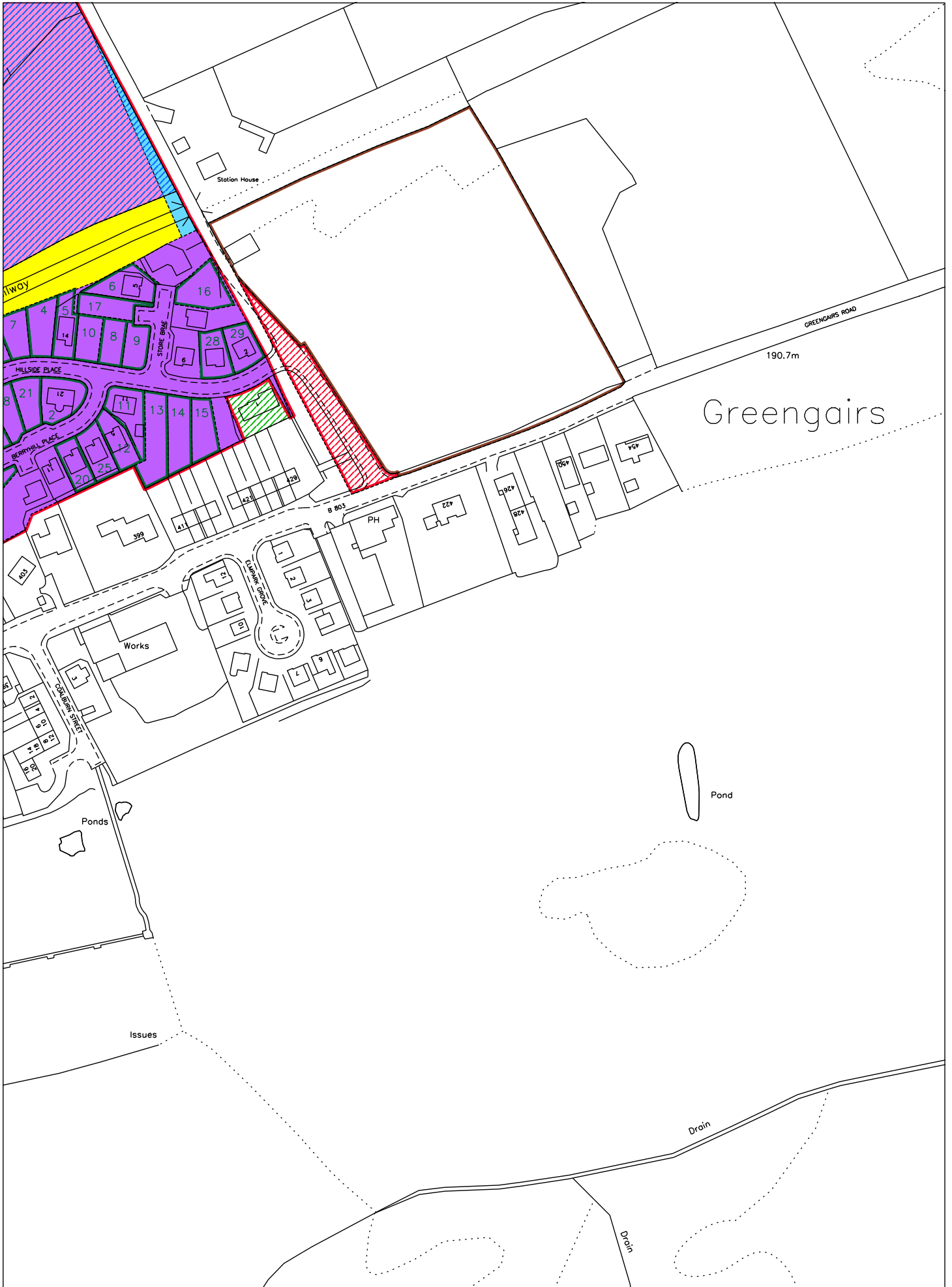

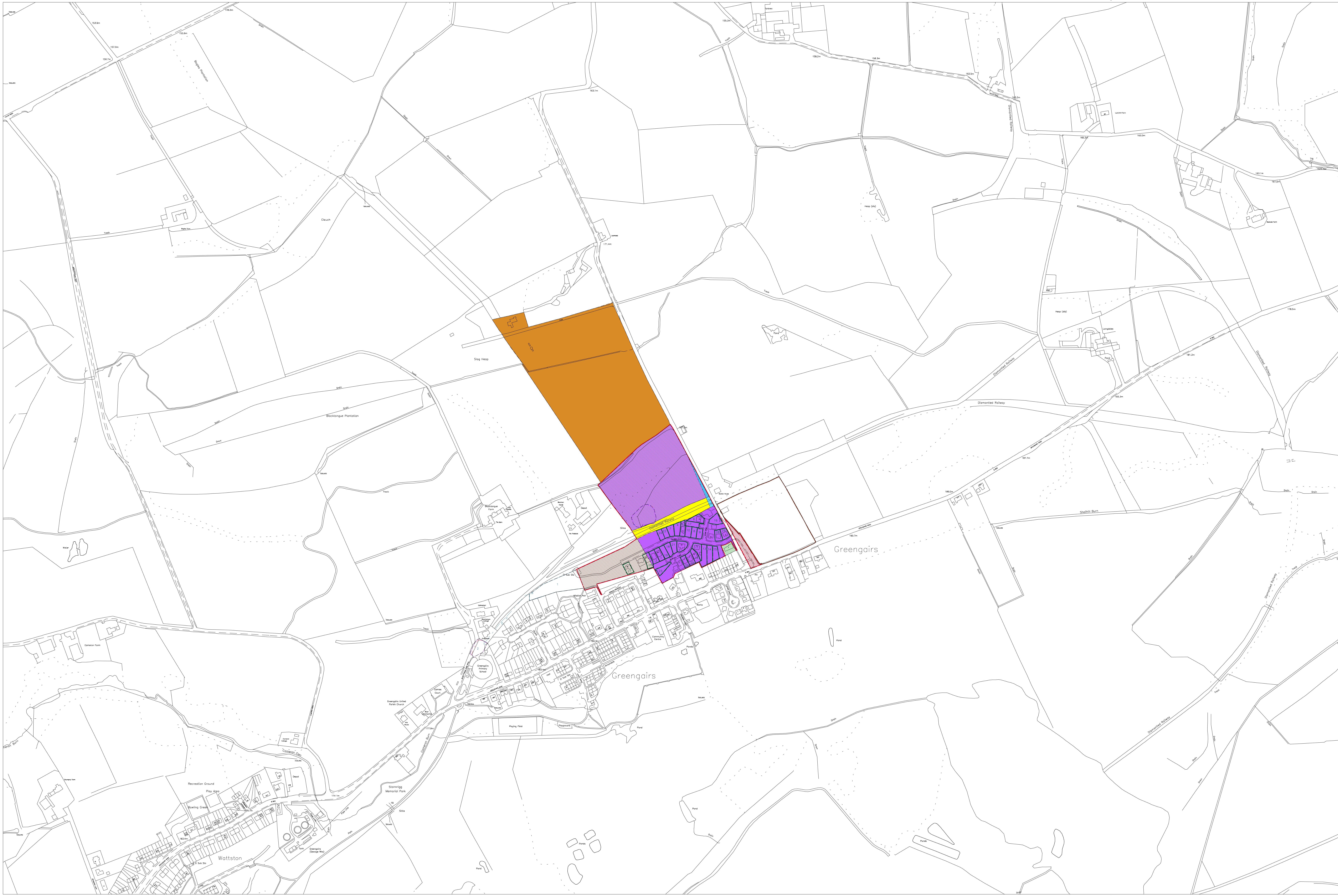



LAND REGISTER  
OF SCOTLAND

Officer's ID/Date

5139  
23/5/2019

Title Number

LAN181970

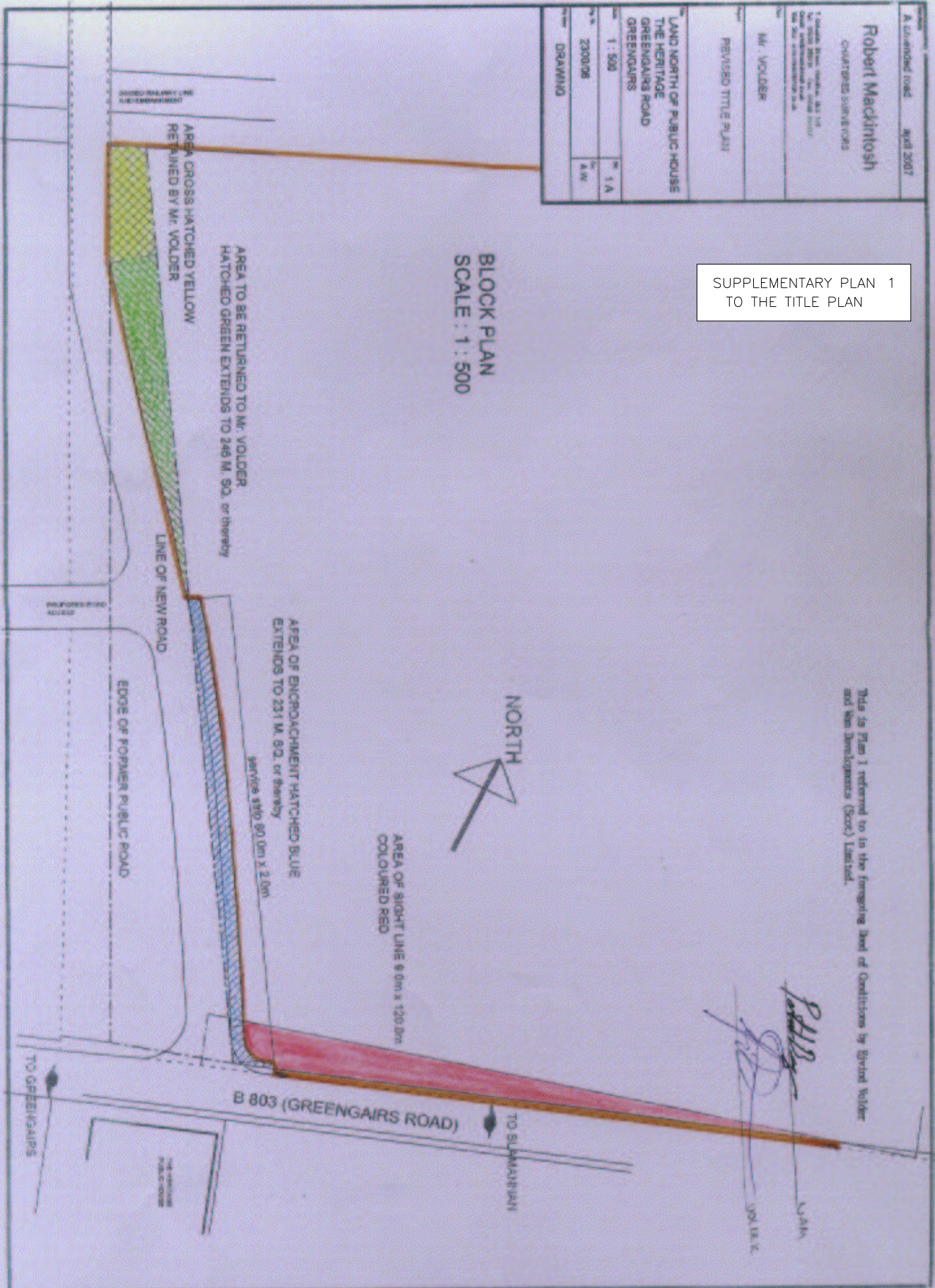

SUPPLEMENTARY PLAN 1  
TO THE TITLE PLAN



LAND REGISTER OF SCOTLAND	Officer's ID/Date	Title Number
	5139 23/5/2019	LAN181970

This is Plan 2 referred to in the foregoing Deed of Conditions by Ejvind Volder and Wan Developments (Scot.) Limited.

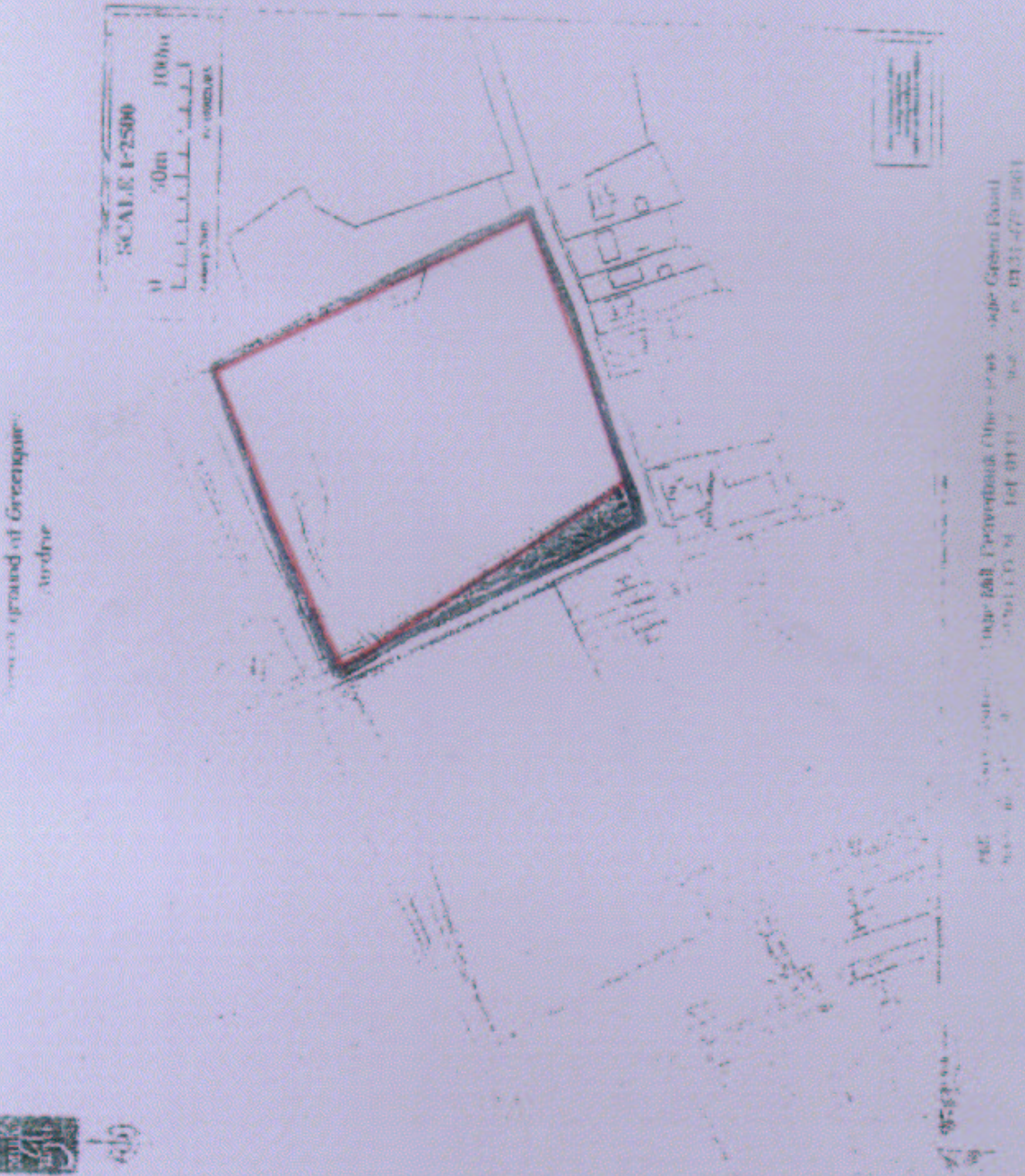

SUPPLEMENTARY PLAN 2  
TO THE TITLE PLAN

NOTE: This copy is a reduction  
of the original plan.

*[Handwritten signature]*