

 LAND REGISTER OF SCOTLAND	Officer's ID / Date	Supplementary Plan to Title
	6608 16/1/2018	<b>MID177152-1</b>
	ORDNANCE SURVEY NATIONAL GRID REFERENCE	70m 
NT2674NE NT2675SE		Survey Scale 1/1250

CROWN COPYRIGHT © – This copy has been produced from the ROS Digital Mapping System on 24/11/2021 with the authority of Ordnance Survey under Section 47 of the Copyright, Designs and Patents Act 1988. Unless there is a relevant exception to copyright, the copy must not be copied without the prior permission of the copyright owner. OS Licence no 100041182.

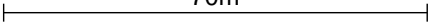

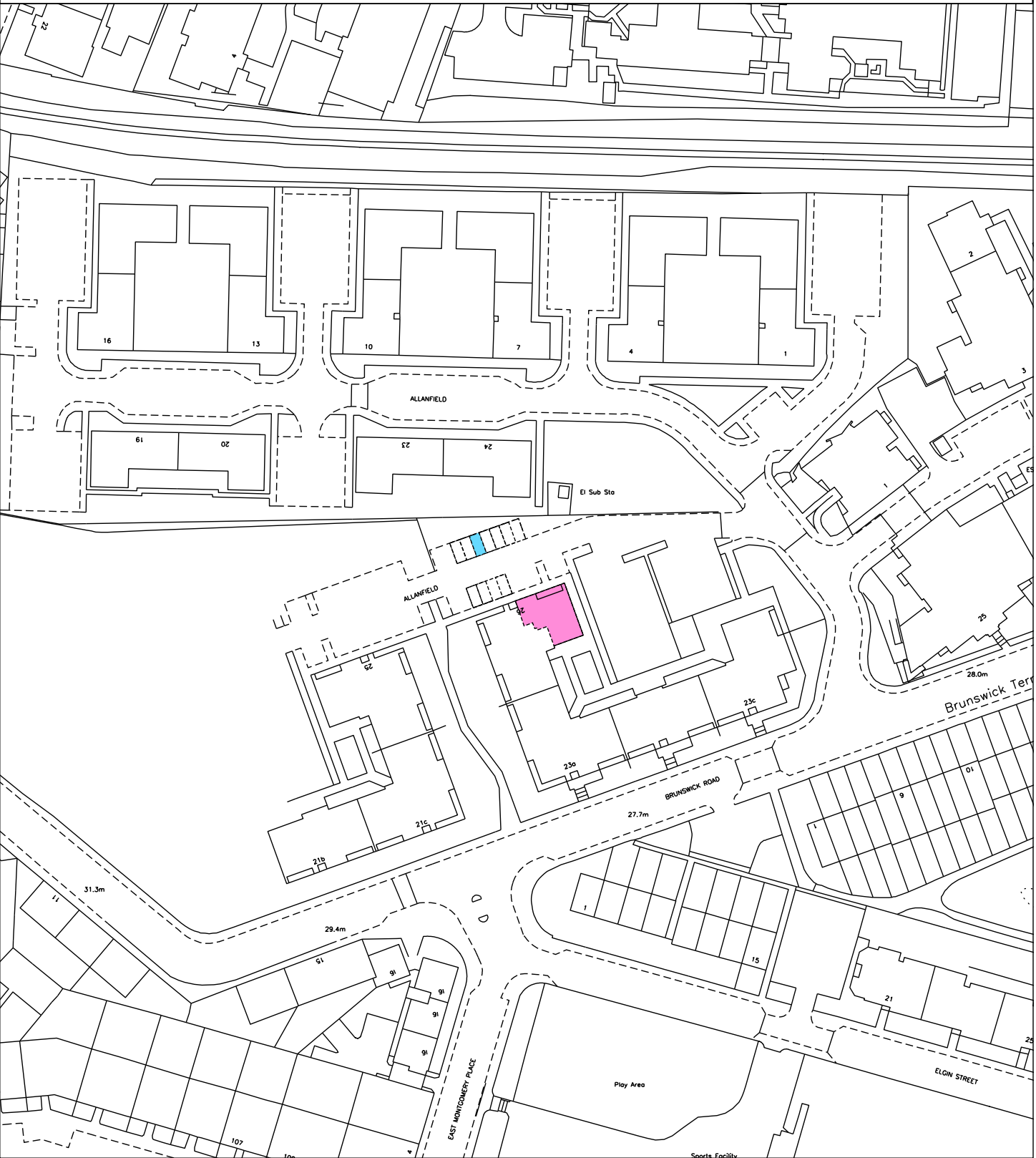
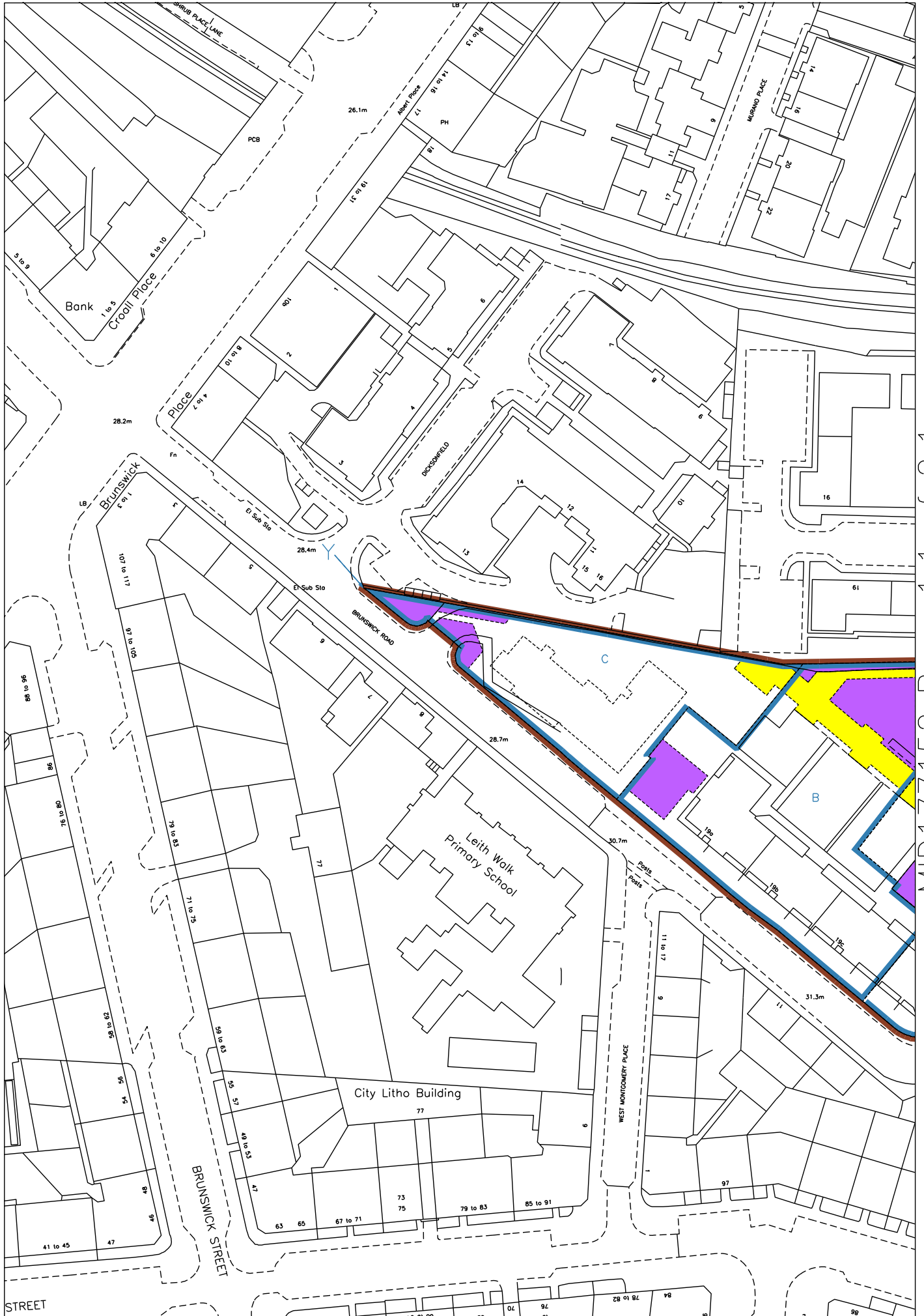

 LAND REGISTER OF SCOTLAND	Officer's ID / Date	TITLE NUMBER
	3569 27/6/2018	<b>MID177152</b>
	ORDNANCE SURVEY NATIONAL GRID REFERENCE	70m 
	NT2674NW NT2674NE	Survey Scale 1/1250

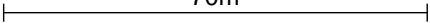
CROWN COPYRIGHT © – This copy has been produced from the ROS Digital Mapping System on 24/11/2021 with the authority of Ordnance Survey under Section 47 of the Copyright, Designs and Patents Act 1988. Unless there is a relevant exception to copyright, the copy must not be copied without the prior permission of the copyright owner. OS Licence no 100041182.

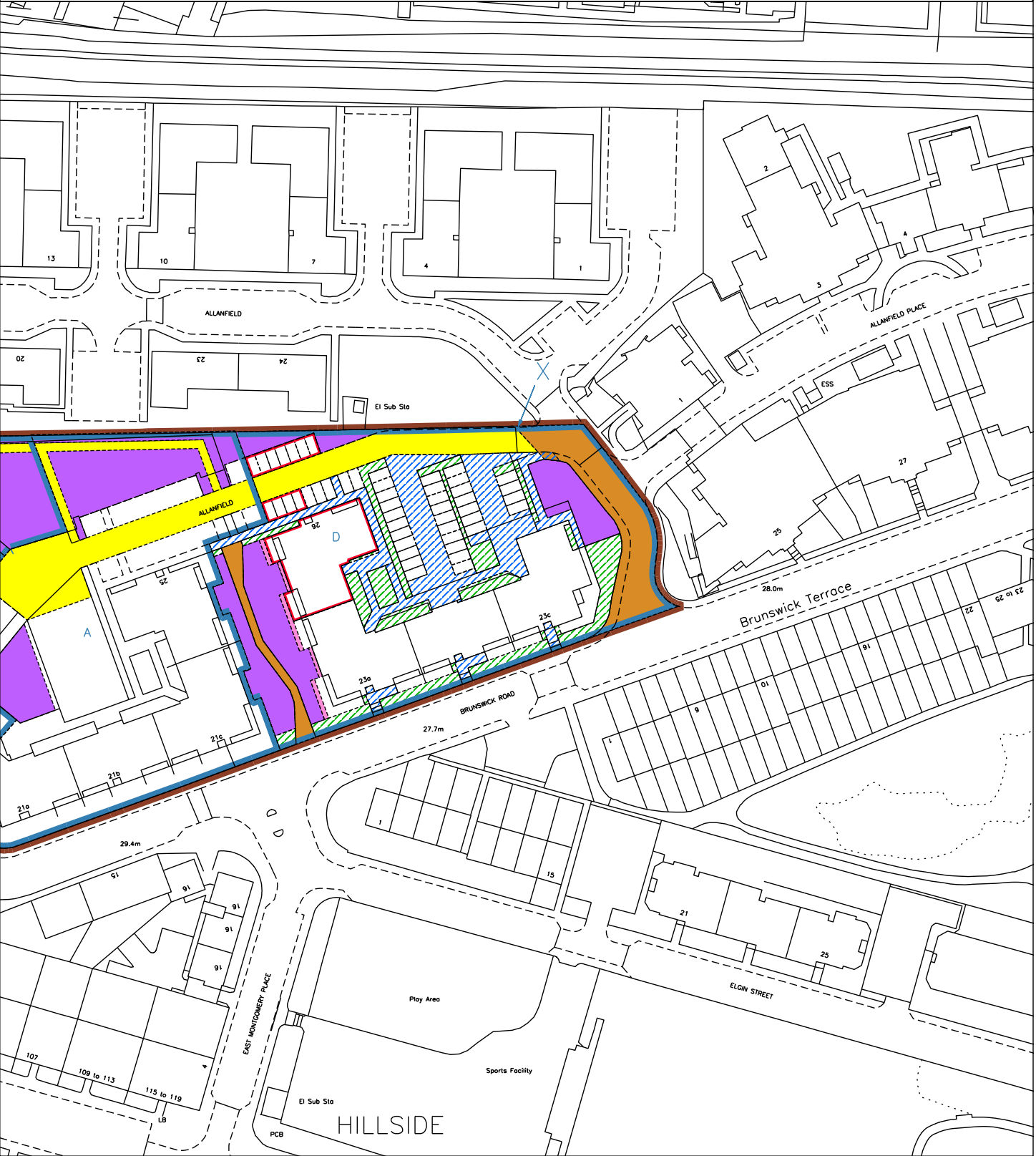



LAND REGISTER  
OF SCOTLAND

ORDNANCE SURVEY  
NATIONAL GRID REFERENCE

NT2674NW NT2674NE NT2675SW NT2675SE

Officer's ID / Date  
3569  
27/6/2018

TITLE NUMBER  
MID177152

70m

Survey Scale  
1/1250

CROWN COPYRIGHT © — This copy has been produced from the RGS Digital Mapping System on 24/11/2021 with the authority of Ordnance Survey under Section 47 of the Copyright, Designs and Patents Act 1988. Unless there is a relevant exception to copyright, the copy must not be copied without the prior permission of the copyright owner. OS Licence no 100041182.