



LAND REGISTER  
OF SCOTLAND

Officer's ID / Date

2908  
16/6/2017

TITLE NUMBER

**MID156179**



ORDNANCE SURVEY  
NATIONAL GRID REFERENCE

70m

NT2577NE NT2677NW

Survey Scale

1/1250

CROWN COPYRIGHT © - This copy has been produced from the ROS Digital Mapping System on 20/06/2017 with the authority of Ordnance Survey under Section 47 of the Copyright, Designs and Patents Act 1988. Unless there is a relevant exception to copyright, the copy must not be copied without the prior permission of the copyright owner. OS Licence no 100041182.

SEE SUPPLEMENTARY PLAN(S)

PARKING LEVEL PLAN

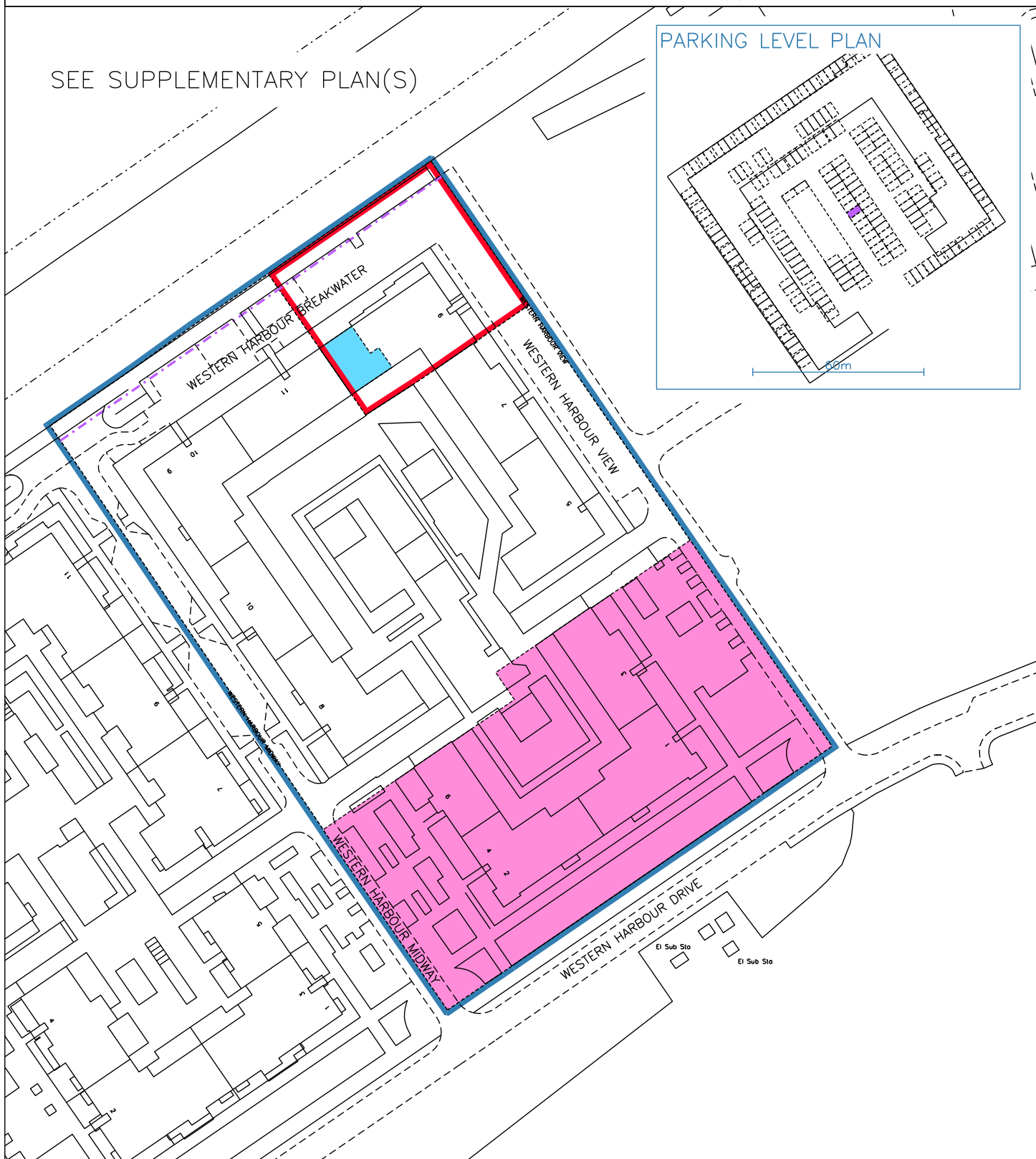
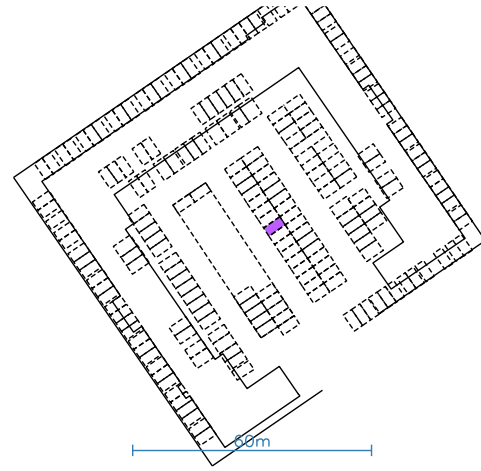



LAND REGISTER  
OF SCOTLAND

Officer's ID/Date

2908  
16/6/2017

Title Number

MID156179

SUPPLEMENTARY PLAN 1  
TO THE TITLE PLAN

Cooper Cromar



- LINE OF RESIDENTIAL LAND
- LINE OF COMMERCIAL LAND
- AREA OF MAIN ROADS
- A - B LOCATION OF NEW QUAY WALLS

*hms* Dir } F PORTS PLC  
*Charles Hemmed* Dir } (or one Director Only)

*hms* Dir } F PROPERTY  
*Alasdair* Dir } DEVS LTD  
(or one Director Only)



FORTH PORTS PLC



# Forth Ports Boundary Western Harbour



16th December 2002



LAND REGISTER  
OF SCOTLAND

Officer's ID/Date

2908  
16/6/2017

Title Number

MID156179

SUPPLEMENTARY PLAN 2  
TO THE TITLE PLAN

Cooper Cromar

3B

5G

5E

*Charles Hammond*

FORTH PORTS  
PLC

*Sam Edge*

FORTH PROPR  
DEVS LTD



FORTH PORTS PLC



# Forth Ports Residential Plot Boundaries Western

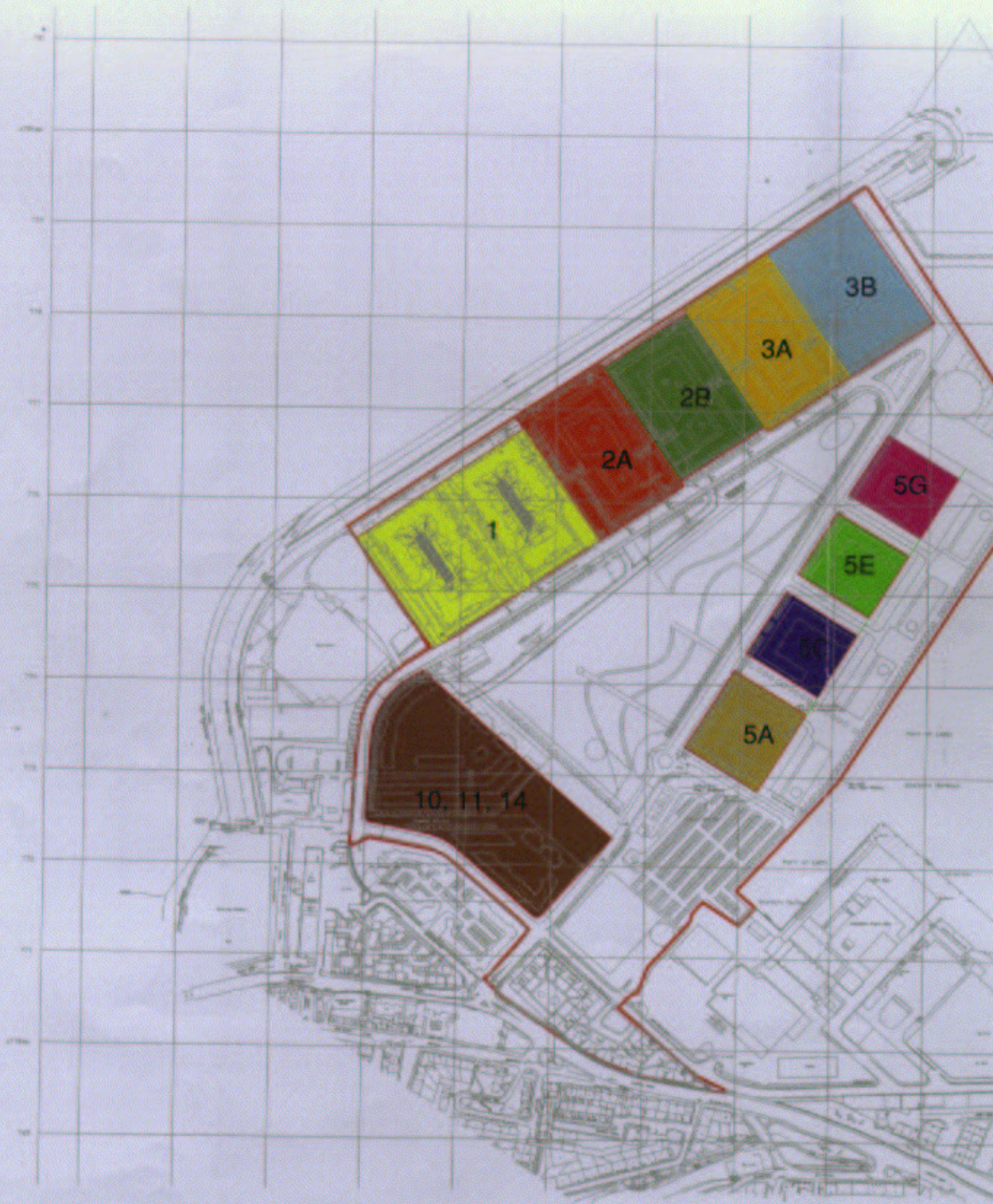

16th December 2002