



<div> LAND REGISTER OF SCOTLAND</div>	Officer's ID / Date	TITLE NUMBER
	6925 24/11/2021	MID216119
<div></div>	ORDNANCE SURVEY NATIONAL GRID REFERENCE	140m
NT3068 NT3168 NT3069 NT3169		Survey Scale
		1/2500

CROWN COPYRIGHT © – This copy has been produced from the ROS Digital Mapping System on 11/01/2022 with the authority of Ordnance Survey under Section 47 of the Copyright, Designs and Patents Act 1988. Unless there is a relevant exception to copyright, the copy must not be copied without the prior permission of the copyright owner. OS Licence no 100041182.





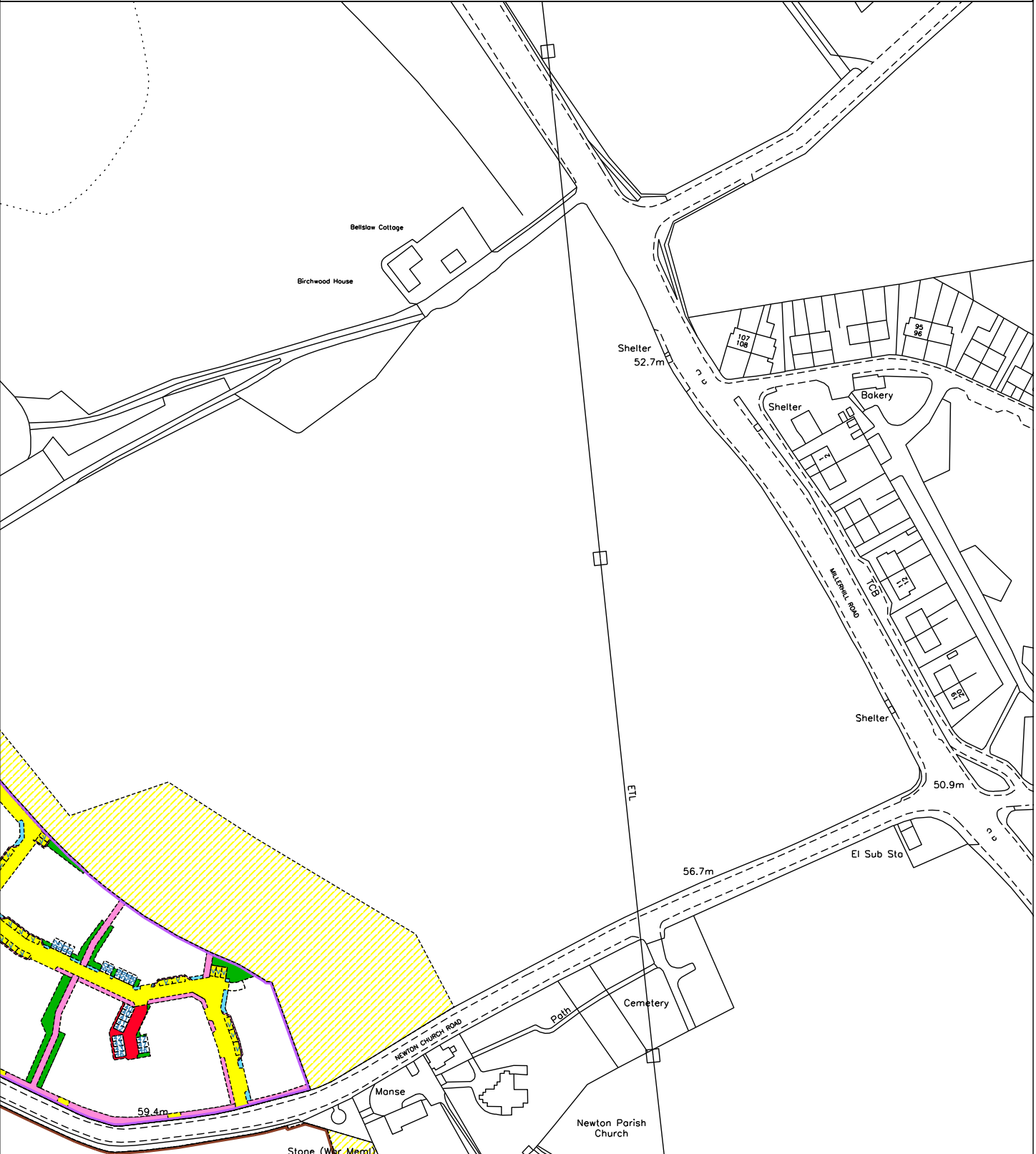
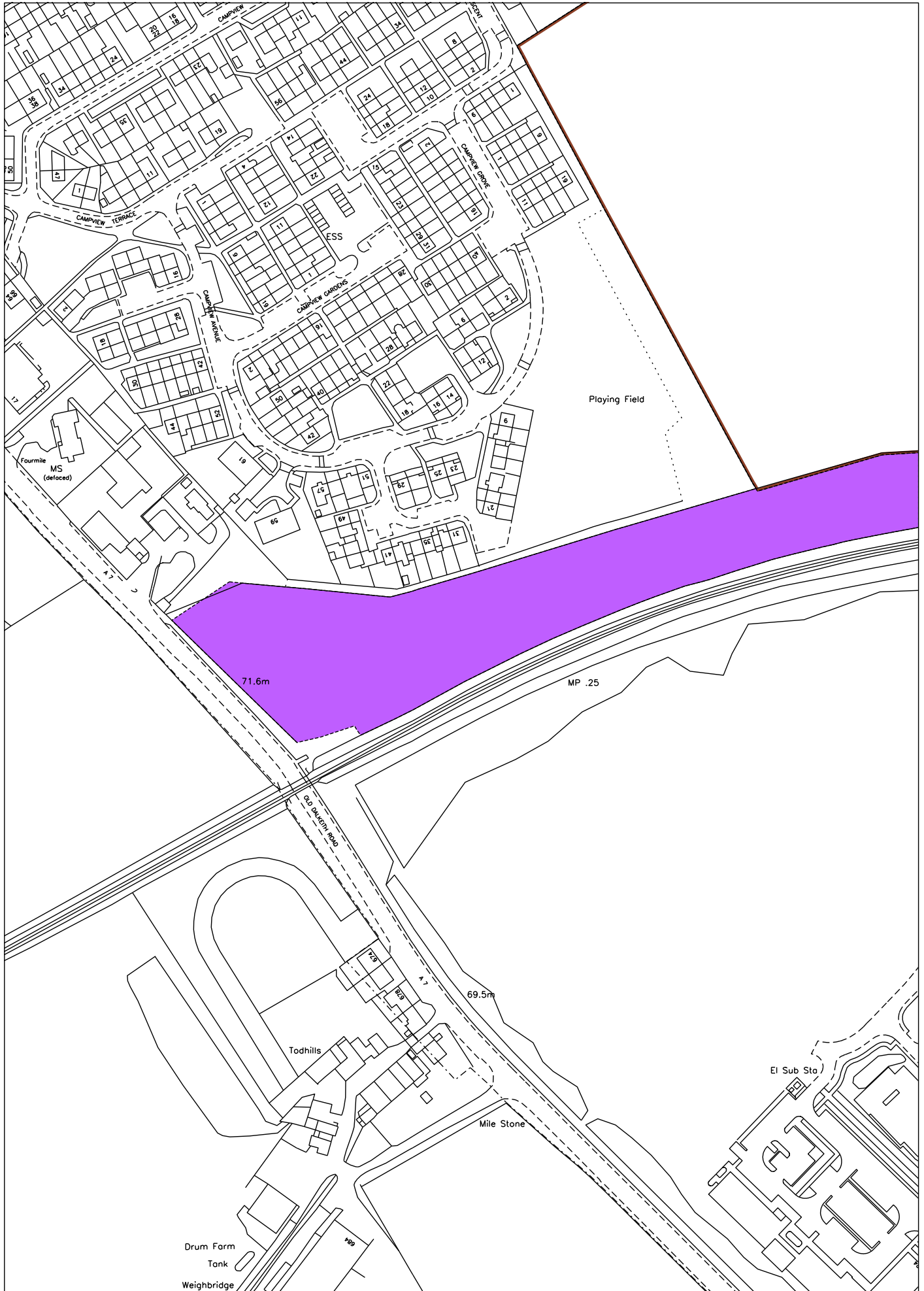
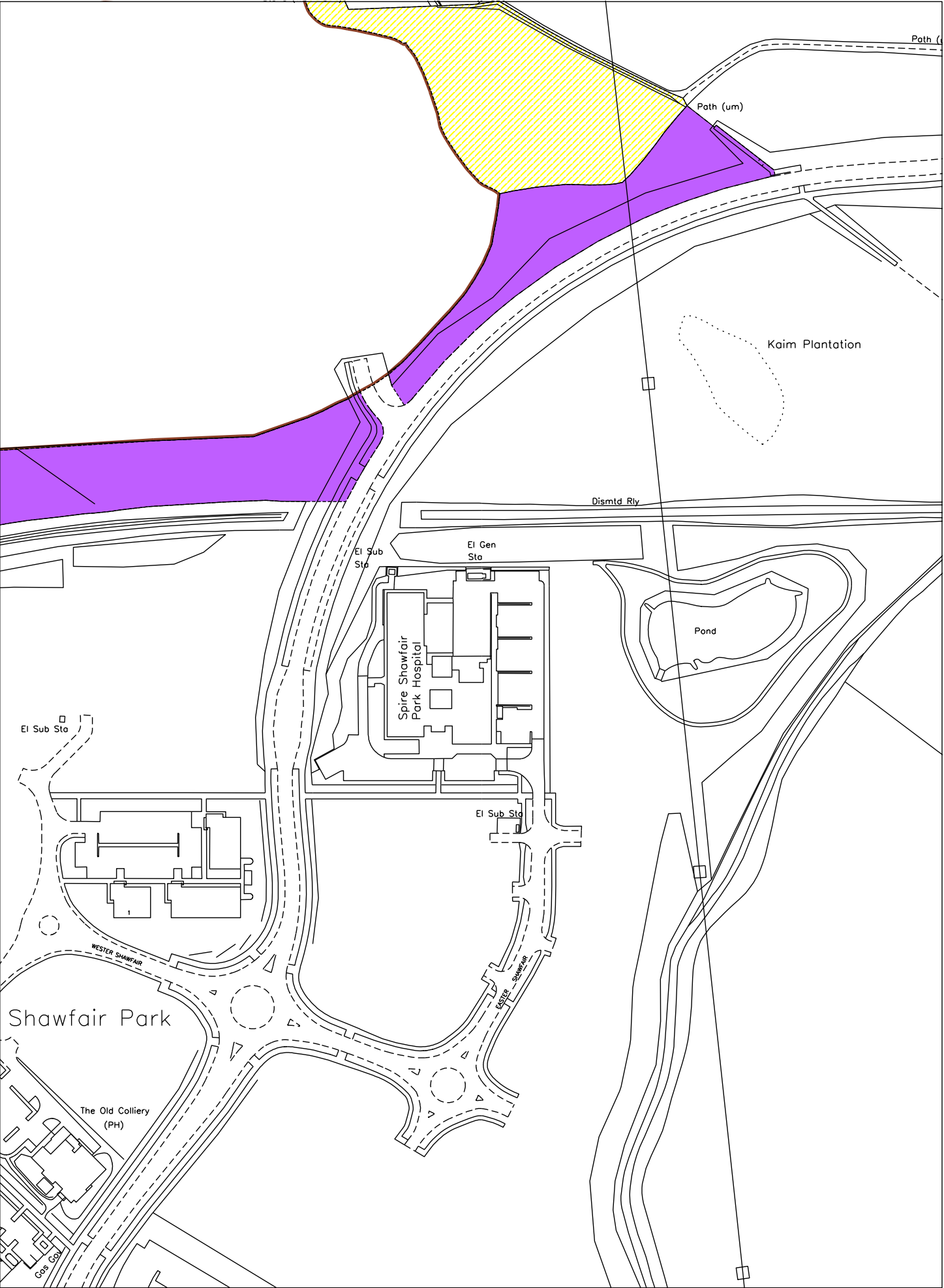

LAND REGISTER OF SCOTLAND	Officer's ID/Date	Title	Number
	6925 24/11/2021		MID216119

This is the plan referred to in the foregoing Deed of Declaration of Conditions by Shawfair LLP and Buccleuch Property (Shawfair) Limited, in respect of subjects South East Wedge, Edinburgh

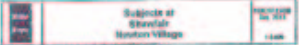

NOTE: This copy is a reduction of the original plan.

SUPPLEMENTARY PLAN 1
TO THE TITLE PLAN

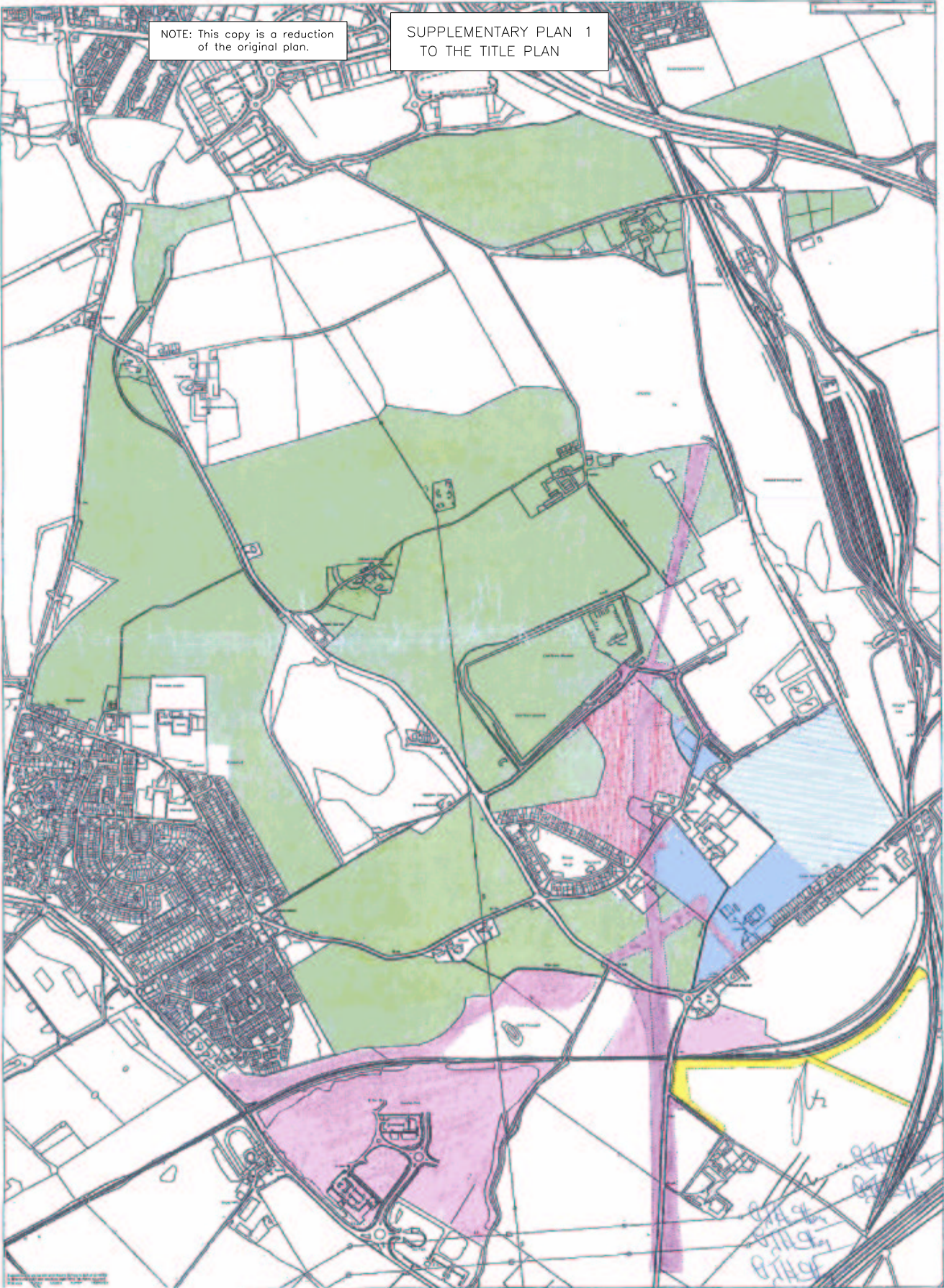

Officer's ID/Date	Title Number
6925 24/11/2021	MID216119

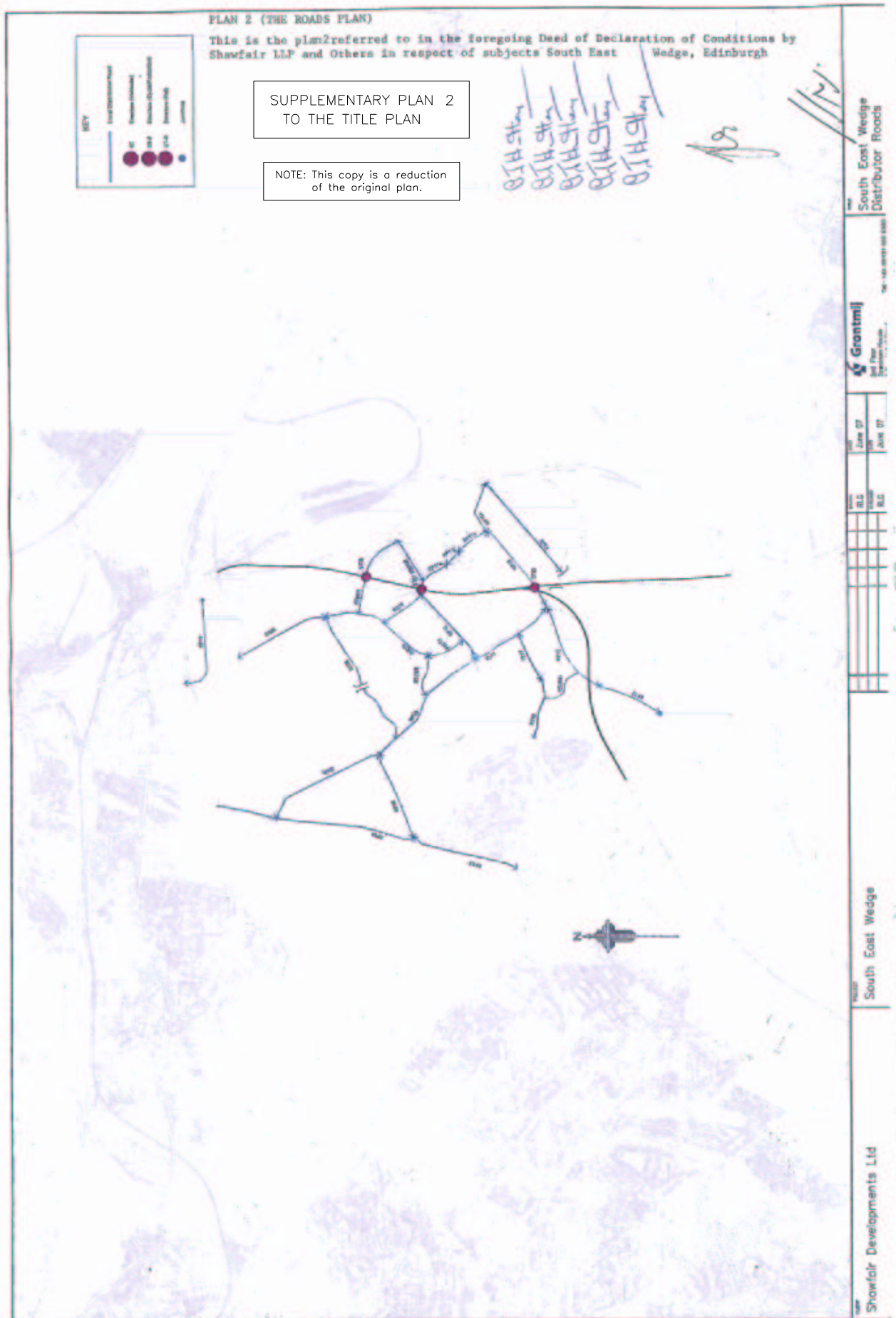

LAND REGISTER OF SCOTLAND	Officer's ID/Date	Title	Number
	6925 24/11/2021		MID216119

PLAN B This is the plan referred to in the foregoing Deed of Declaration of Conditions by Shawfair LLP and Others in respect of subjects South East Wedge, Edinburgh

NOTE: This copy is a reduction of the original plan.

SUPPLEMENTARY PLAN 4
TO THE TITLE PLAN

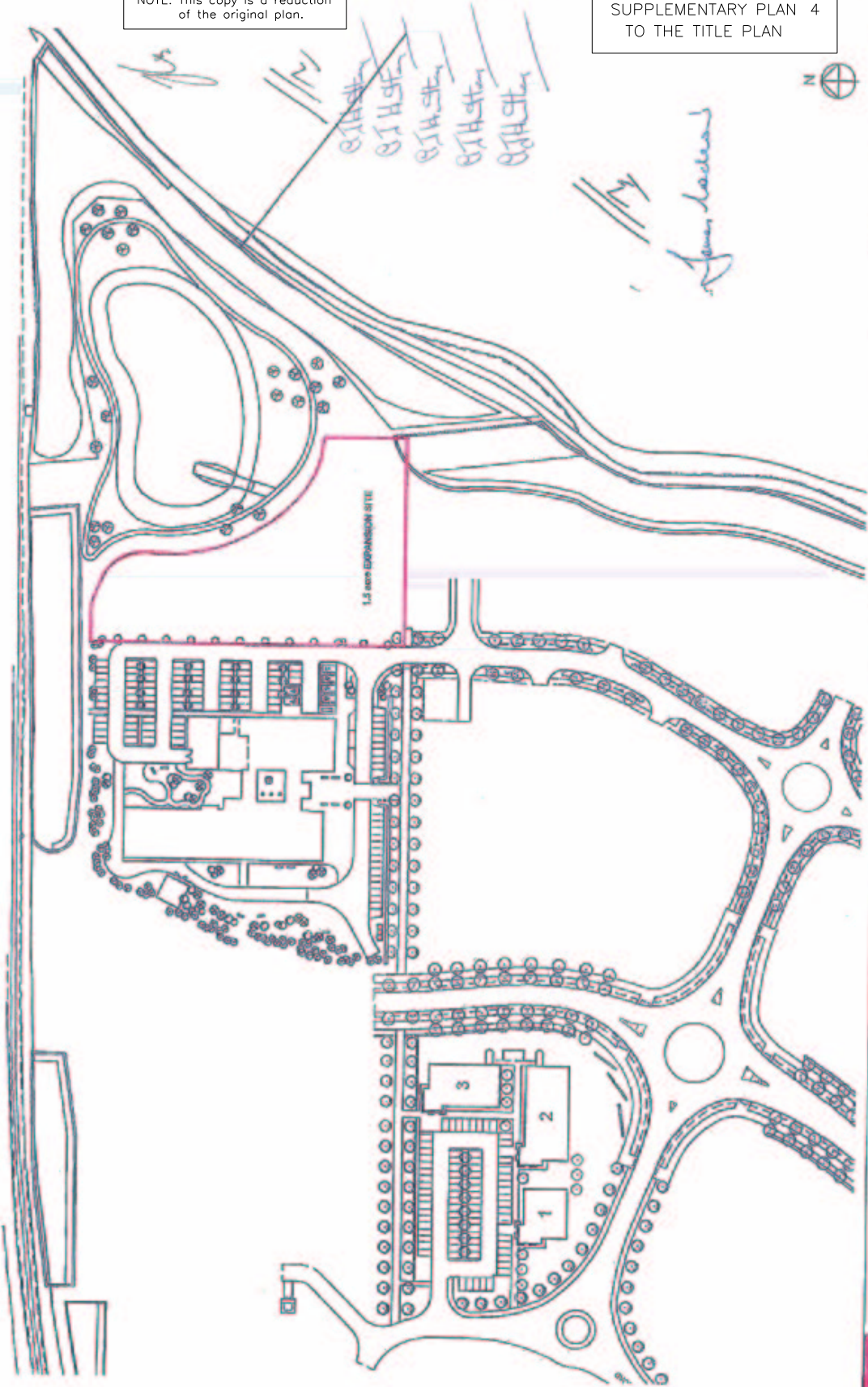

Spire Hospital, Shawfair Park, Edinburgh		BT 164	11/10/22	JS
Buckloch Property		11/256@A3	11/10/22	JS
INFORMATION				

SPIRE HOSPITAL, expansion site

Officer's ID/Date
6925 24/11/2021

Title	Number
-------	--------

MID216119

NOTE: This copy is a reduction of the original plan.

COORDINATES BASED ON
CLUGSTON SURVEY
3146/001 WITH TRUE OS
NATIONAL GRID

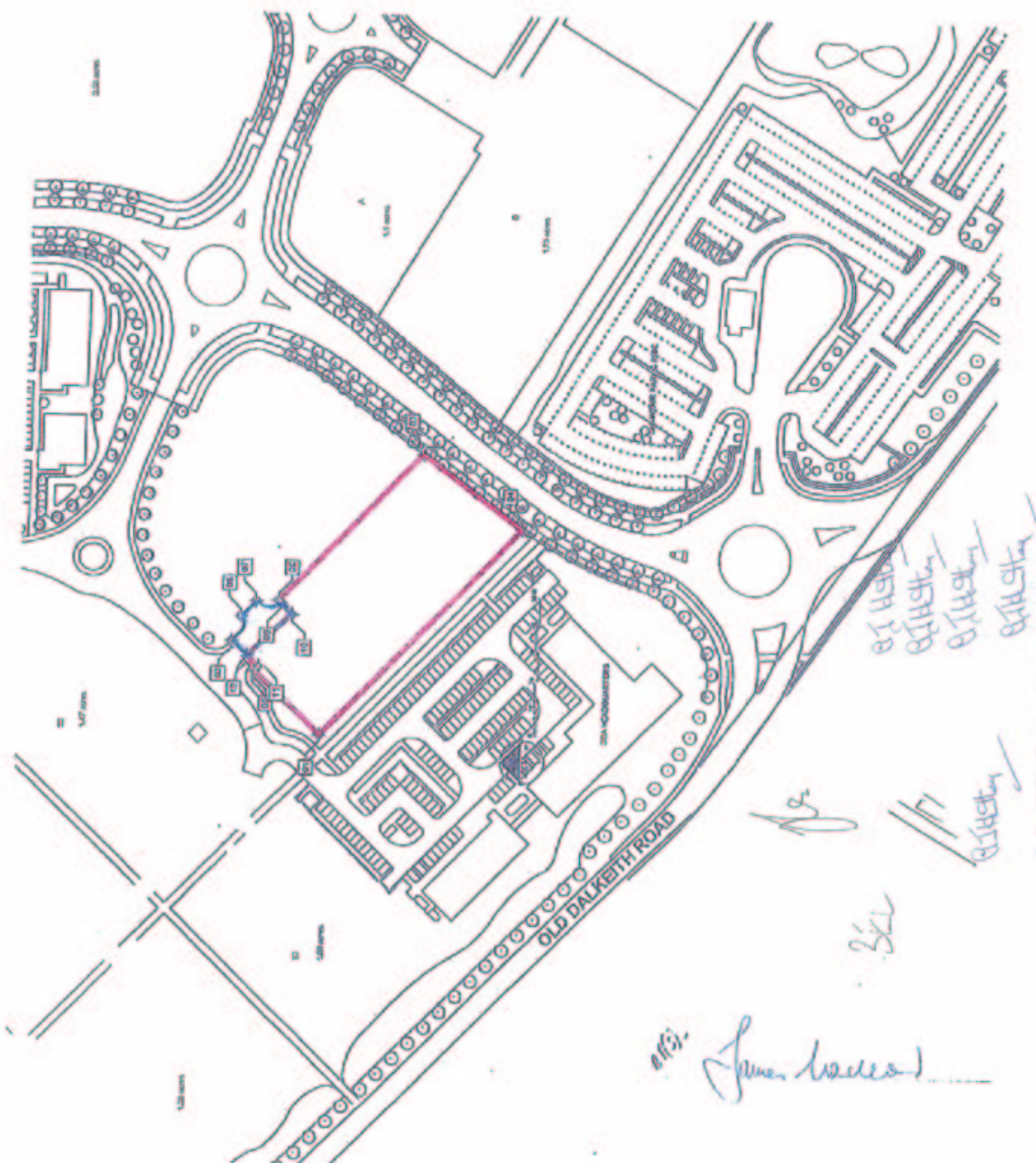
[illegible][illegible]

LAND REGISTER OF SCOTLAND	Officer's ID/Date	Title	Number
	6925 24/11/2021		MID216119

PLAN E This is the plan referred to in the foregoing Deed of Declaration of Conditions by Shawfair LLP and Others in respect of subjects South East Wedge, Edinburgh

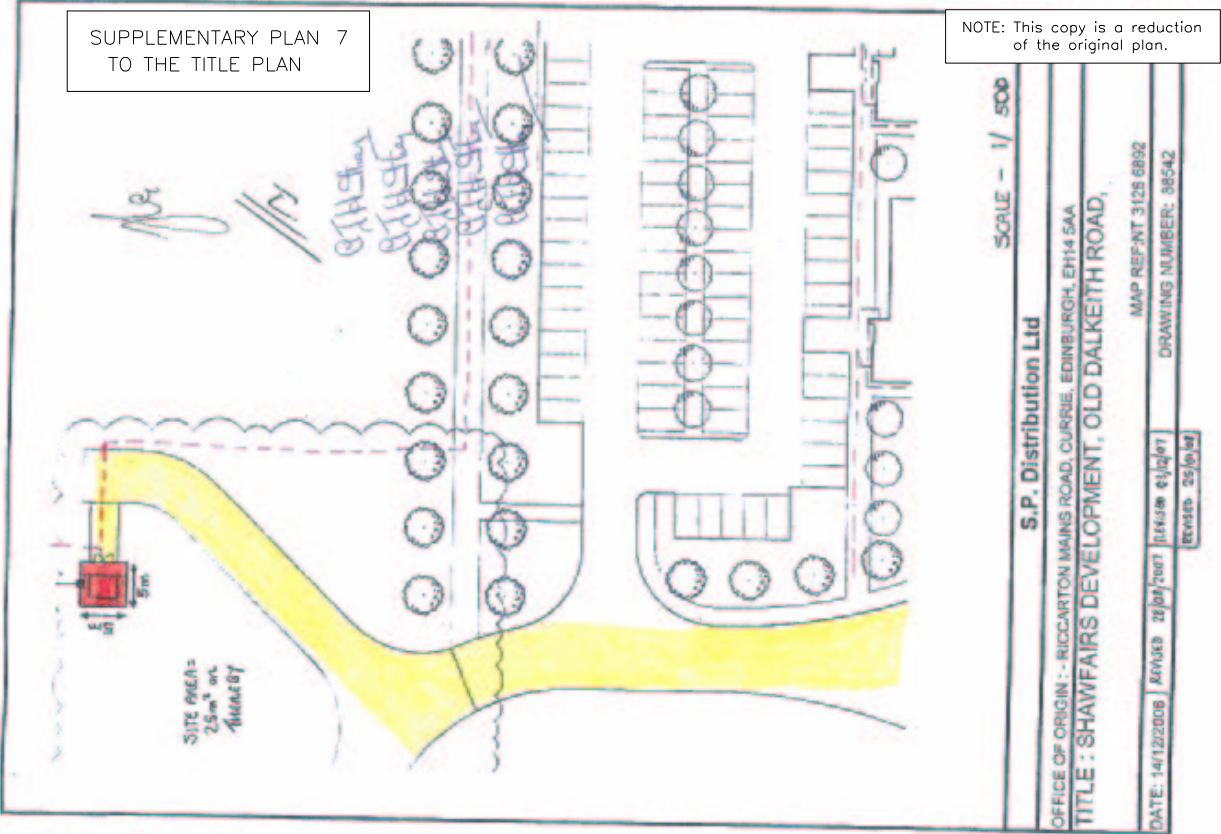

LAND REGISTER OF SCOTLAND	Officer's ID/Date	Title	Number
	6925 24/11/2021	MID216119	

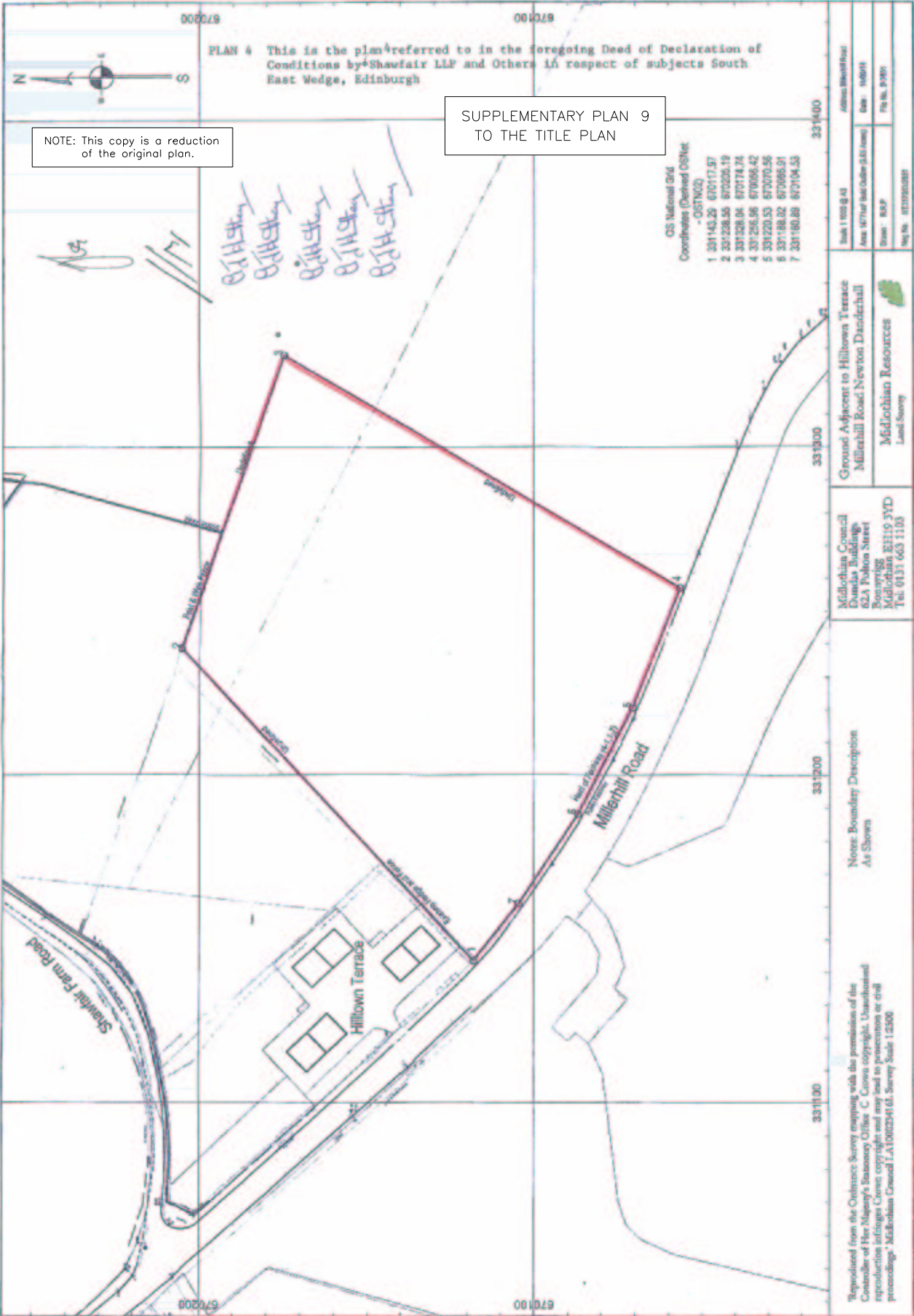

LAND REGISTER OF SCOTLAND	Officer's ID/Date	Title	Number
	6925 24/11/2021		MID216119

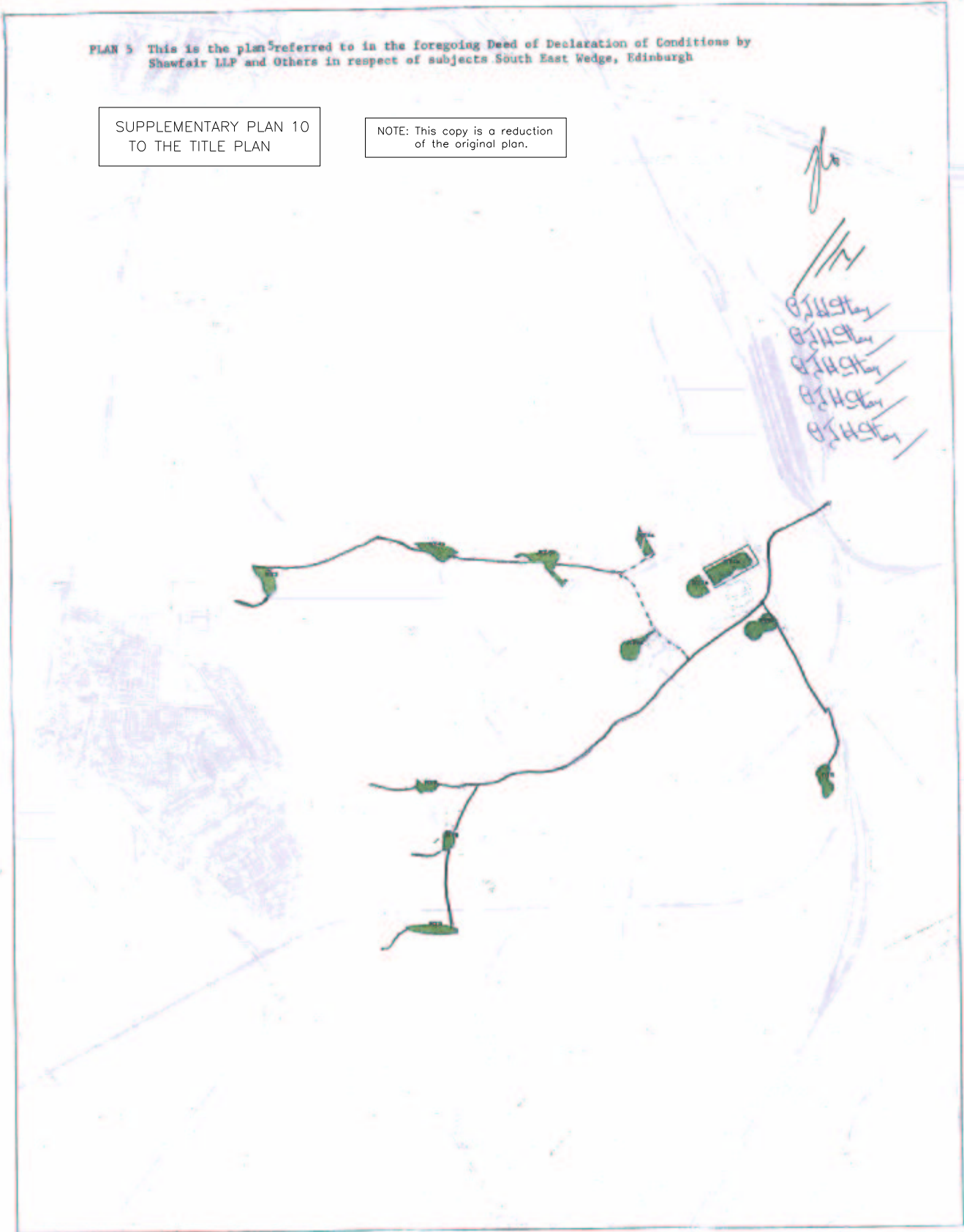

LAND REGISTER OF SCOTLAND

Officer's ID/Date

6925
24/11/2021

Title Number

MID216119

PLAN 6 This is the plan⁶ referred to in the foregoing Deed of Declaration of Conditions by Shawfair LLP and Others in respect of subjects South East Wedge, Edinburgh

SUPPLEMENTARY PLAN 11
TO THE TITLE PLAN

NOTE: This copy is a reduction
of the original plan.

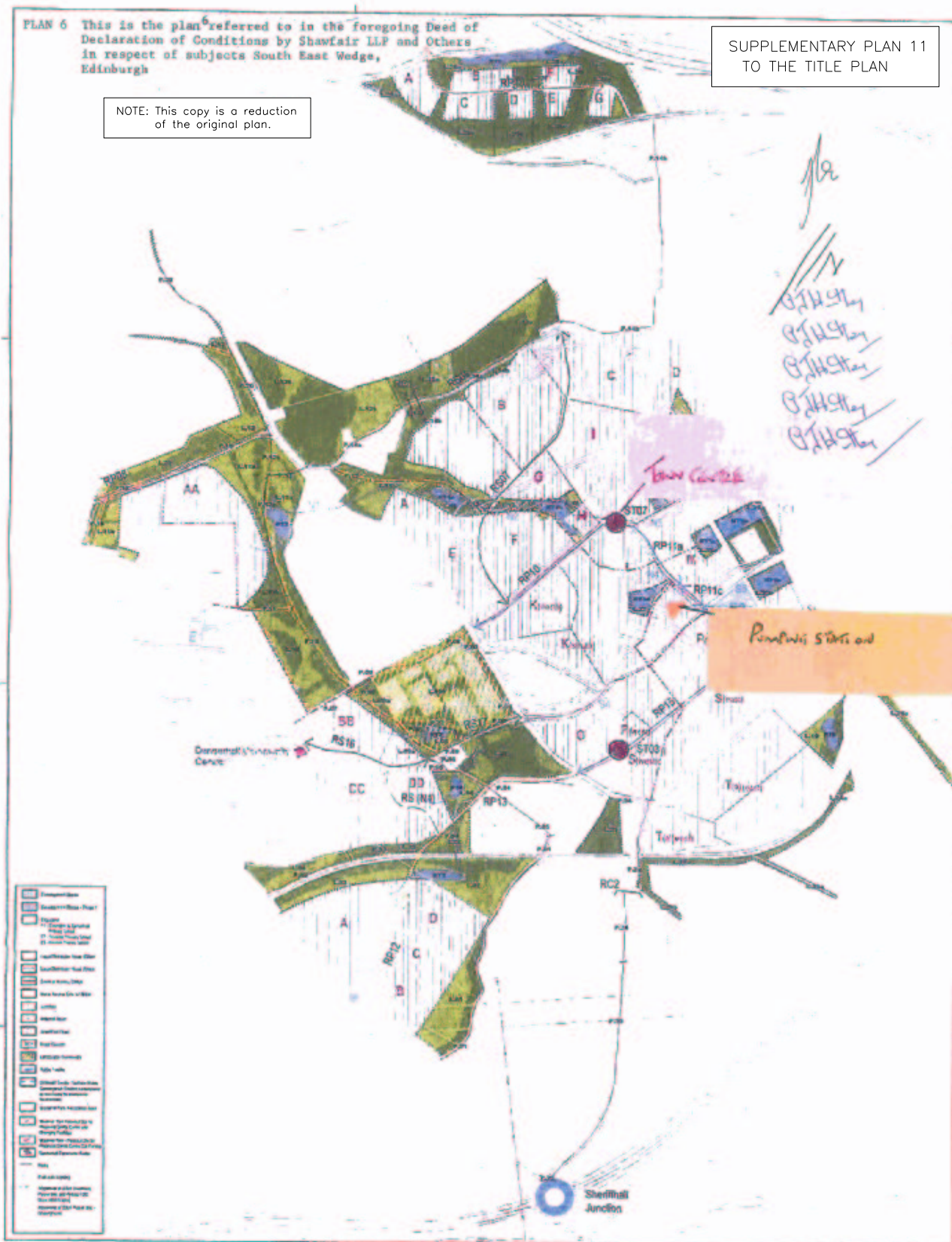

Figure 1: South East Wedge (S.E.W.)

1. This drawing is for the purpose of showing the location of the subjects of the plan in relation to the surrounding area. It is not a plan of the subjects of the plan. 2. The drawing is for the purpose of showing the location of the subjects of the plan in relation to the surrounding area. It is not a plan of the subjects of the plan. 3. The drawing is for the purpose of showing the location of the subjects of the plan in relation to the surrounding area. It is not a plan of the subjects of the plan.

Area	Area	Area	Area	Area	Area
Area	Area	Area	Area	Area	Area
Area	Area	Area	Area	Area	Area
Area	Area	Area	Area	Area	Area
Area	Area	Area	Area	Area	Area
Area	Area	Area	Area	Area	Area

EDINBURGH



SE WEDGE

Master Plan Reference Drawing
Phase 1

Drawn By	Drawn Date	Drawn Date	Drawn Date
Drawn By	Drawn Date	Drawn Date	Drawn Date
Drawn By	Drawn Date	Drawn Date	Drawn Date
Drawn By	Drawn Date	Drawn Date	Drawn Date